

TECHNICAL BULLETIN

N 88 - 2020. 04

E50 FLAT

Solution for flat rail, 25mm height

content:

- PROFILES
- PROFILES 1:1
- DETAILS
- ACCESSORIES

ETEM

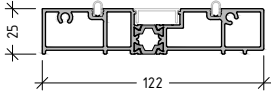
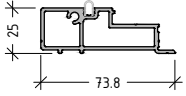
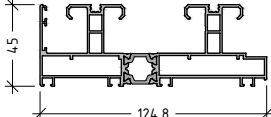
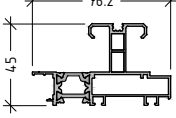
code	Profile	Weight Length Moment of inertia	code	Profile	Weight Length Moment of inertia
E50170 Flat rail		2103 g/m L=6.01 m			
E50171 Additional flat rail		1083 g/m L=6.01 m			
E50130 Double rail		2177 g/m L=6.01 m			
E50111 Additional single glazing rail		1216 g/m L=6.01 m			

E50170

Flat double rail

2103 gr/m

NOTE:

Flat rail E50170
works with both rails,
E50100 (E50 Classic)
or E50130 (E50 Evo)

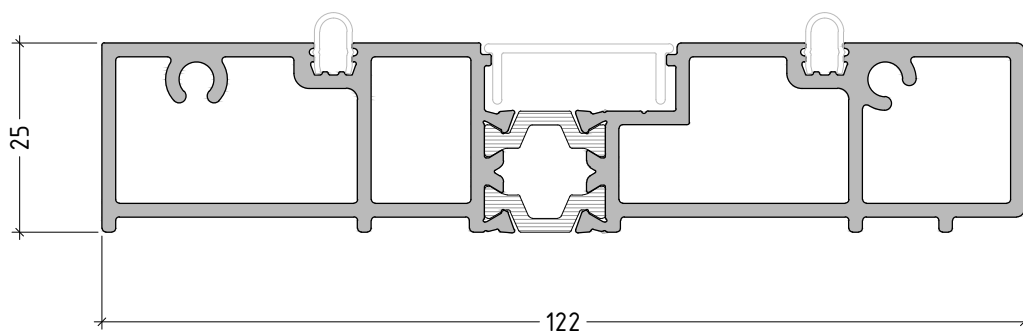

E50171

Additional flat rail

1083 g/m

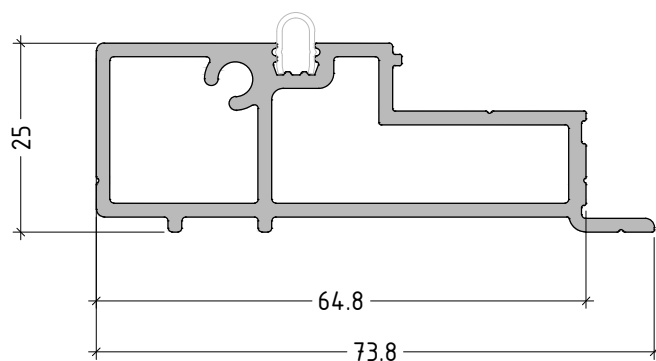

scale : 1:1

E50130

Double rail

2177 g/m

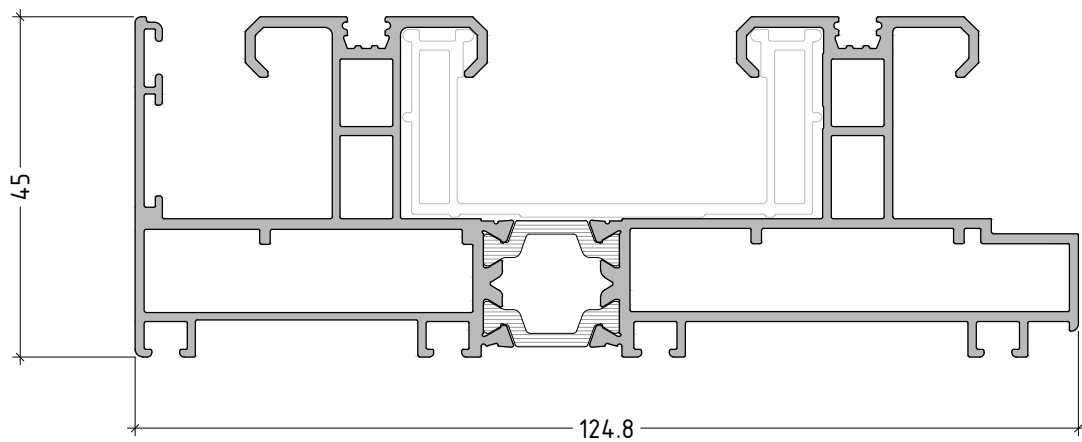

E50111

Additional single
glazing rail

1216 gr/m

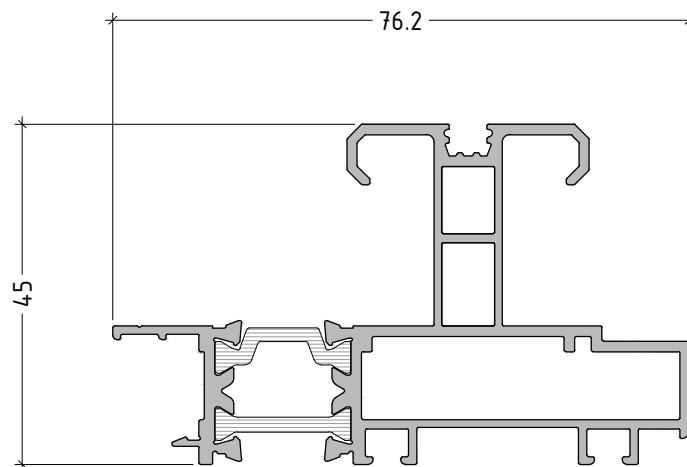

scale : 1:1

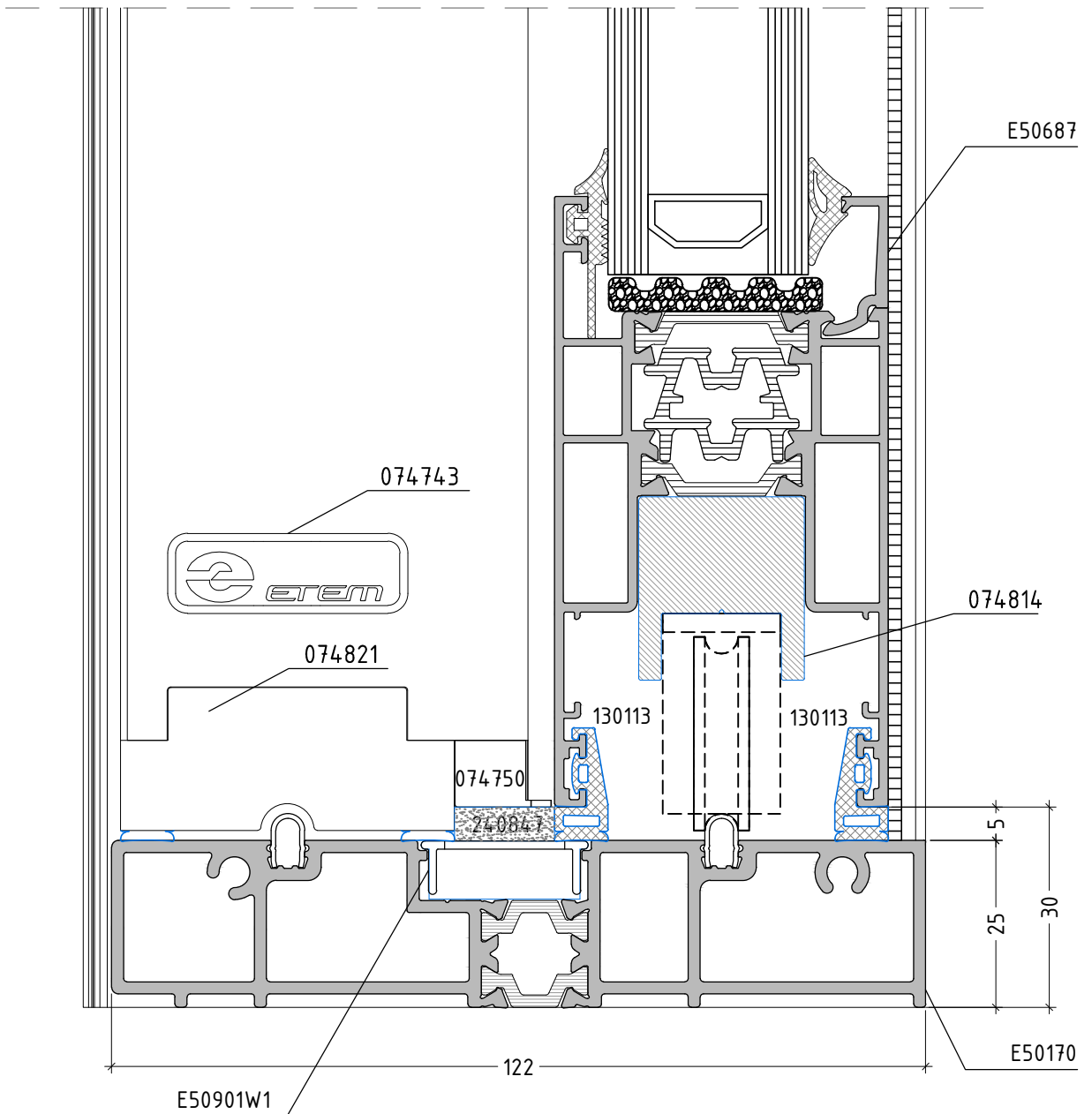
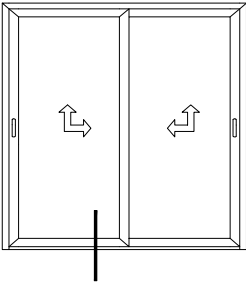

scale : 1:1

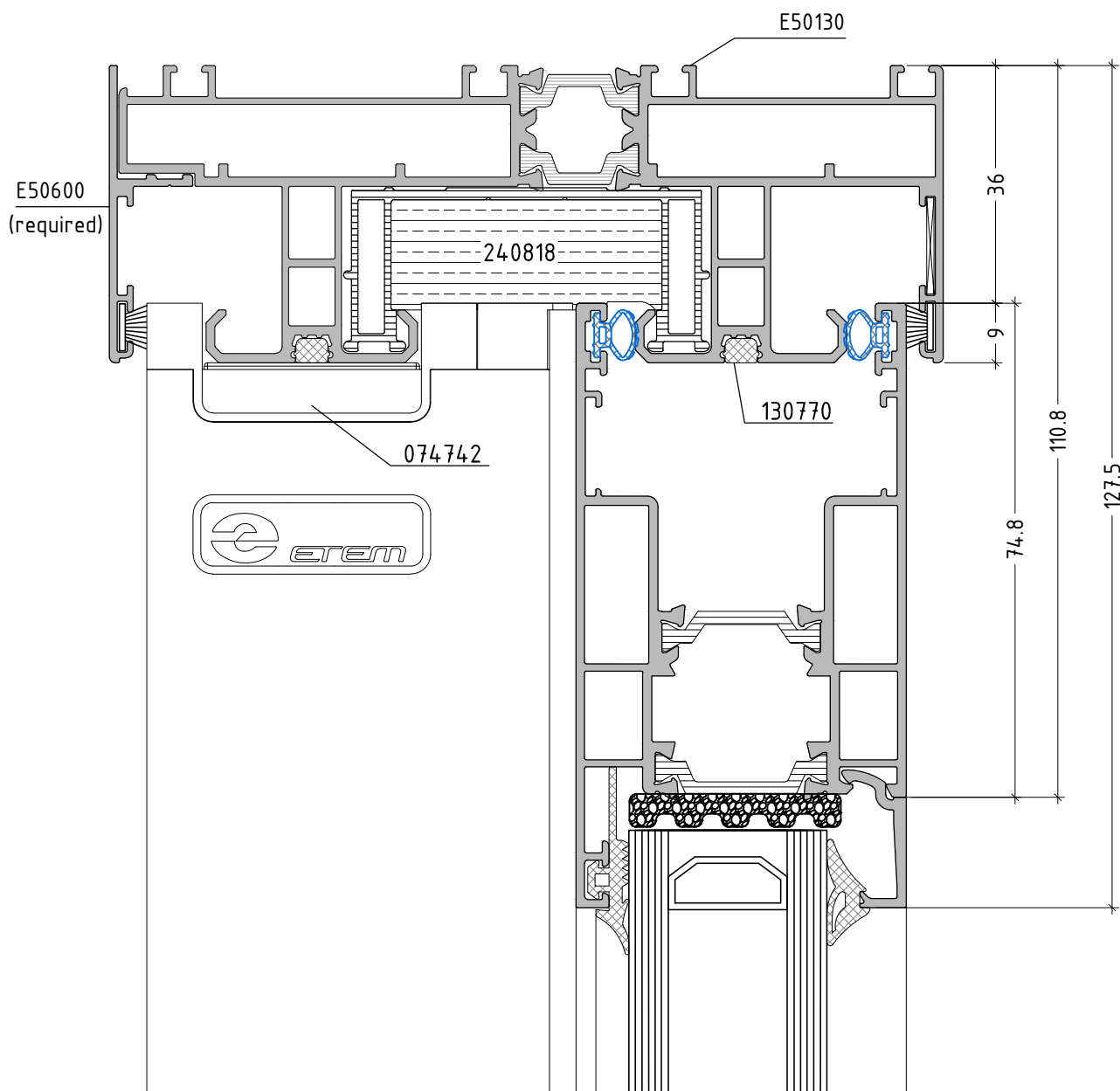
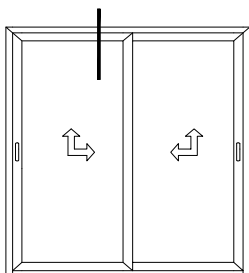

scale : 1:1

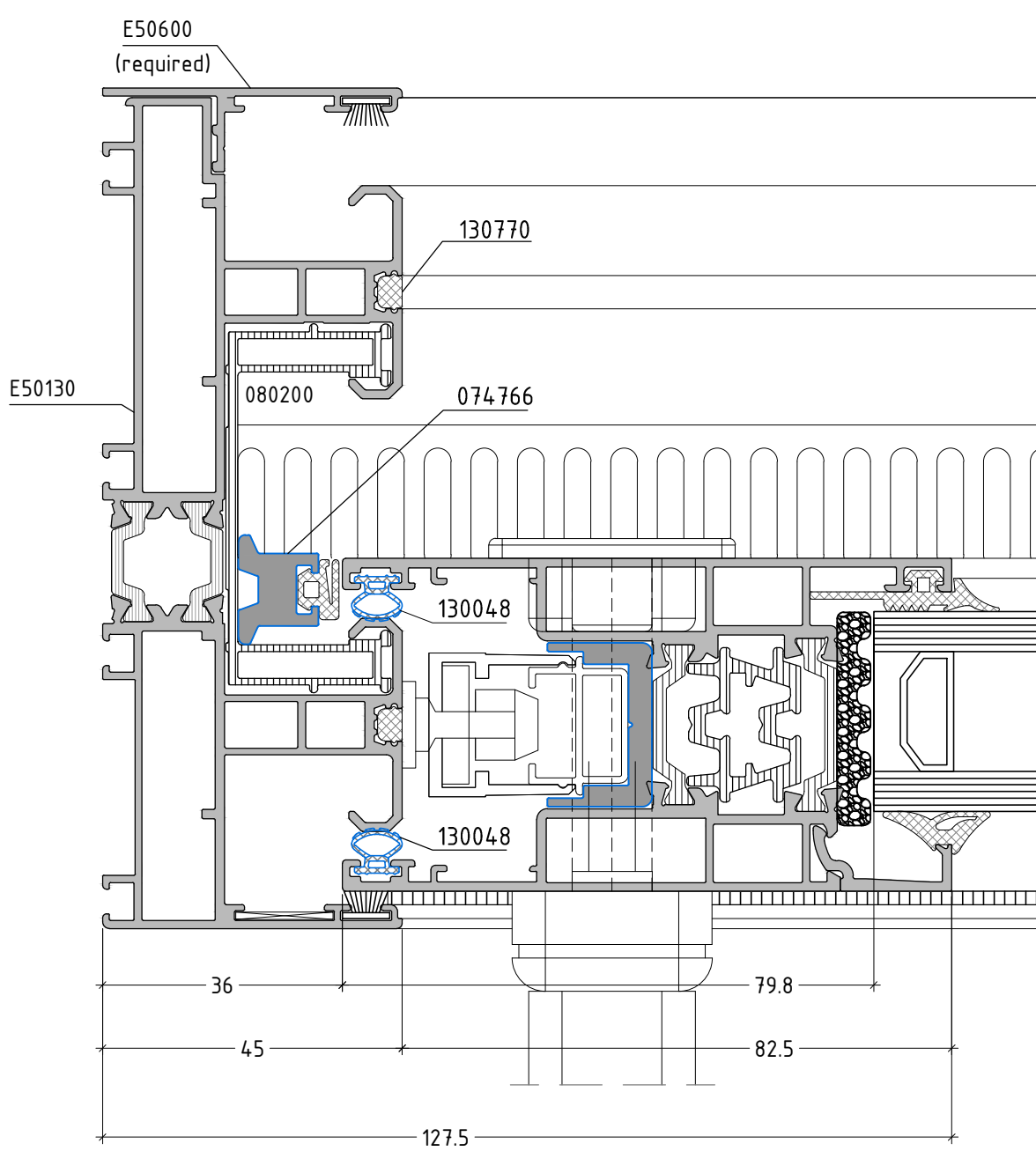
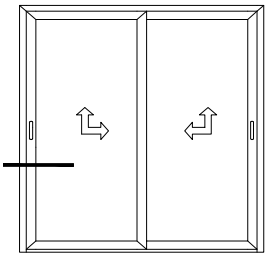

scale : 1:1

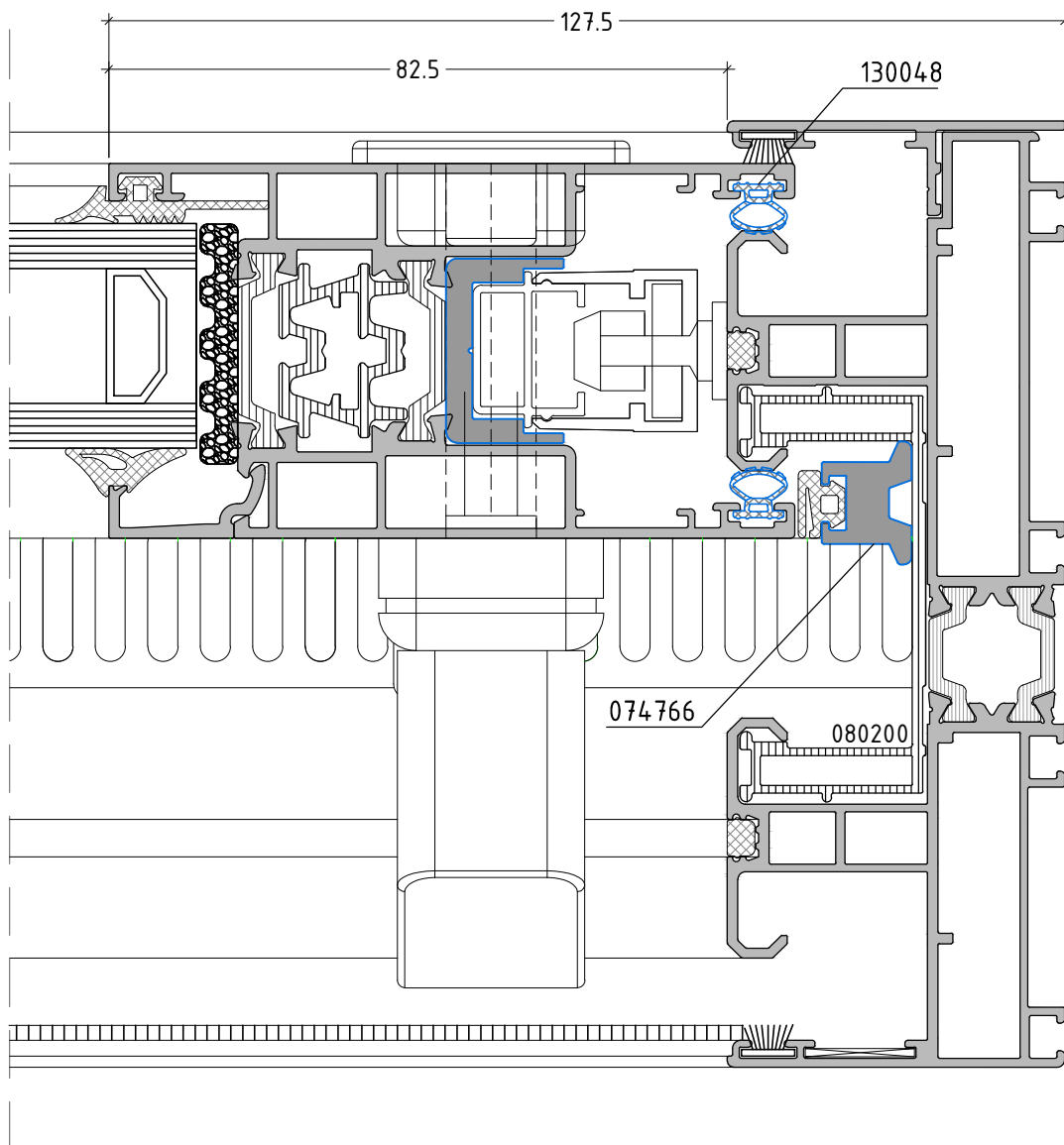
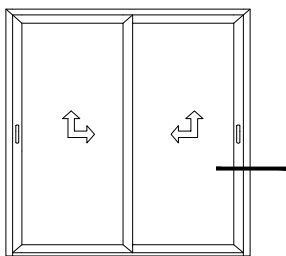

scale : 1:1

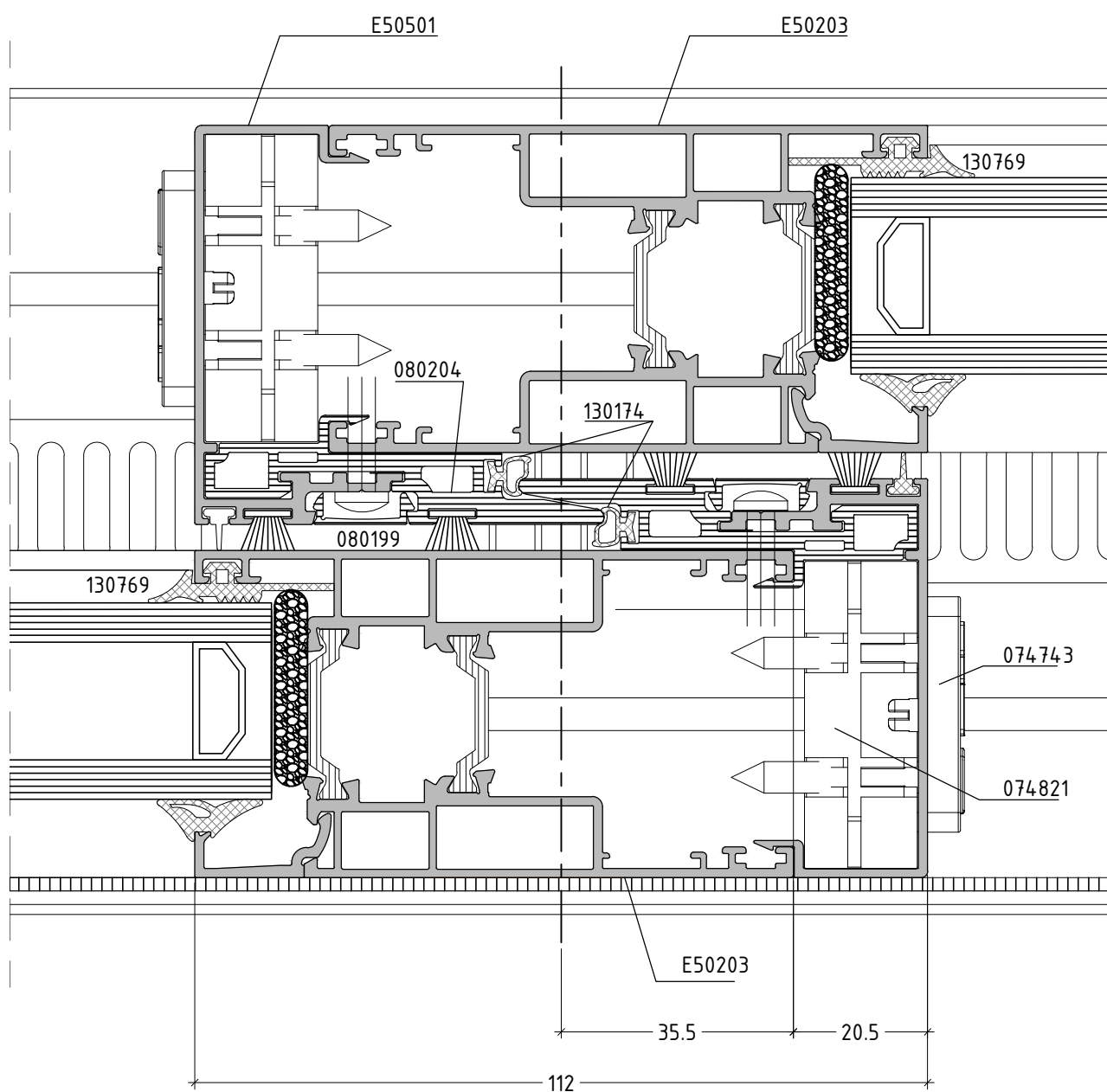
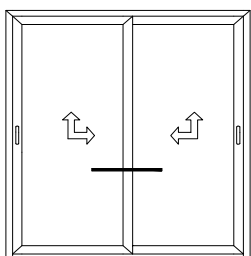

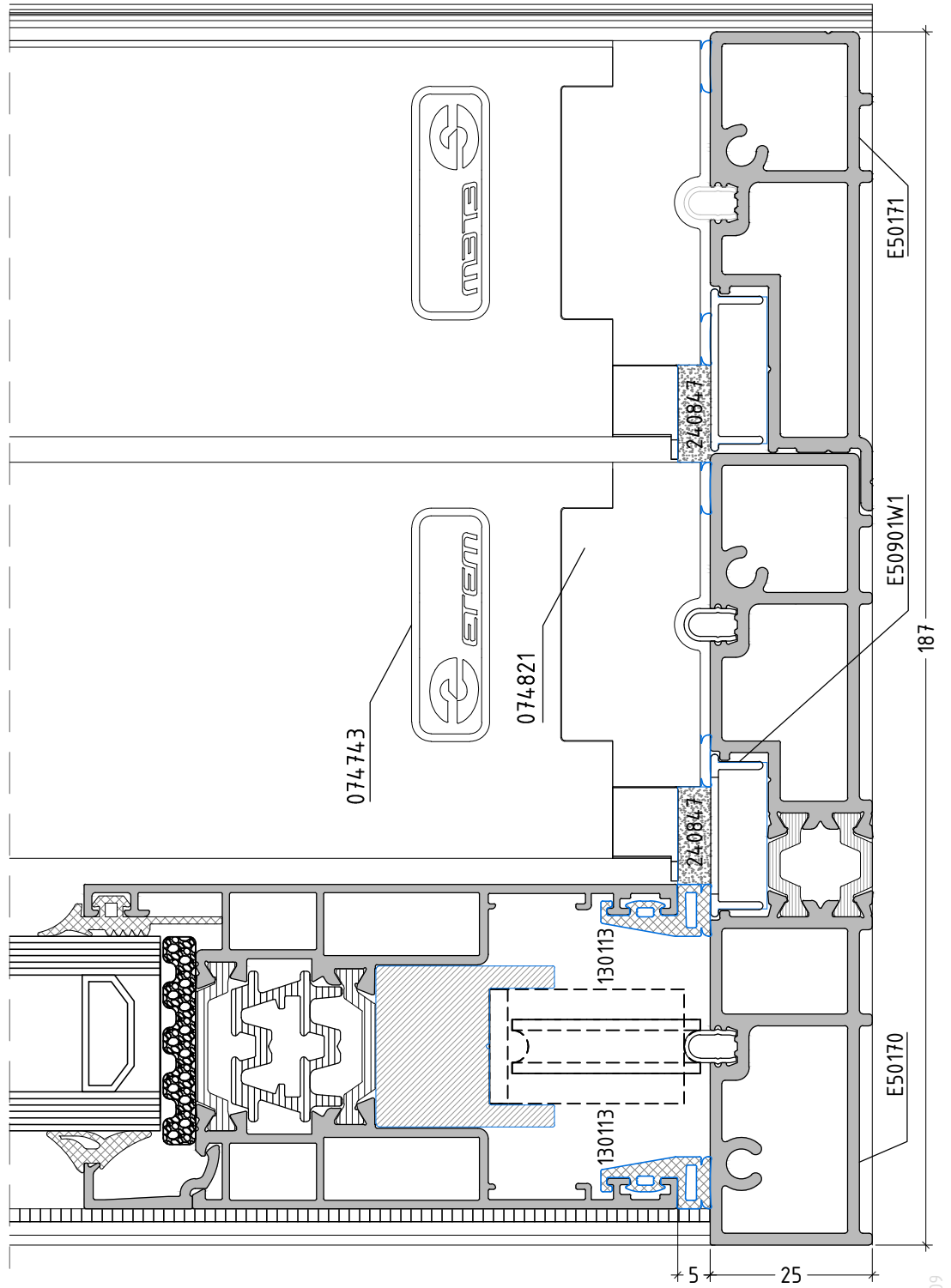
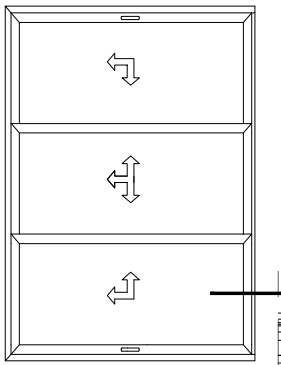

scale 1:1

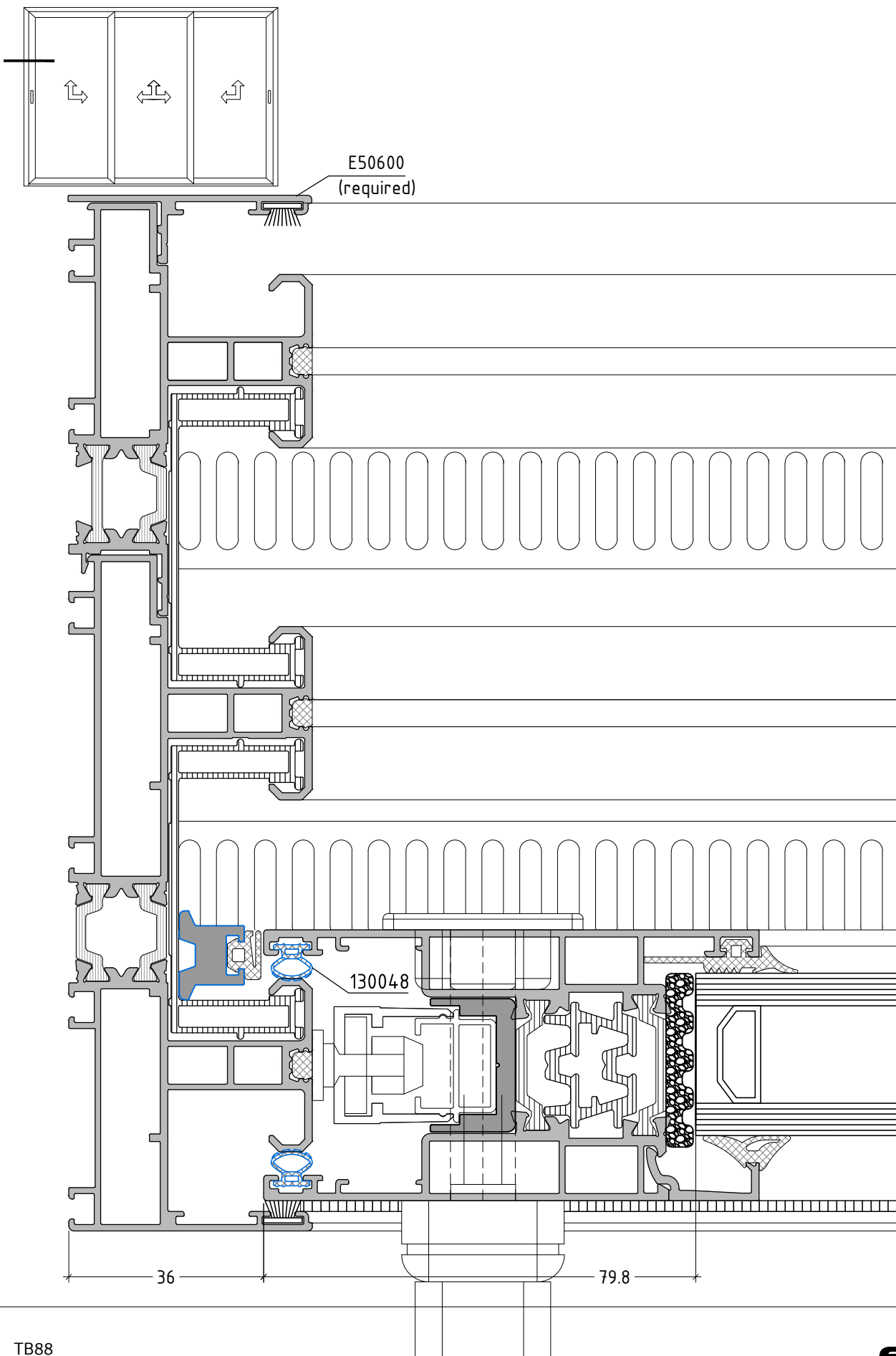

DOUBLE LEAF WITH LIFT-SLIDE MECHANISM WITH CLASSIC INTERLOCK

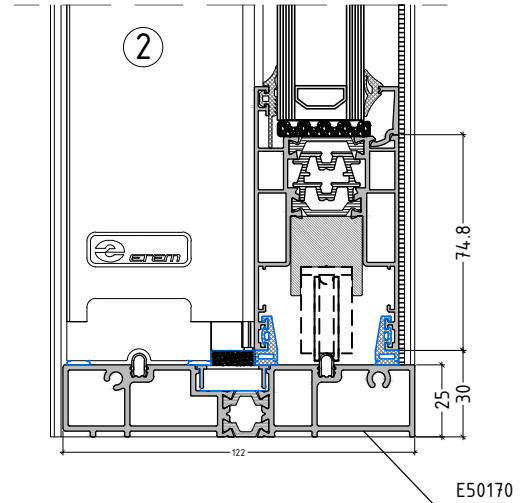
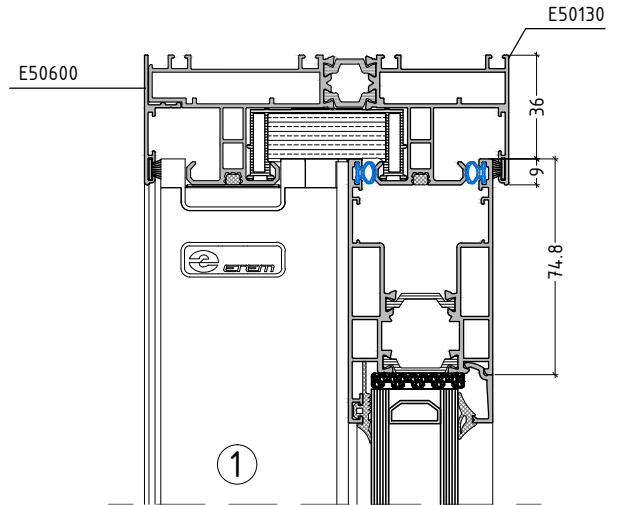
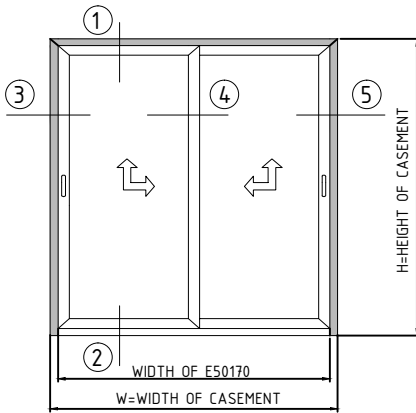

CUTTING LENGTHS	
WIDTH OF RAIL E 50130	= W
HEIGHT OF RAIL E 50130	= H
WIDTH OF RAIL E 50170	= W - 40*
WIDTH OF SASH E50203	= $\frac{W - 2}{2}$
HEIGHT OF SASH E50203	= H - 66
HEIGHT OF SUPL. E 50501	= H - 86

DIMENSION IN MILLIMETERS
ALL MEASUREMENTS ARE TAKEN FROM THE EXTERNAL SIDE OF THE FRAME

*NOTE: CUTTING LENGTH INCLUDE FLANGE THICKNESS (ET076678.00)

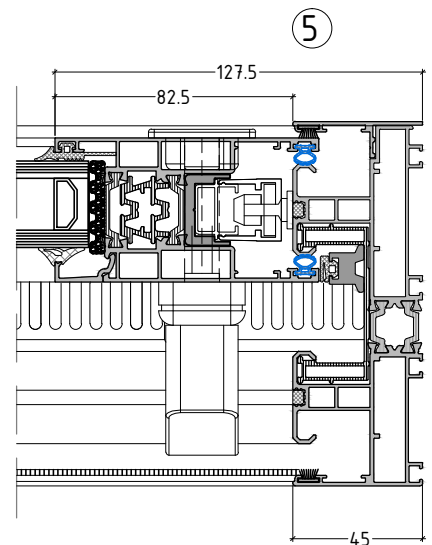
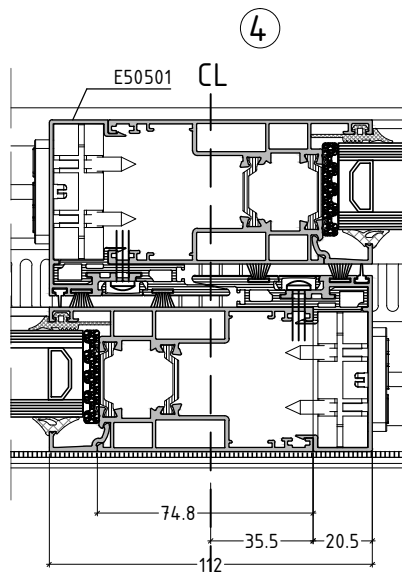
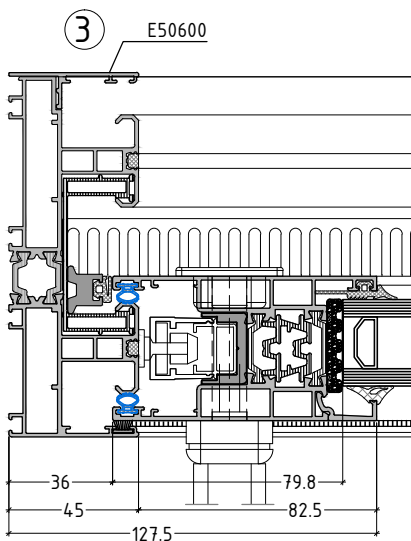
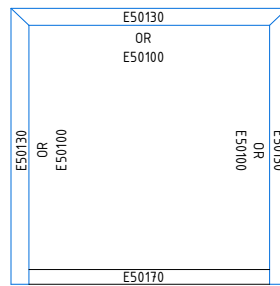

FOUR LEAF WITH LIFT-SLIDE MECHANISM

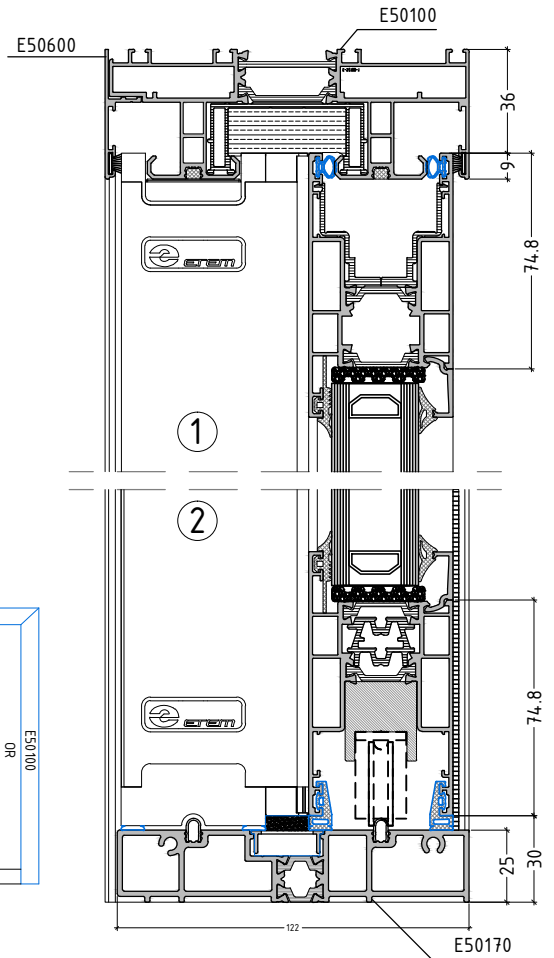
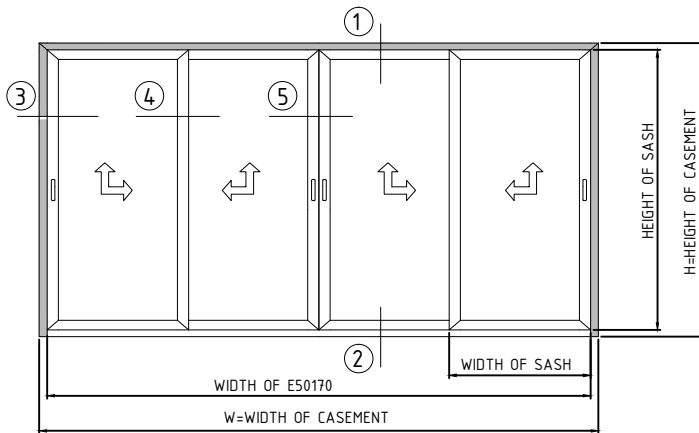

CUTTING LENGTHS

WIDTH OF RAIL E 50100	= W
HEIGHT OF RAIL E 50100	= H
WIDTH OF RAIL E 50170	= W - 40*
WIDTH OF SASH E50203	= $\frac{W + 56}{4}$
HEIGHT OF SASH E50203	= H - 66
HEIGHT OF SUPL. E 50501	= H - 86
HEIGHT OF ADJOIN. E 50500	= H - 120

DIMENSION IN MILLIMETERS
ALL MEASUREMENTS ARE TAKEN FROM THE
EXTERNAL SIDE OF THE FRAME

* NOTE: CUTTING LENGTH INCLUDE FLANGE
THICKNESS (ET076678.00)

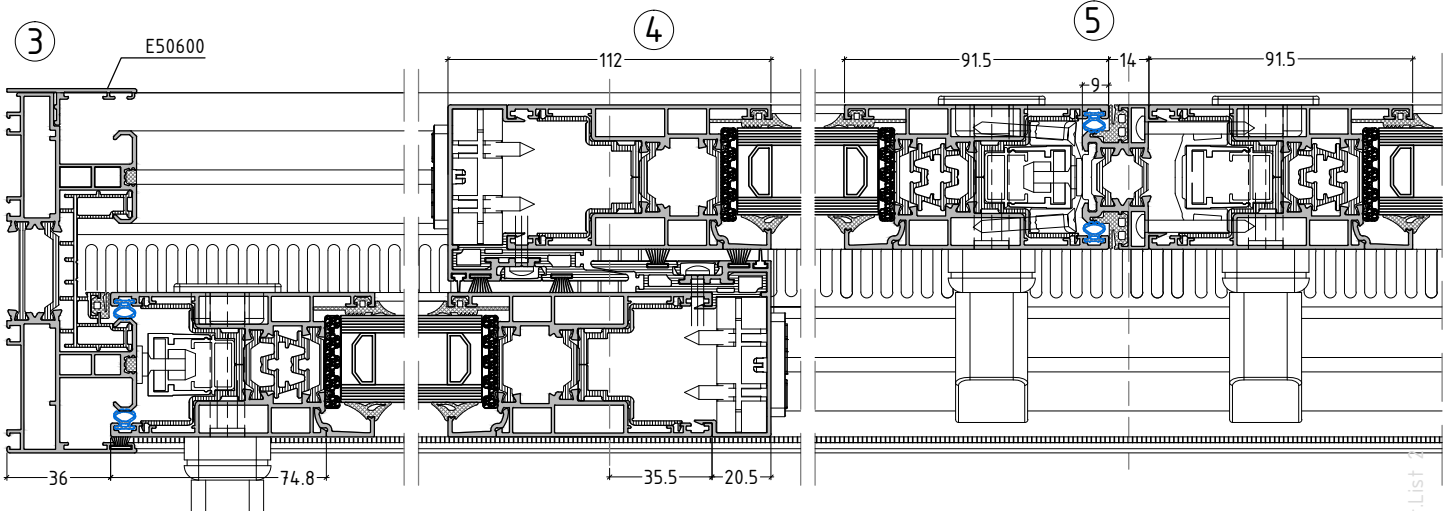
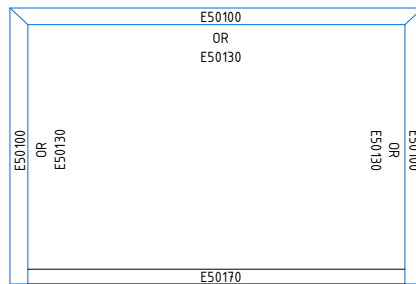

CutList

MACHINING ON INTERLOCK PROFILES E50501

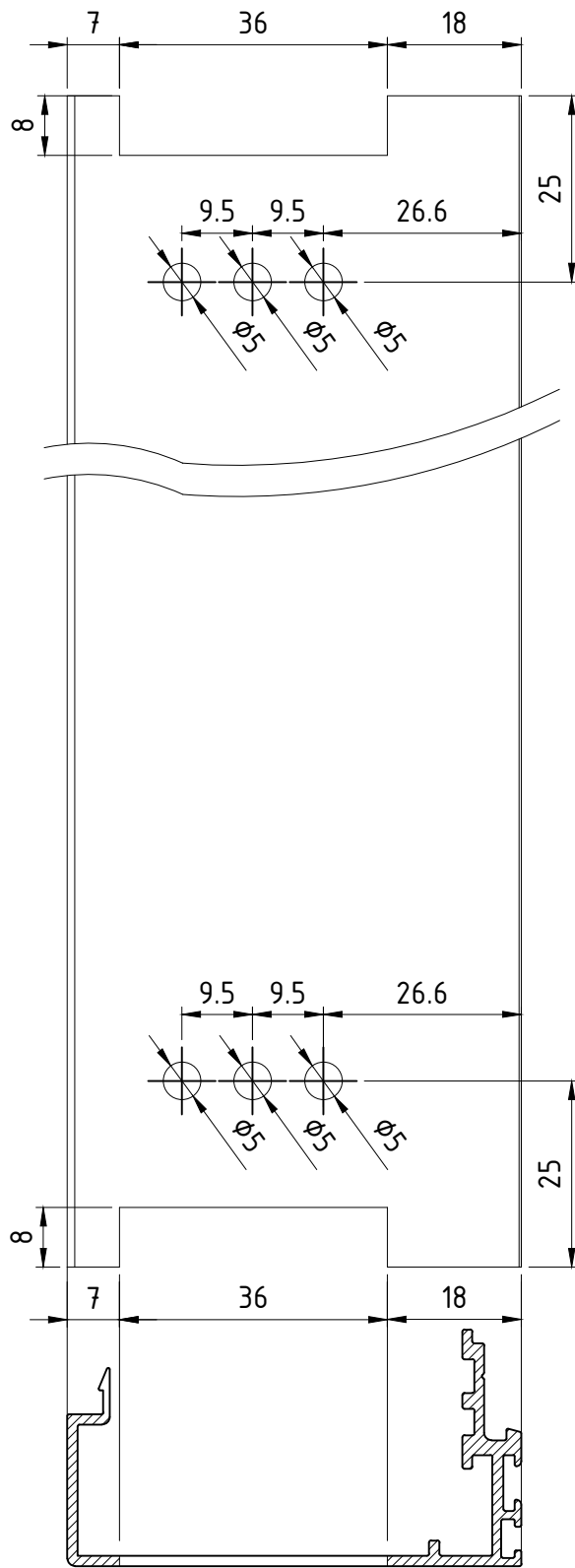

E50501

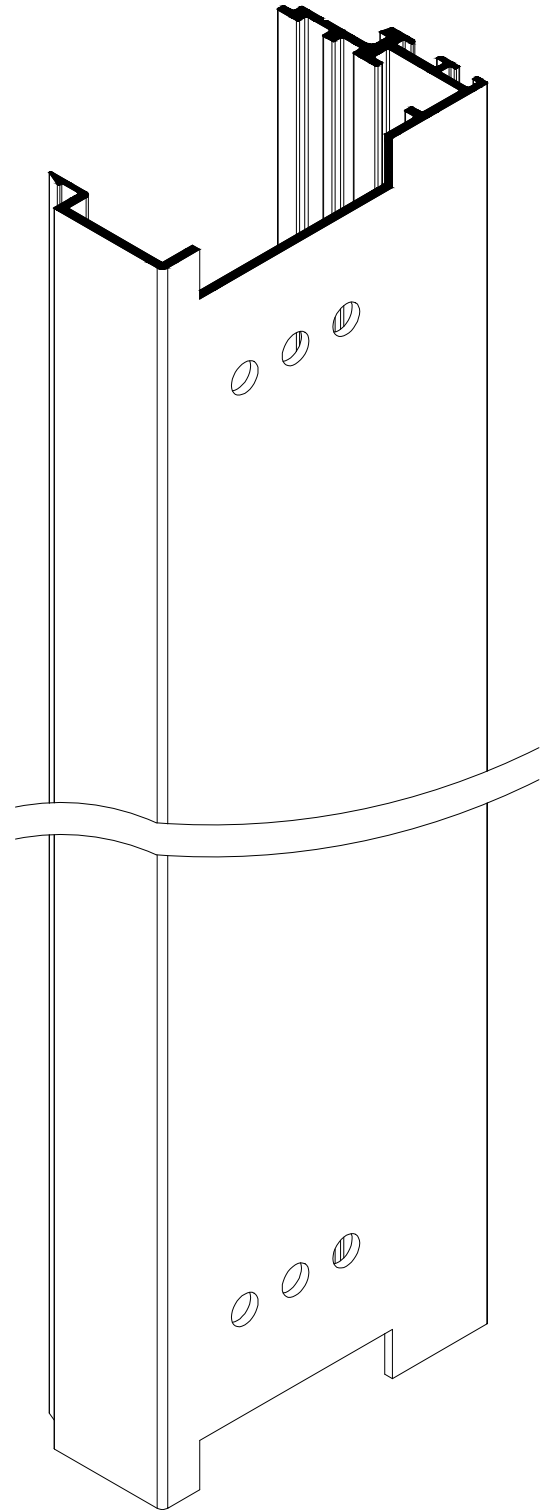

Note:
The machining is done on E50 punching machine

FIXING ACCESSORIES ON INTERLOCK PROFILE E50501 (FOR FLAT RAIL E50170)

ET 074742.00

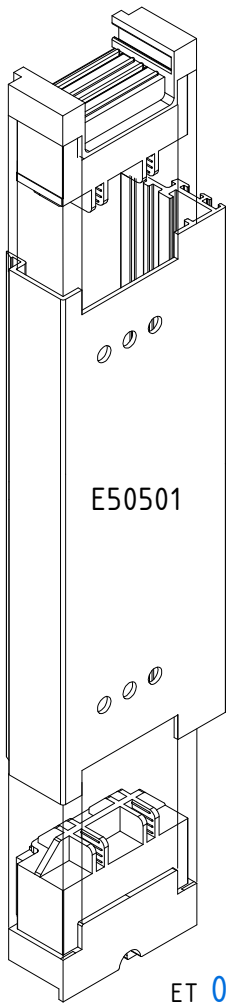

TOP

BOTTOM

E50501

ET 074821.00

PLUG ET.074821.00 IS FIXED ONTO THE BOTTOM SIDE OF INTERLOCK PROFILE E50501, WHILST PLUG ET.074742.00 IS FIXED ONTO THE TOP SIDE

ET 080204.00

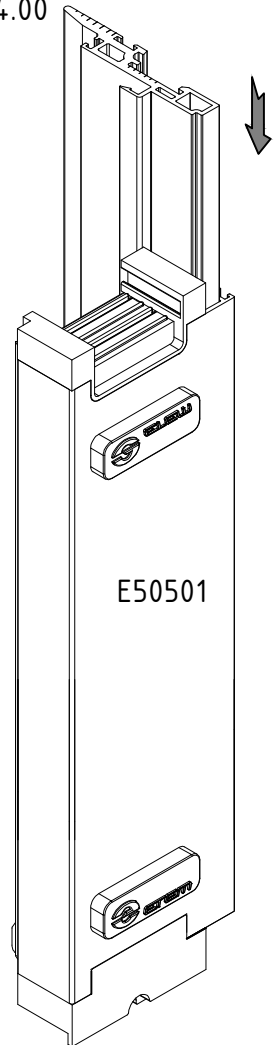

4.2x25mm
DIN 7981

E50501

ALWAYS PUT 2 PCS OF GASKET ET.130113, ONTO THE BOTTOM PLUG (ET.074821.00)

ET 074743.00

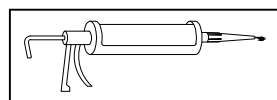
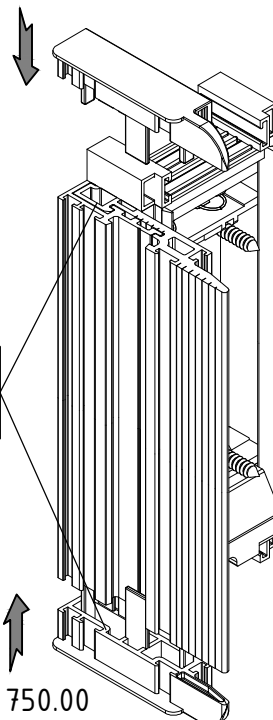

ET138001.00

FIX ON BOTH SIDES OF PLASTIC SPACER ET.080204.00 THE PLASTIC PLUG ET.074750.00. ALWAYS APPLY SILICON IN ADVANCE AT THE SURFACE WHERE THE PLUG IS TO BE FIXED

ET 074 750.00

INSERT PLASTIC SPACER ET.080204.00 INTO THE INTERLOCK PROFILE E50501, AS PRESENTED IN THE DRAWING

ET 080204.00

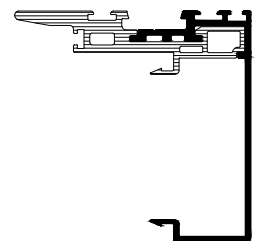

E50501

E50501

FIXING ACCESSORIES ON ADJOINING PROFILE E50500 (FOR FLAT RAIL E50170)

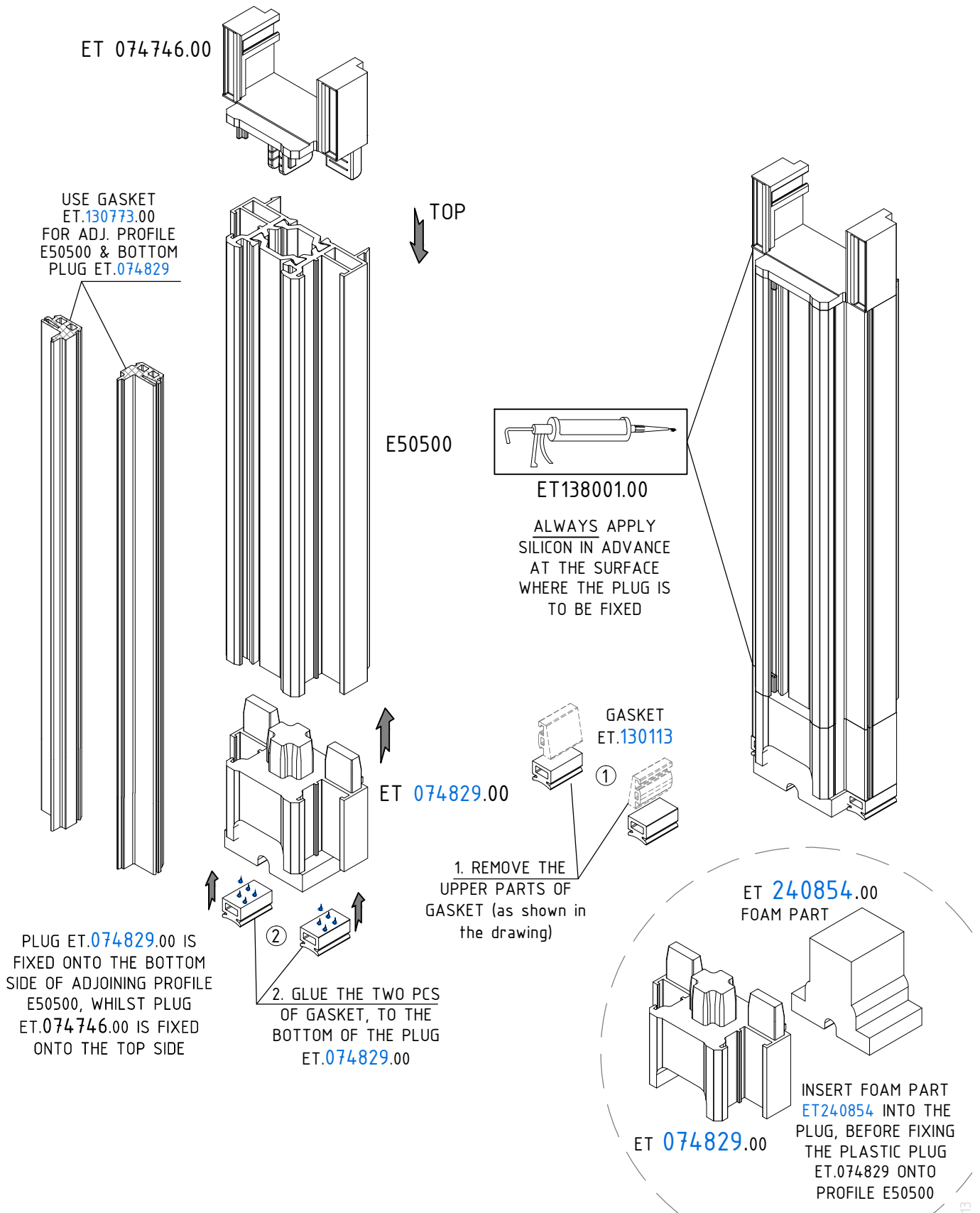

INSTRUCTIONS FOR SEALING BLOCK ET.240847.00

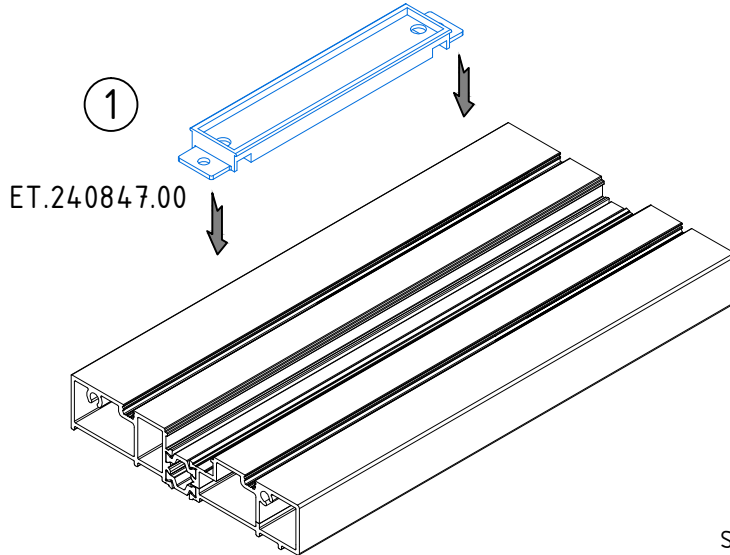

①

ET.240847.00

SEALING BLOCK
ET.240847.00 IS INSERTED
INTO THE BOTTOM RAIL
EITHER BEFORE
ASSEMBLING ALL PARTS
OF THE RAIL OR AFTER
ASSEMBLY.

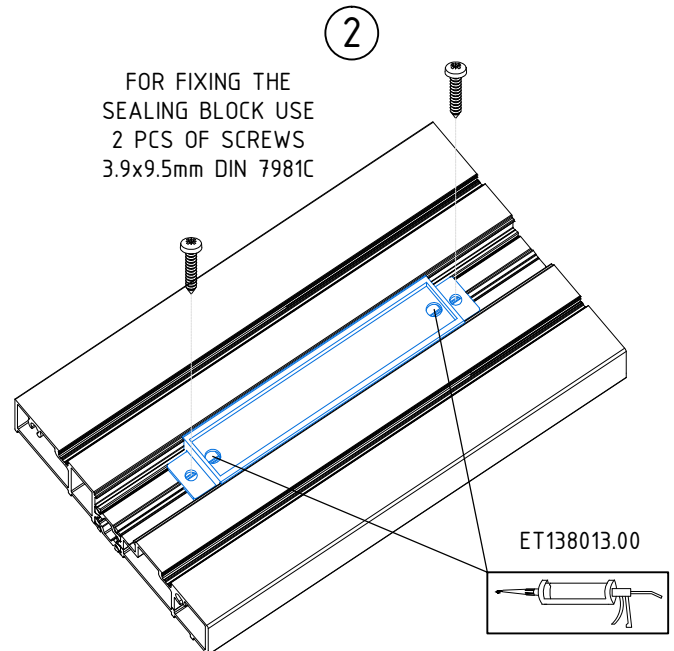

②

FOR FIXING THE
SEALING BLOCK USE
2 PCS OF SCREWS
3.9x9.5mm DIN 7981C

ET138013.00

FIX INTO THE CAVITY OF THE SEALING
BLOCK THE FOAMS ACCESSORIES

③

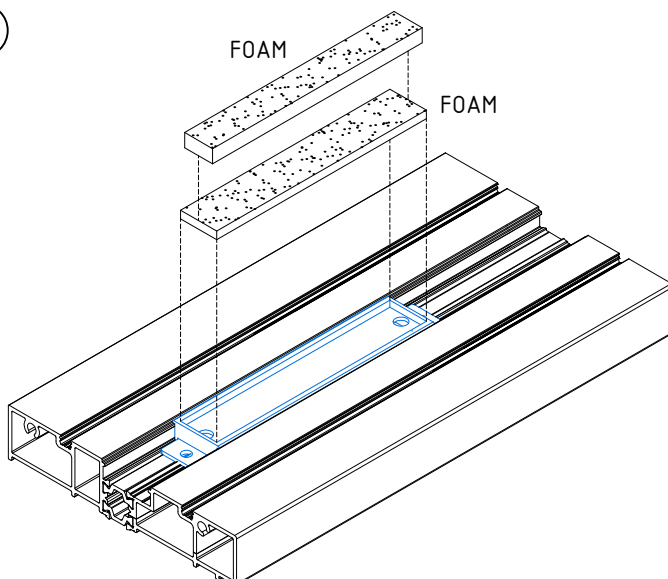

FOAM

FOAM

ALWAYS APPLY SEALANT
ET.138013.00 INTO THE HOLES OF
SEALING BLOCK ET.240847.00

MACHINING REQUIRED FOR 90° CONNECTION OF RAILS

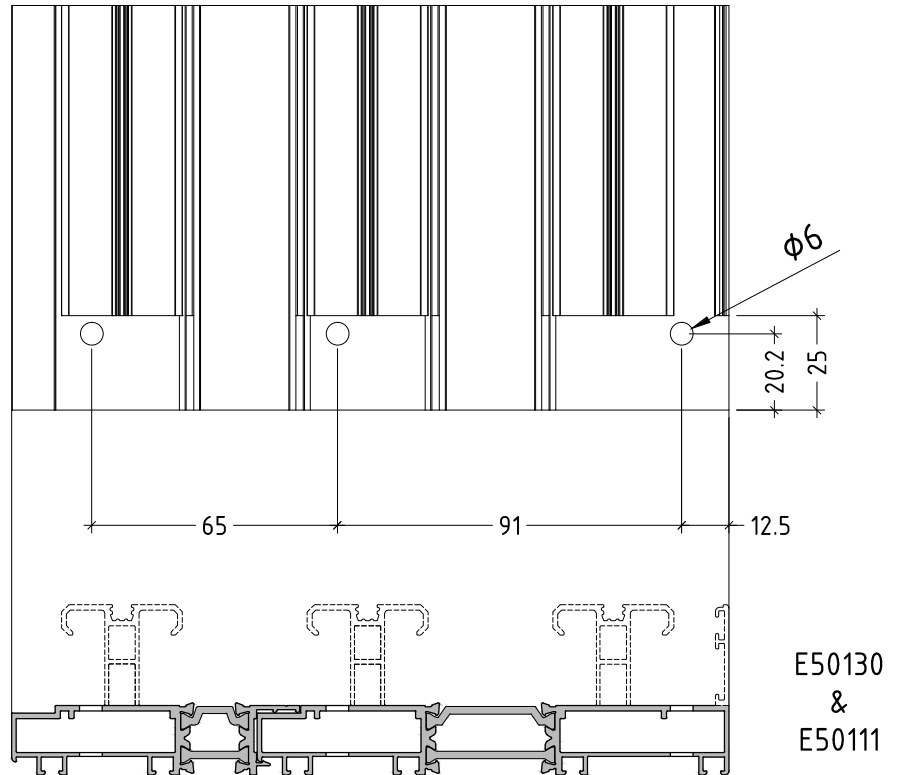
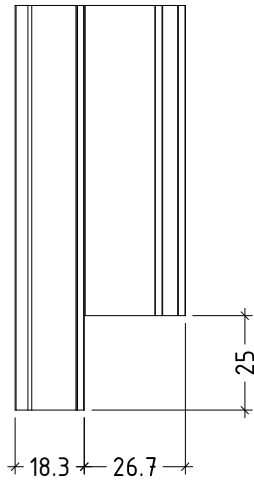
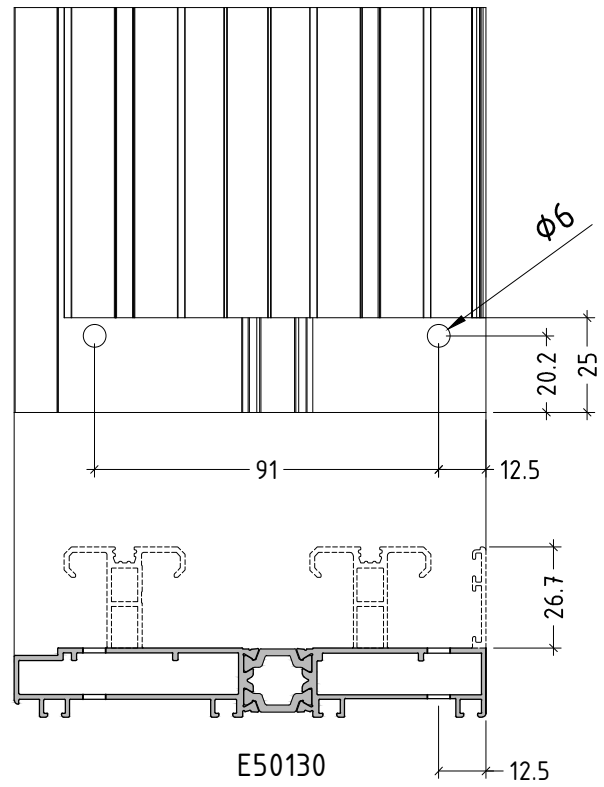
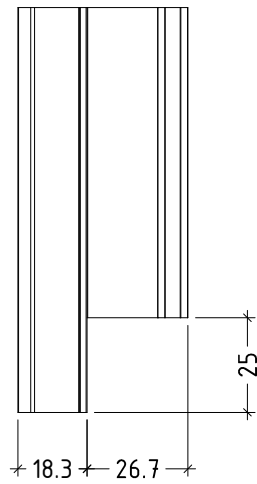

INSTRUCTIONS FOR 90° CONNECTION OF RAILS

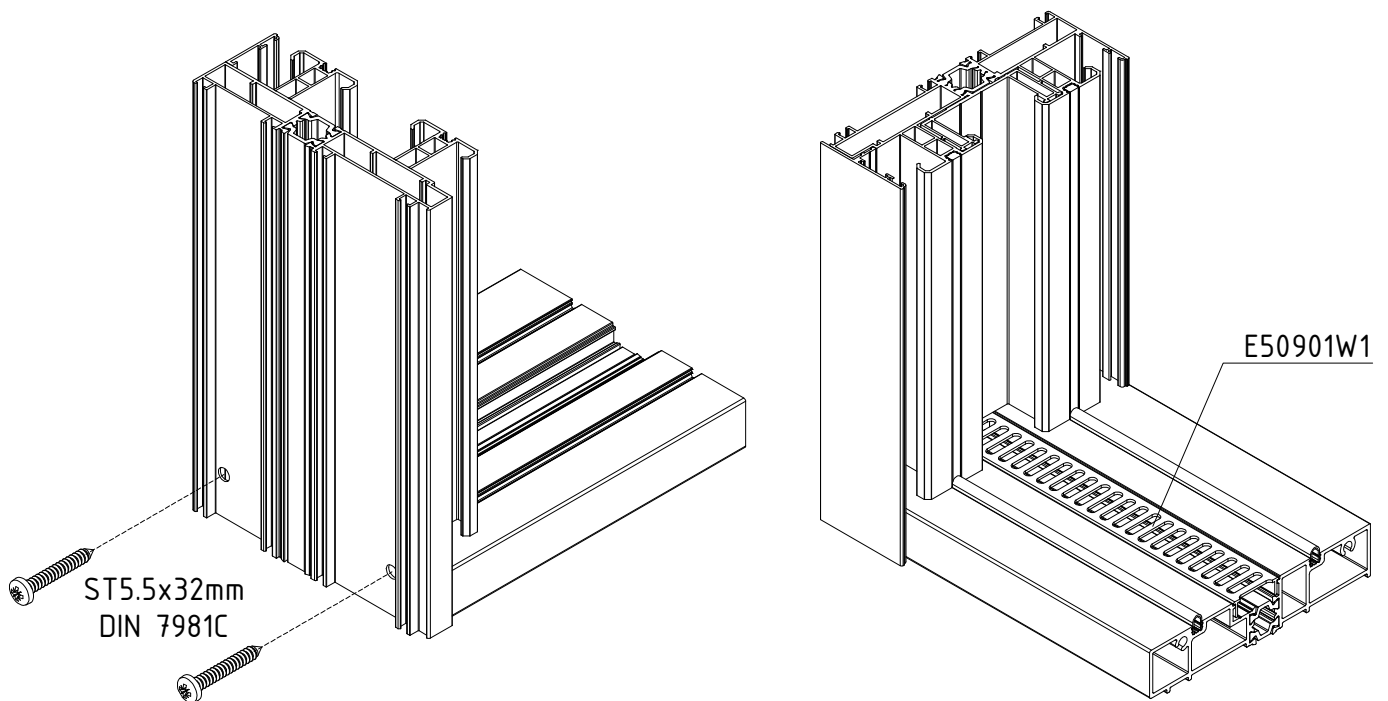
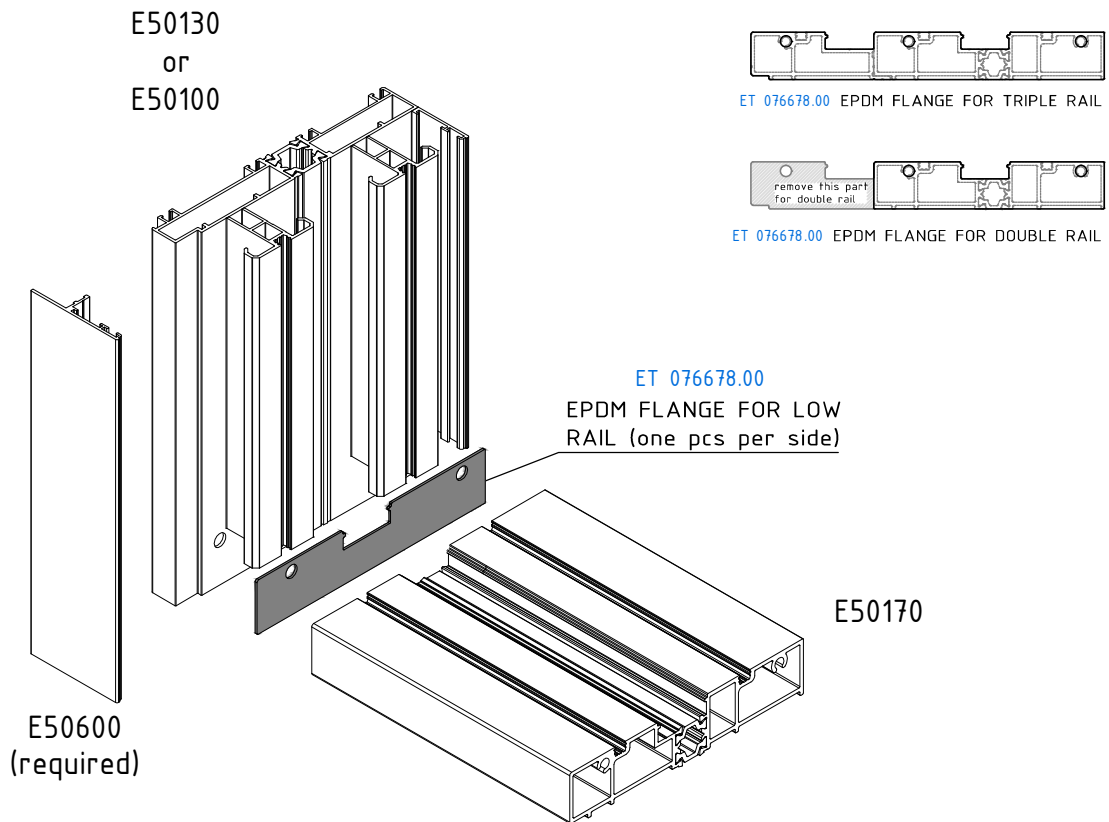

MACHINING ON FLAT RAIL E50170 FOR DRAINAGE

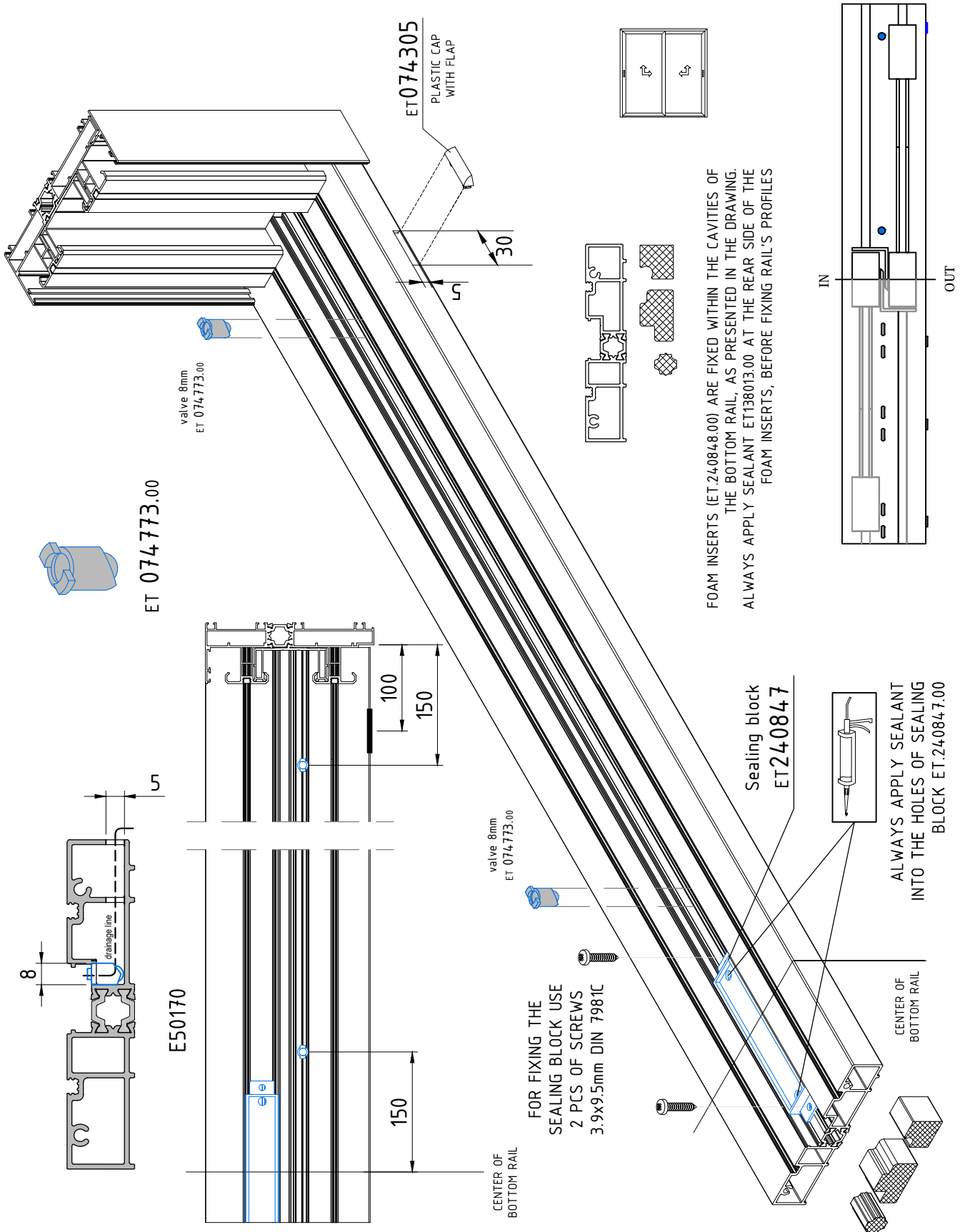

FOAM INSERTS (ET.240848.00) ARE FIXED WITHIN THE CAVITIES OF THE BOTTOM RAIL, AS PRESENTED IN THE DRAWING. ALWAYS APPLY SEALANT ET138013.00 AT THE REAR SIDE OF THE FOAM INSERTS, BEFORE FIXING RAIL'S PROFILES

ALWAYS APPLY SEALANT INTO THE HOLES OF SEALING BLOCK ET.240847.00

MACHINING ON FLAT RAIL E50170 FOR DRAINAGE

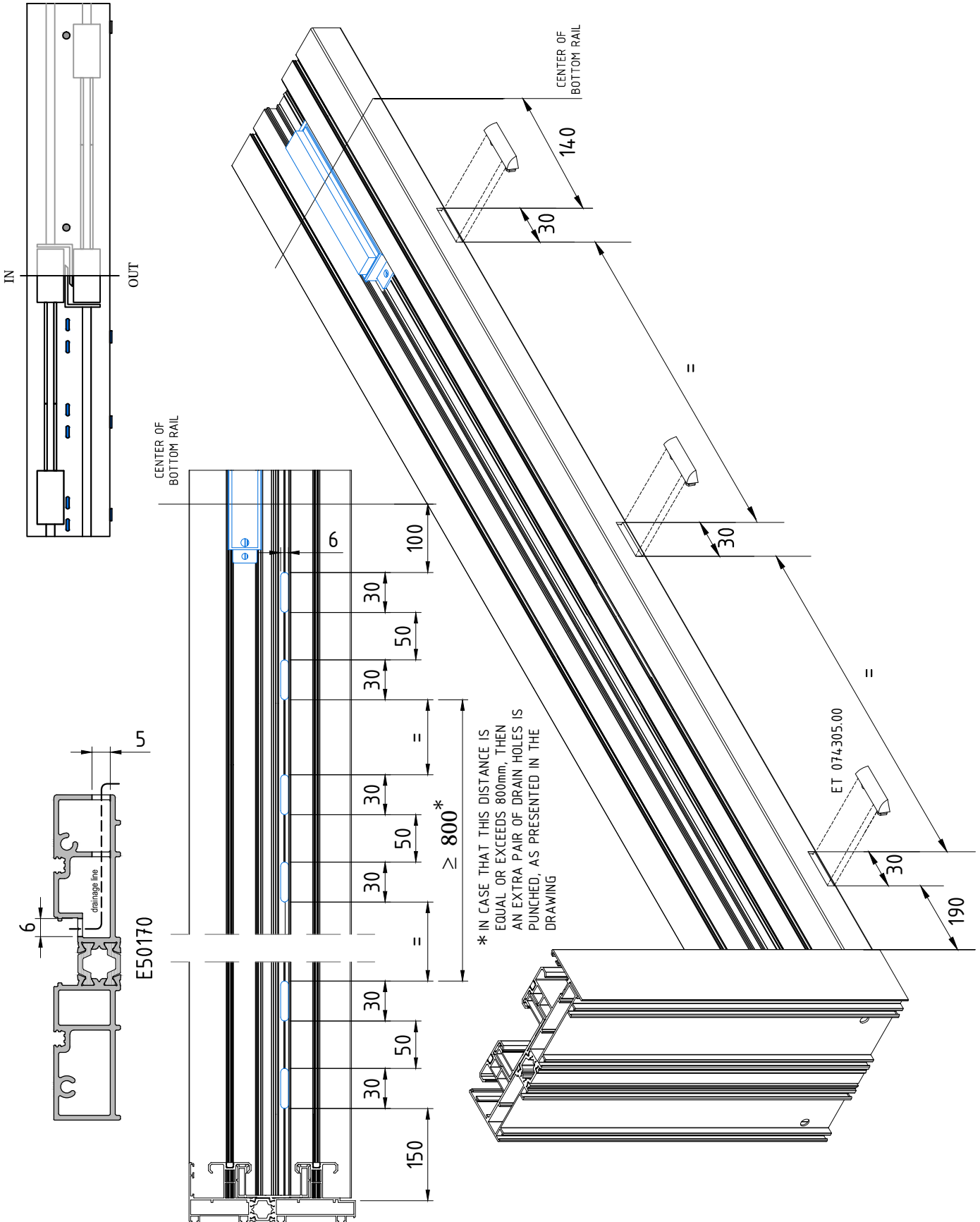

MACHINING ON TRIPLE FLAT RAIL FOR DRAINAGE

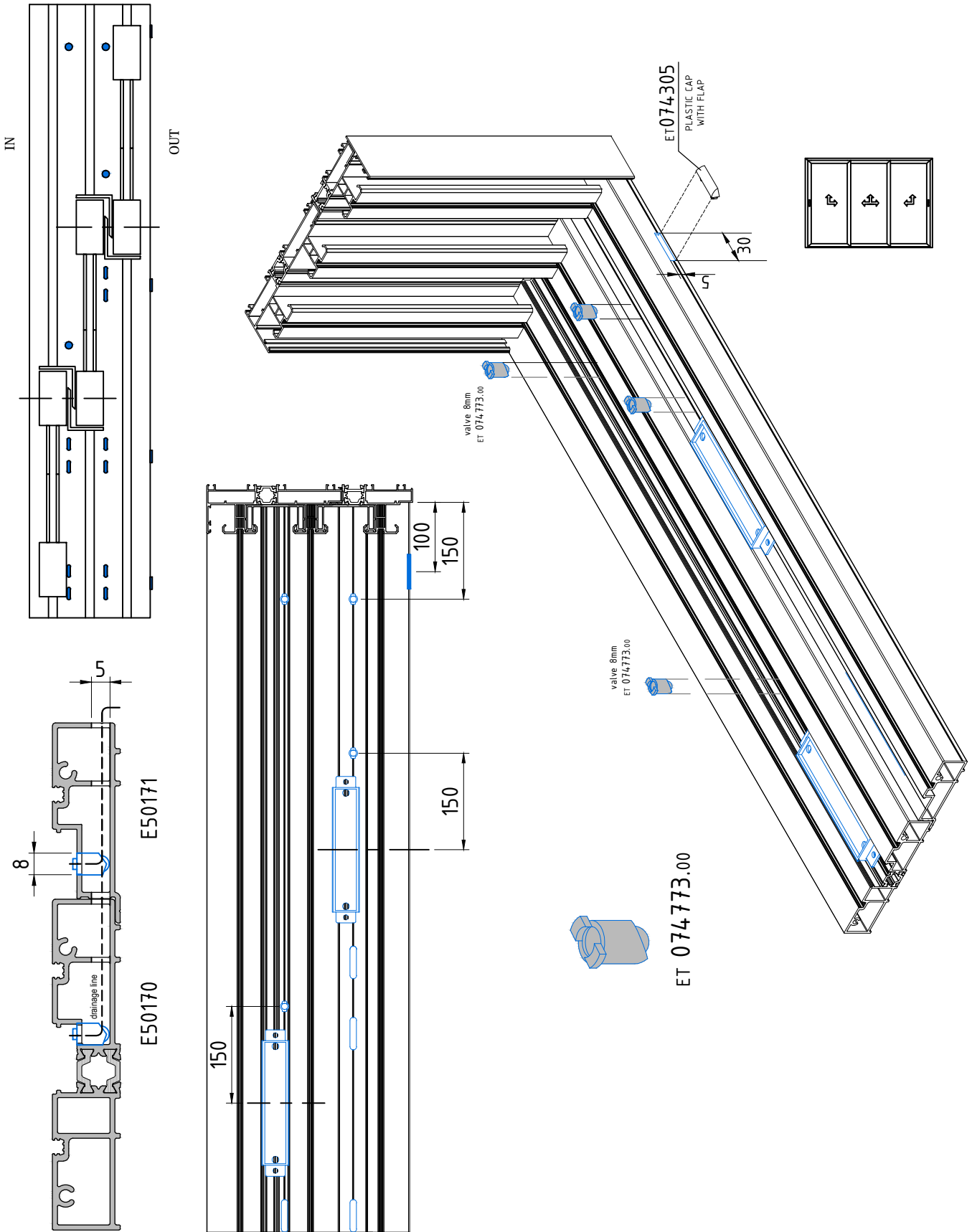

MACHINING ON TRIPLE FLAT RAIL FOR DRAINAGE

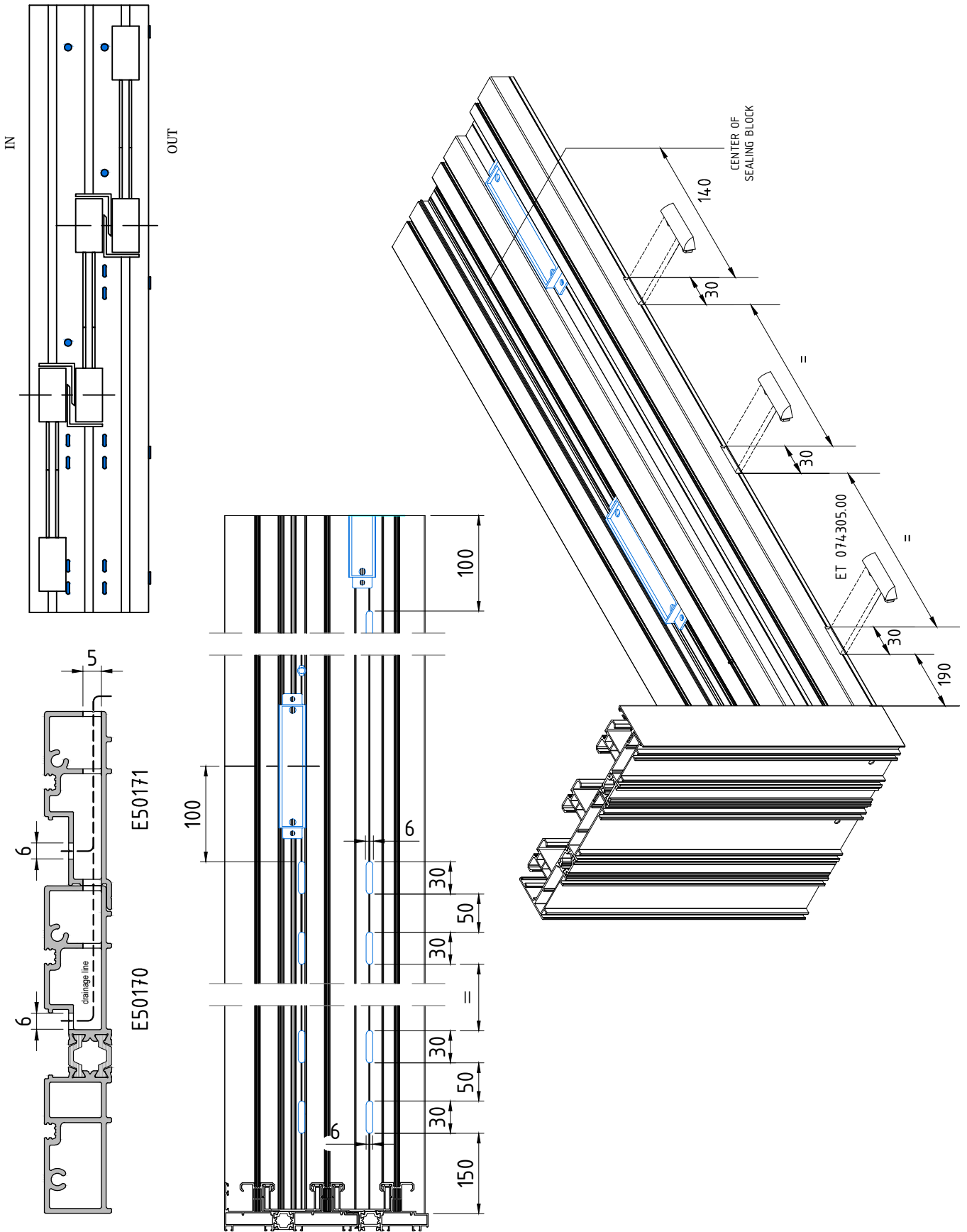

INSTRUCTIONS FOR PLASTIC STOPPER ET.074.766.00 (FOR RAIL E50130)

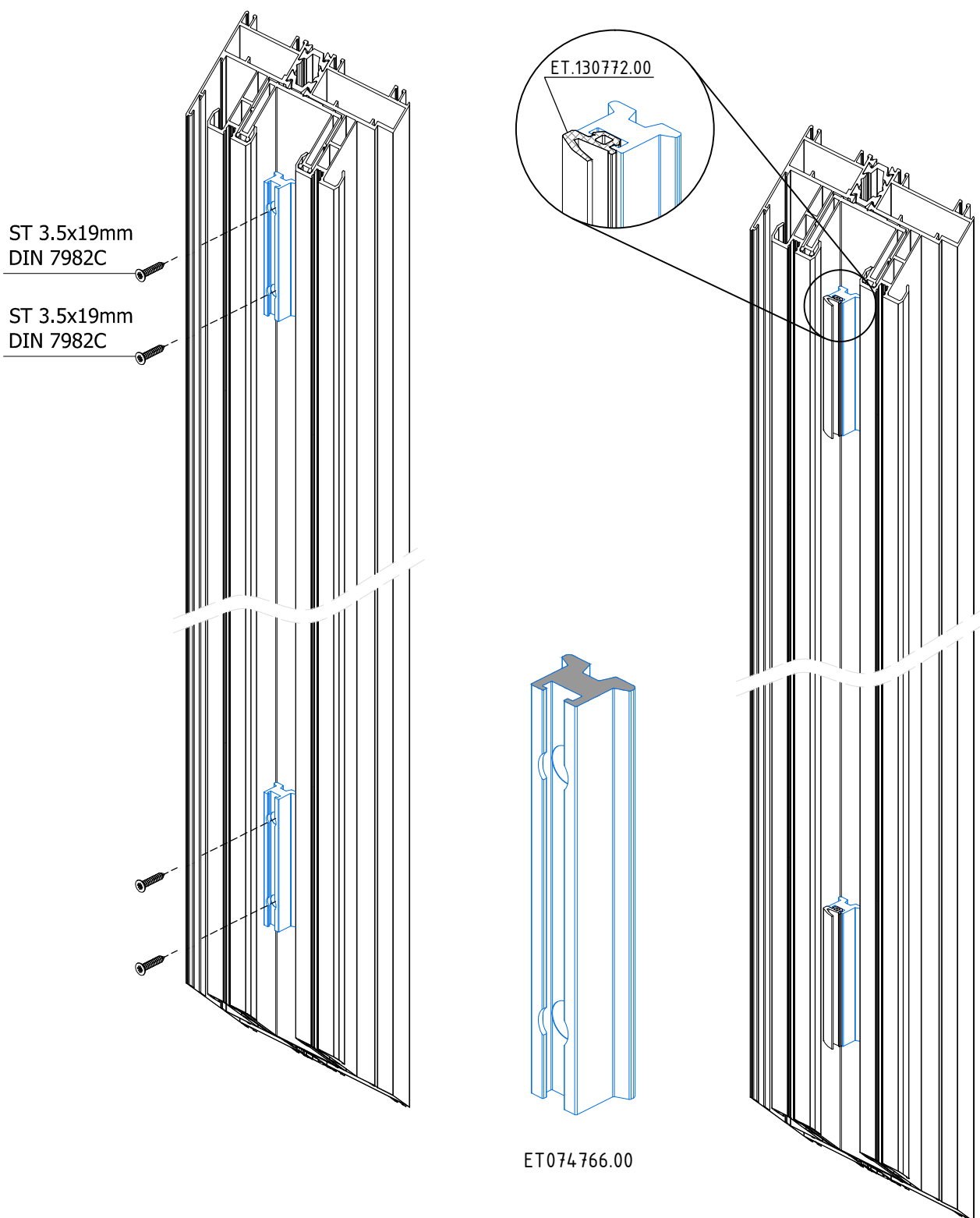

MACHINING REQUIRED FIXING HANDLE & HARDWARE ON BALCONY DOOR SASH
FOR GU HARDWARE

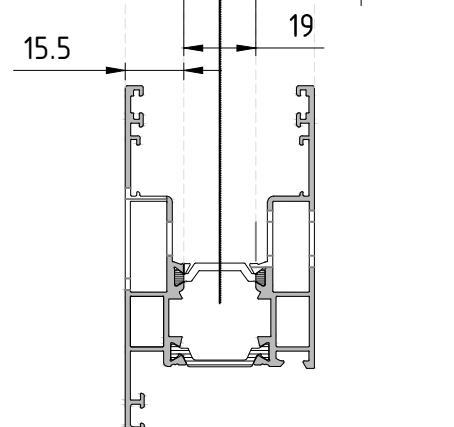
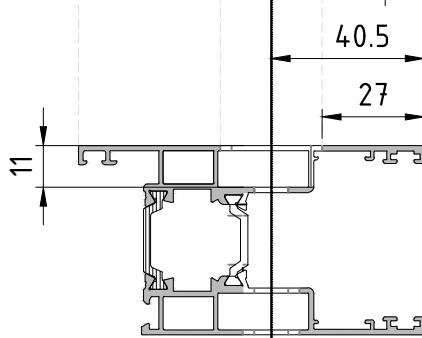
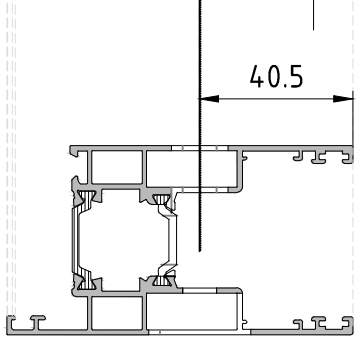
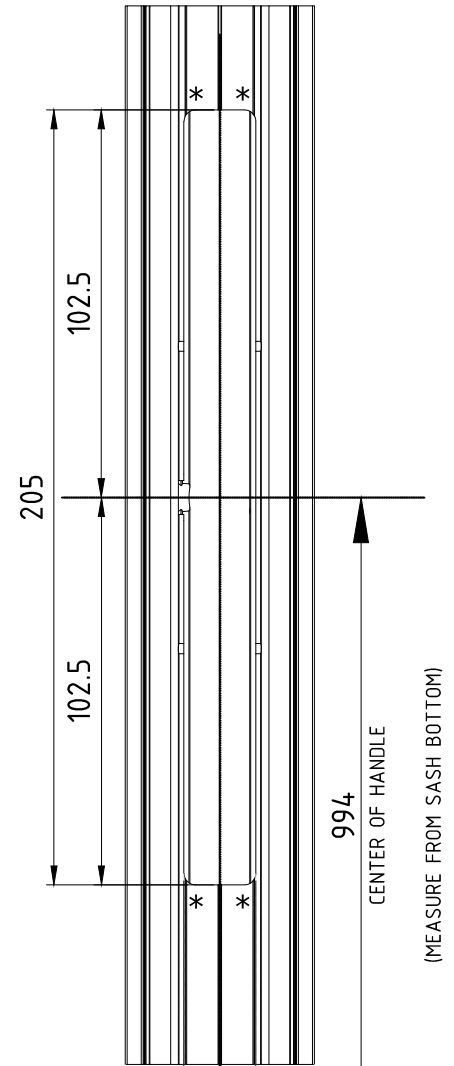
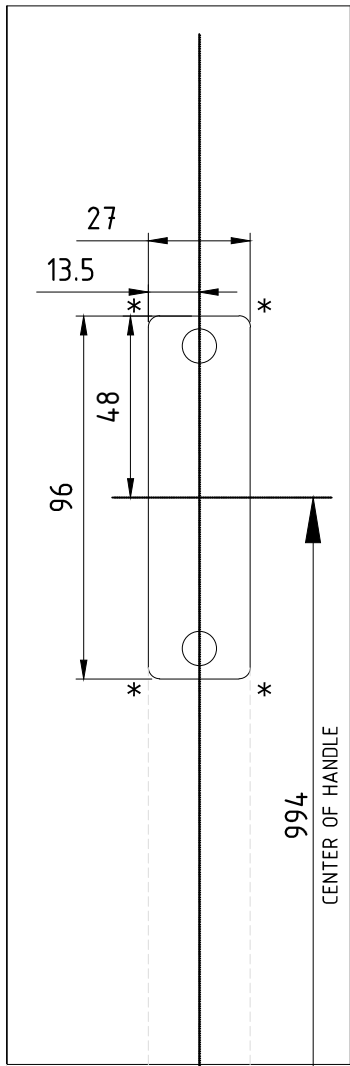
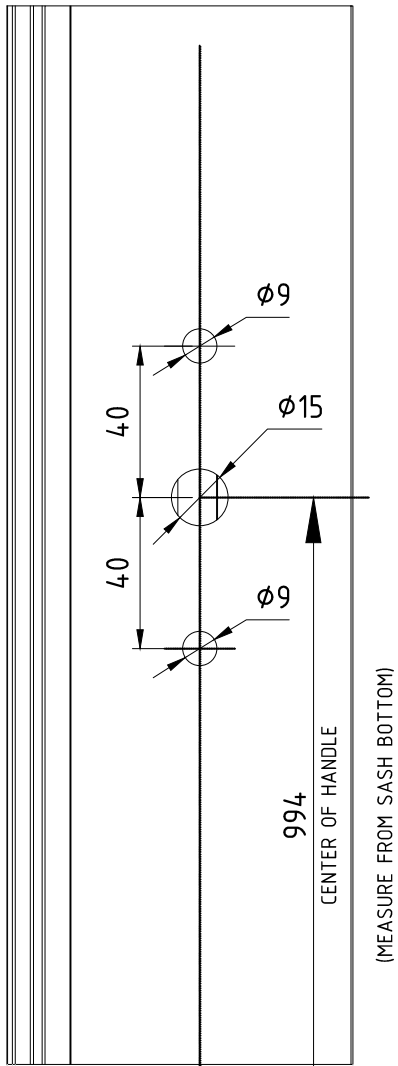

E50203

* R=3mm

* R=3mm

ATTENTION: ALL THE ABOVE ARE VALID FOR 150KG LIFT & SLIDE HARDWARE

ATTENTION: THE CENTRE OF THE HARDWARE IS VALID ONLY FOR DOORS

ATTENTION: THESE INSTRUCTIONS ARE ALSO VALID FOR E50201 AND E50202

INSTRUCTIONS FOR FIXING ET.074813 ONTO THE SASH FRAME

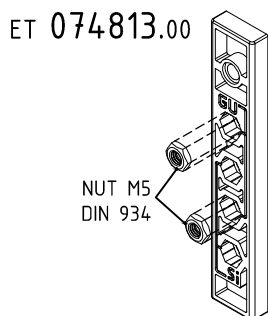

IN ORDER TO FIX THE GEAR OF G.U. L&S
HARDWARE ONTO THE SASH FRAME, FIX 2
M5 NUTS (DIN 934) ONTO ARTICLE
ET.074813.00

ATTENTION: THE FIXING HOLE OF ET.074813.00 MUST BE
ORIENTED TO THE UPPER SIDE OF THE HEIGHT OF THE
SASH FRAME.

FOR E50 EVO

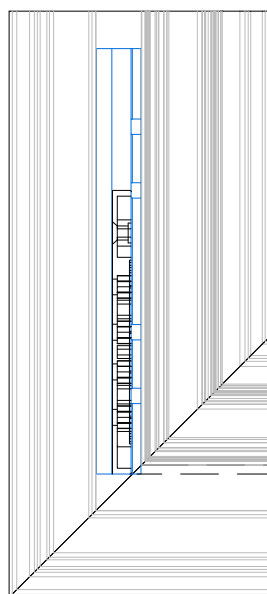

** THE BOTTOM SIDE OF ET.074813.00 MUST
BE POSITIONED 3mm FROM THE BOTTOM OF THE
POLYAMIDE OF SASH PROFILE

ET.074813.00 IS FIXED ONTO THE SASH FRAME USING
ONE (1) SHEET METAL SCREW 4.8x30mm DIN 7982

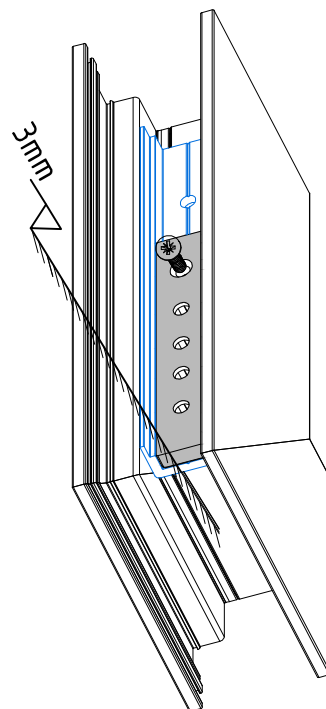
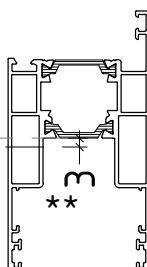

INSTRUCTIONS FOR FIXING ET.074812.00 ONTO THE GEAR OF THE HARDWARE

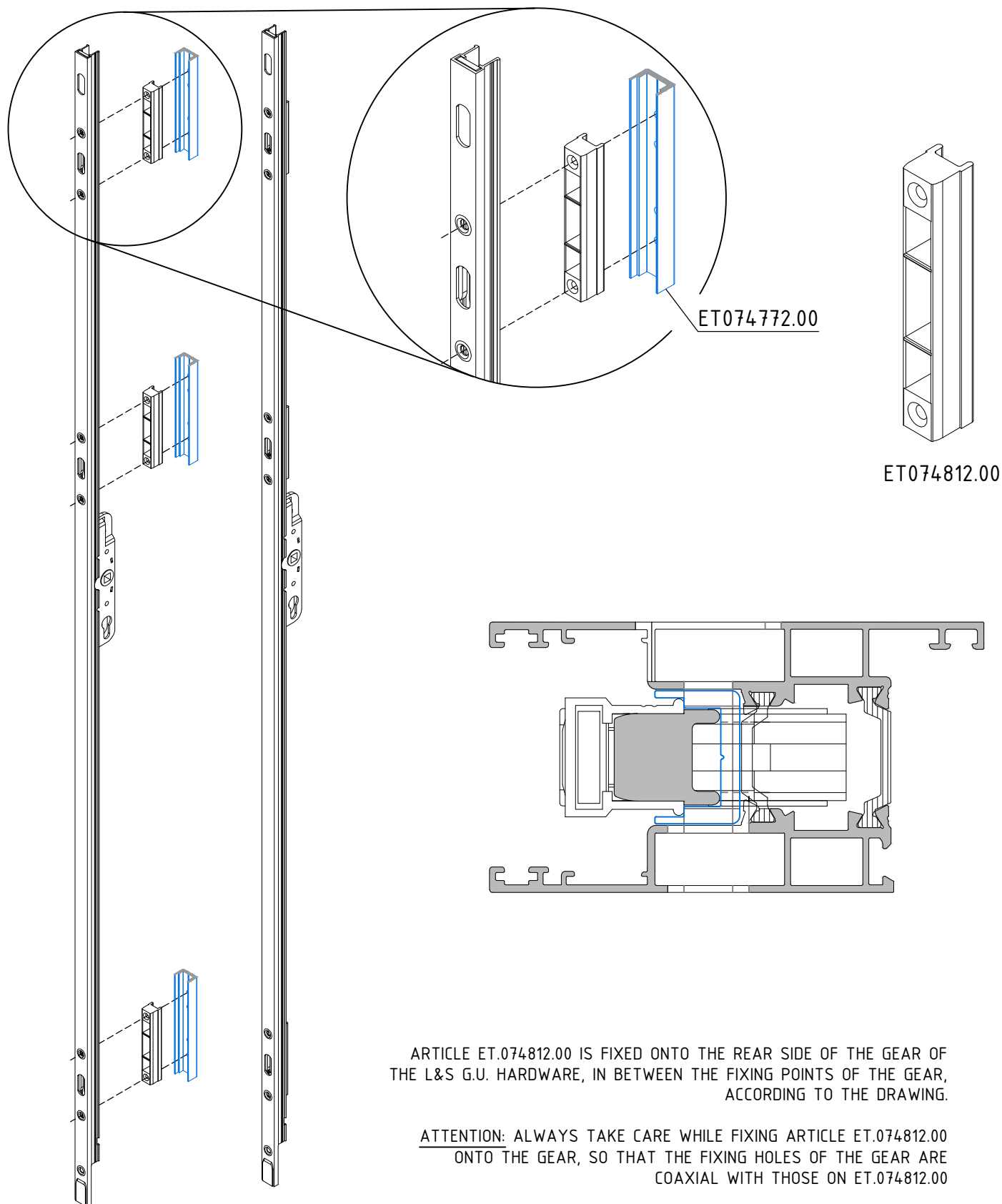

INSTRUCTIONS FOR FIXING G.U. L&S HARDWARE ONTO THE SASH FRAME

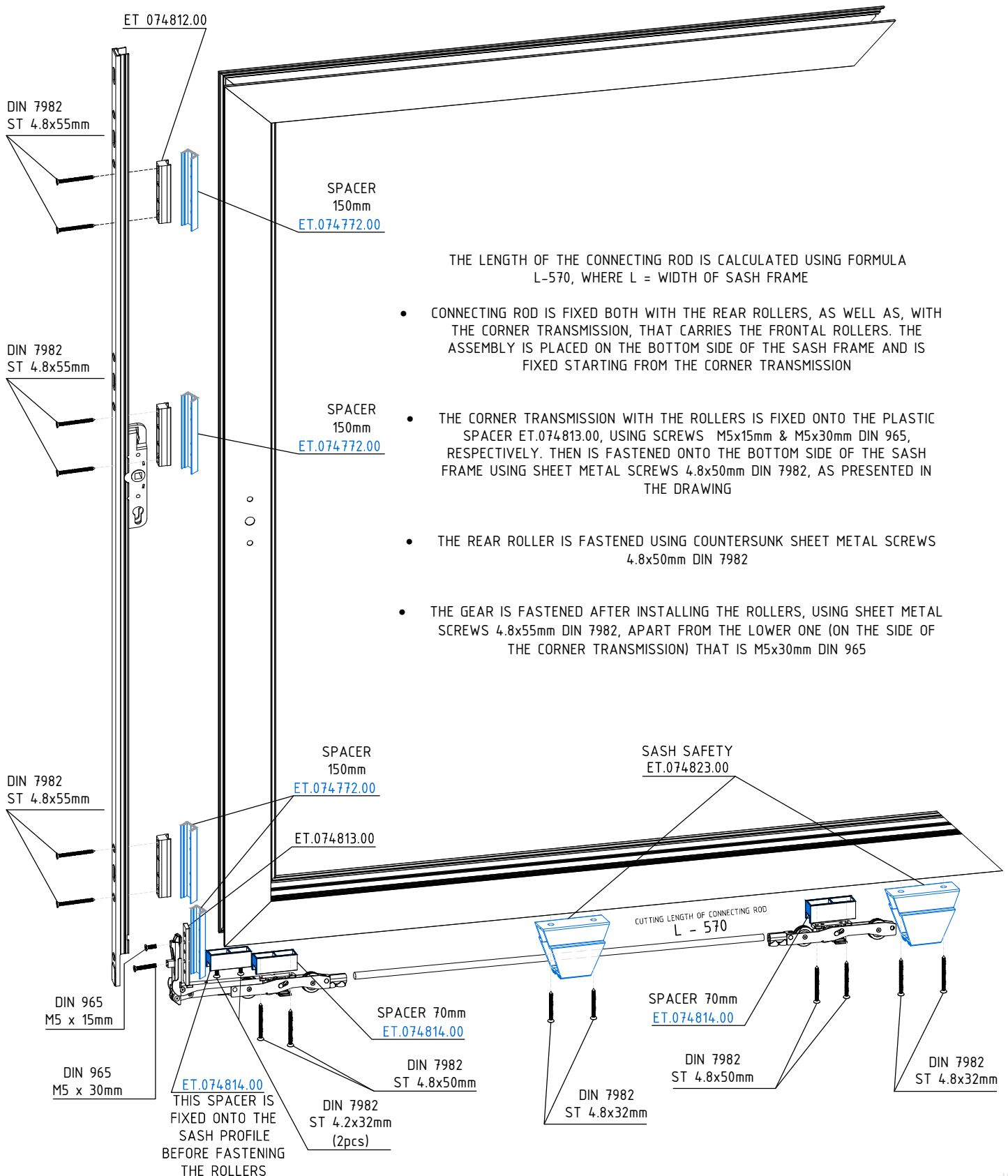

code/description	package/pcs	colour
ET 130113.00		

Bottom EPDM sash gasket
for E50 - FLAT RAIL

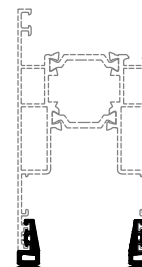
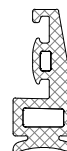

ET 130048.00		
--------------	--	--

Gasket for sash profile

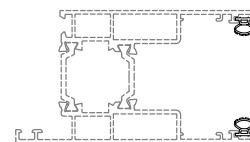

ET 074814.00		●
--------------	--	---

Plastic spacer 70mm, for
rollers GU937

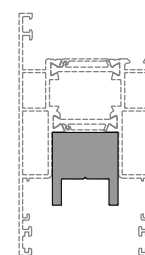
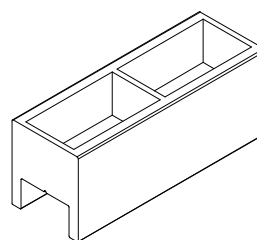

ET 074772.00		●
--------------	--	---

Plastic spacer 150mm, for
gear GU937

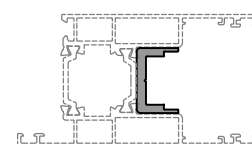
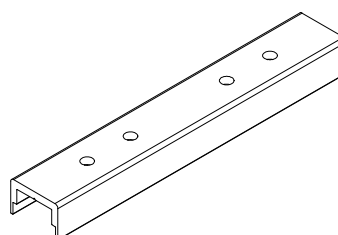

code/description	package/pcs	colour
ET 074766.00		●

Plastic stopper 80mm

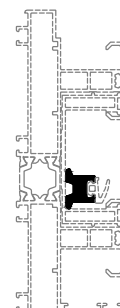

ET 130772.00		
--------------	--	--

EPDM seal gasket for stopper

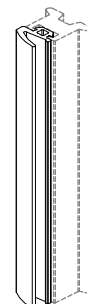

ET 240847.00		
--------------	--	--

Central sealing block for flat rail, lift & slide

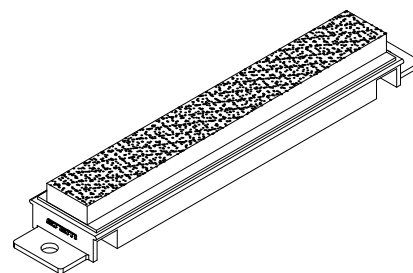

ET 240818.00		
--------------	--	--

Foam part (41 mm) for sealing sash - interlock on top of E50

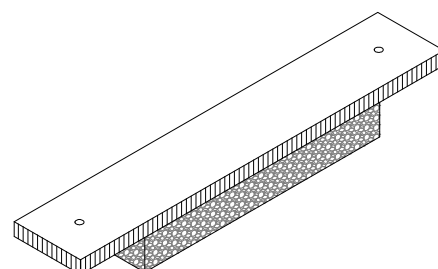

code/description	package/pcs	colour
ET 076678.00		

EPDM side flange for double
& triple flat rails

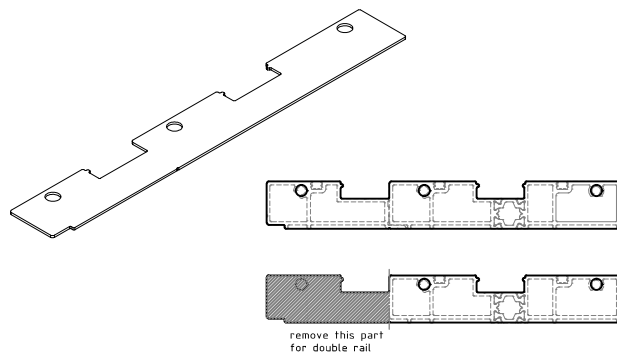

ET 240848.00		●
--------------	--	---

Set of foam inserts for
cavities of flat rail E50170

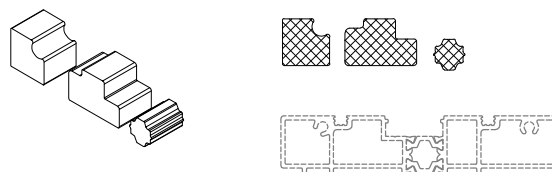

ET 074742.00		
--------------	--	--

Plastic plug for upper side
of interlock (for lift &
slide)

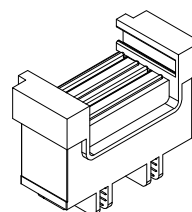

ET 074821.00		
--------------	--	--

Plastic plug with foam for
bottom side of interlock
(ONLY for flat rail - lift &
slide)

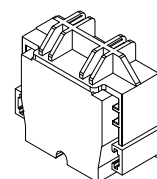

code/description	package/pcs	colour
ET 074750.00		

Pair of plastic plugs for interlock

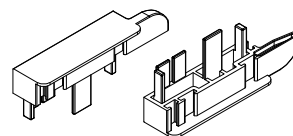

ET 074823.00		
--------------	--	--

Sash safety for flat rail

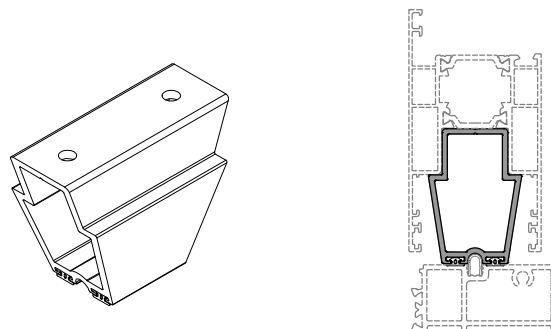

ET 074305.00		
--------------	--	--

Drainage cap with flap

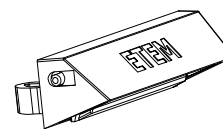

ET 130773.00		●
--------------	--	---

EPDM seal gasket for adjoining profile E50500

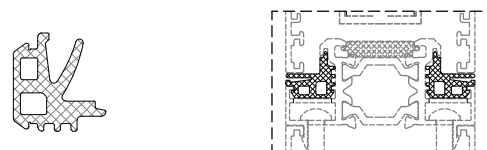

code/description	package/pcs	colour
ET 074746.00		

Plastic plug for adjoining profile E50500 (upper side)

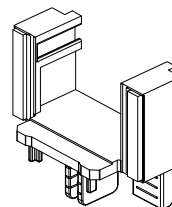

ET 074829.00		
--------------	--	--

Plastic plug for adjoining profile E50500 (bottom side)
ONLY for flat rail

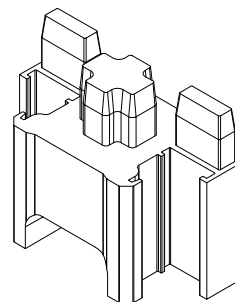

ET 240854.00		
--------------	--	--

Foam for plastic plug
ET074829.00
ONLY for flat rail

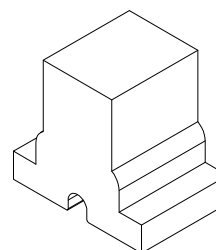

--	--	--