

E85 Curtain Wall System

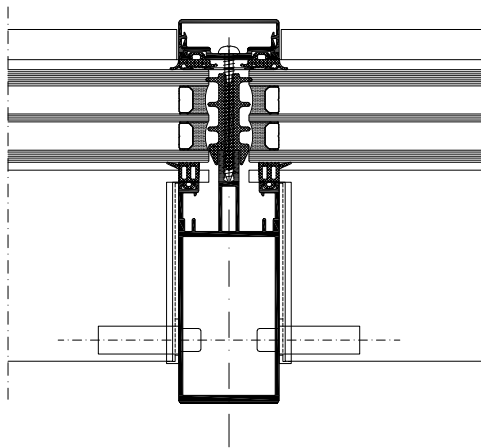

Designed for stick construction with very thin face width of 50 mm sightlines. It is a thermally insulating aluminium façade with mullion-transom construction. The variety of solutions and the expansion options characterise the flexibility of the façade series.



Technical features

- Straight line profiles
- Glazing infill range for façade: Double and Triple glazing options
- Glazing infill range for opening: Double and Triple glazing options
- Max concealed vent weight for opening: 200 kg
- Roof window with smoke exhaust
- Exterior finishes - cover cap or silicone gap

Hardware accessories

- Integration of sunshade
- EPDM gaskets
- Compatible with all ETEM aluminium systems

Surface treatment options

- RAL colours
- ETEM colours
- Anodising
- Wood effects
- Quality Standards:
 - QUALICOAT
 - QUALANOD
 - QUALIDECO

Production certificates

- EN ISO 9001
- EN ISO 14001
- OHSAS 18001

Performance: façade

| | |
|--|-------------------------------------|
| Air permeability: | Class AE |
| Watertightness [Static]: | Class R7 |
| Watertightness [Dynamic]: | 200 Pa / 600 Pa |
| Resistance to Wind Load [Design Load]: | up to ± 1.6 kN/m² |
| Resistance to Wind Load [Safety Load]: | up to ± 2.4 kN/m² |
| Impact Resistance: | up to Classes I5 / E5 |

Performance: general

| | |
|----------------------------------|------------------------------------|
| Thermal Transmittance [U_f]: | from 1.6 W/(m²K) |
| Sound insulation: | up to 47dB |
| Burglar Resistance: | up to Class WK4 |
| Bullet Resistance: | up to Class FB4 NS |
| Moisture Penetration: | $I_{req} = 5,2\%$ |
| Adhesion Test [ETAG 002-1]: | PASS |
| Ageing Behavior [EN 1279-2]: | PASS |

Typologies

- Fully capped (wide range of facecaps options)
- Horizontal cap with flush
- Vertical cap with flush
- Four-sided structural silicone glazed
- Vertical, slanting, polygonal level curtain walls, pyramids and cupolas

