

# TECHNICAL BULLETIN

N 84 - 2019. 03

## Automatic door sealing systems ETEM

### content:

- DETAILS
- MACHINING

- ACCESSORIES

**ETEM**

TYPE 1: Mounting door sealing system for E75FP double-sash with four side E75211 with brush holder

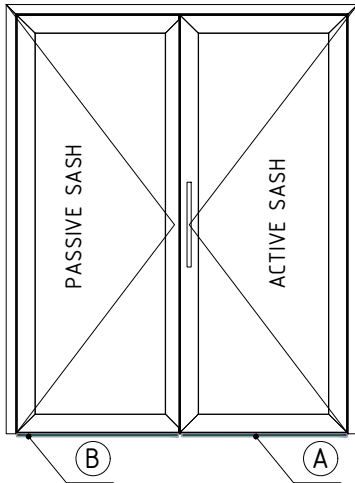

Ⓐ Sealing system for active sash. Install cap A<sub>1</sub>

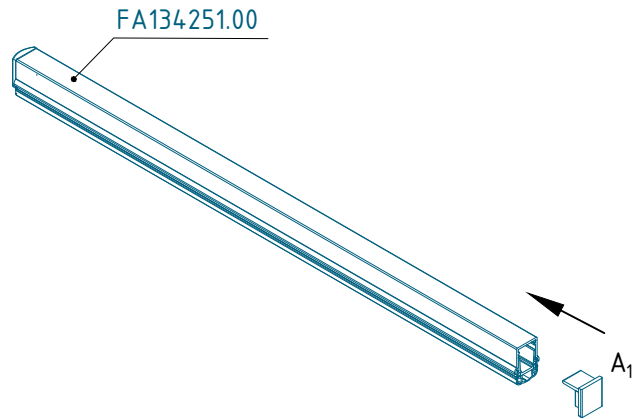

Ⓑ Sealing system for passive sash. Install cap B<sub>1</sub>

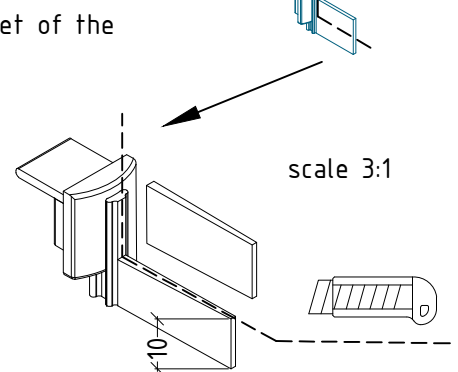
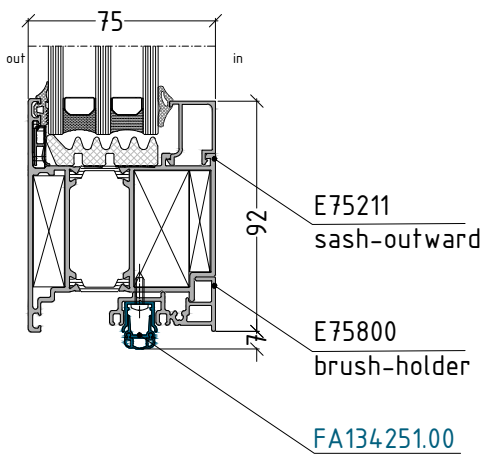
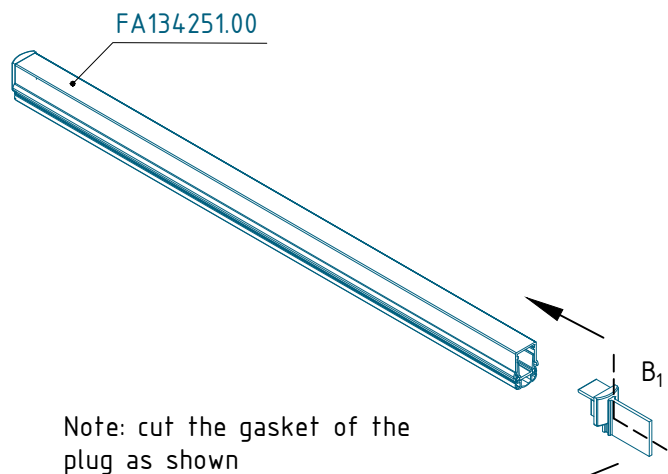

Caps in the package for door sealing system

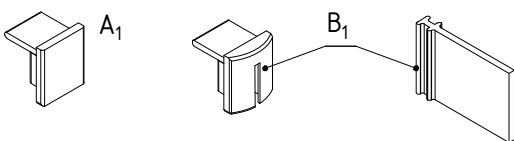

not to scale

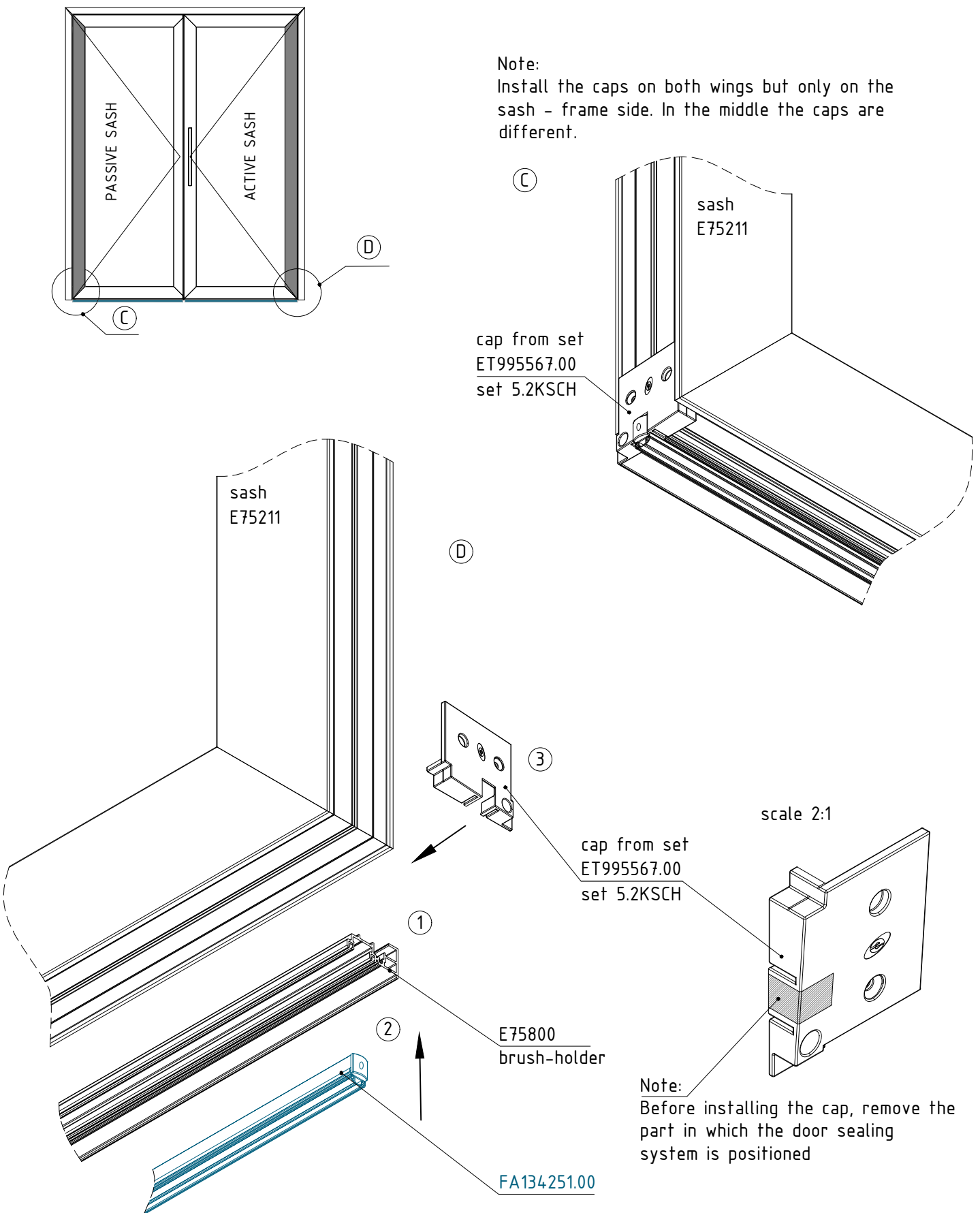

not to scale

# flat door system with thermal break

# example with E75

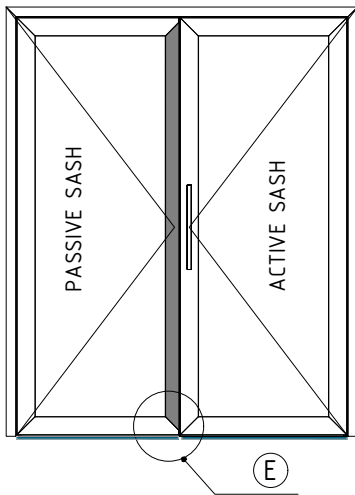

Note:  
Install the cap on the vertical profile of the passive sash from the handle side

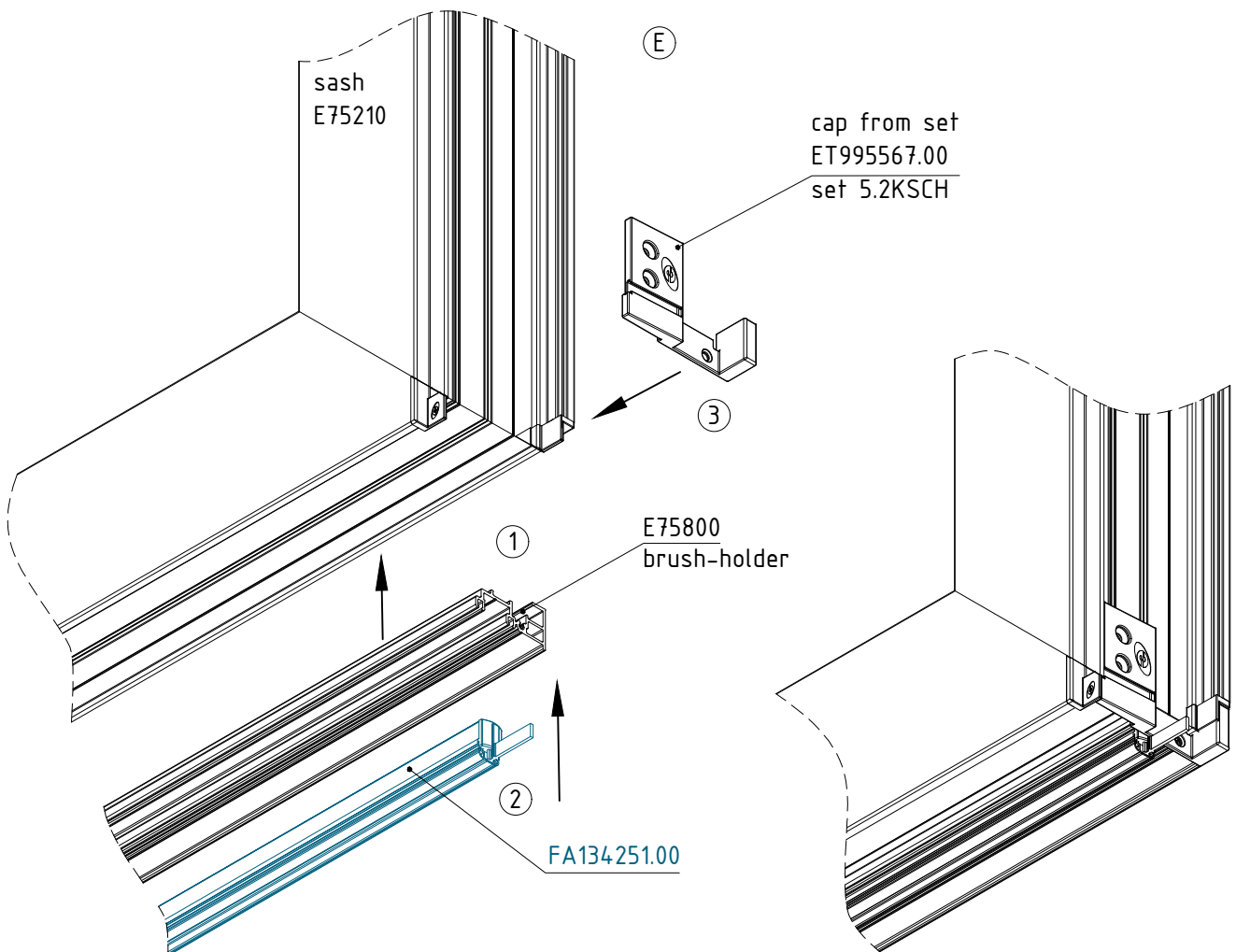
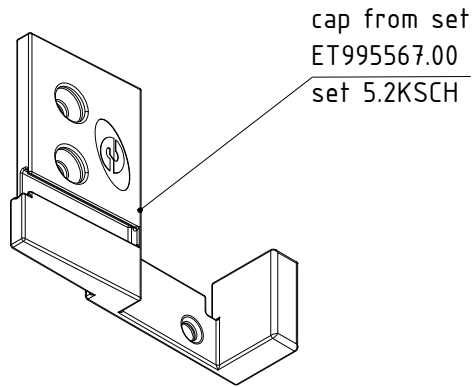

not to scale

TYPE 2: Mounting door sealing system for E75 double-sash flat door with kick plate

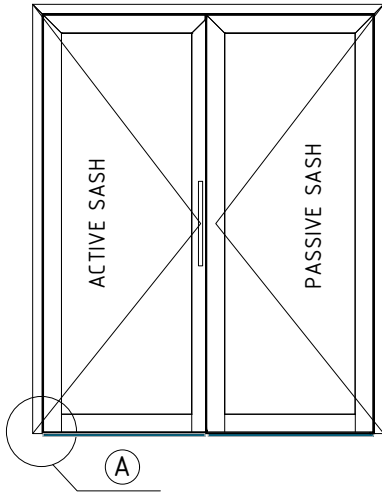

Sealing system for active sash.  
Install cap A<sub>1</sub>

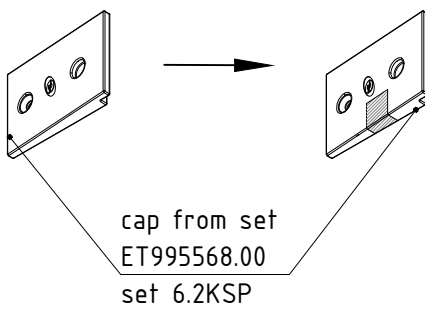
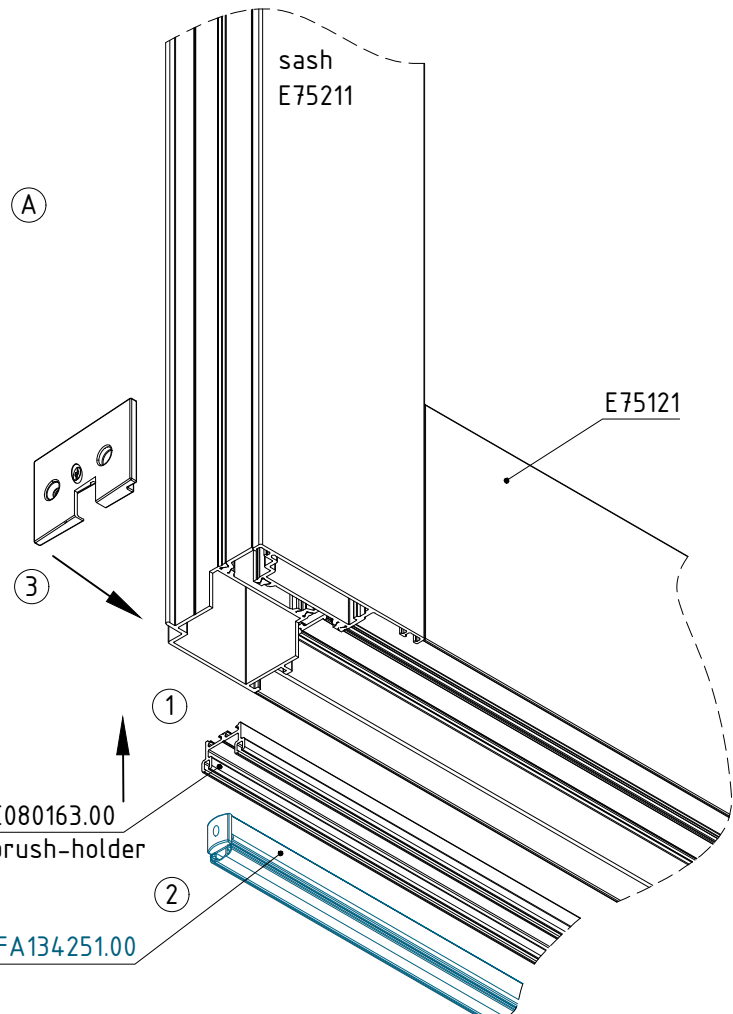
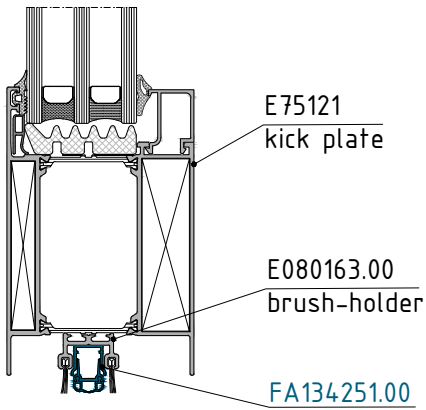
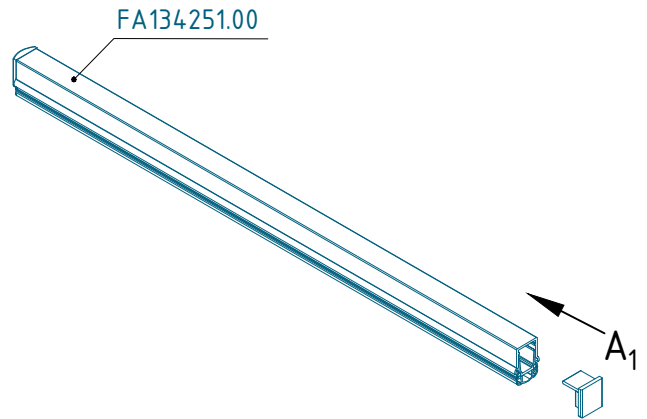

Note:  
Before installing the cap, remove the part in which the door sealing system is positioned

not to scale

M75D-56

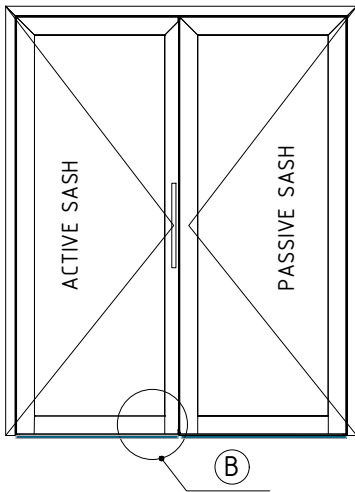

Note:  
Install the cap on the vertical profile of the active wing  
on the handle side

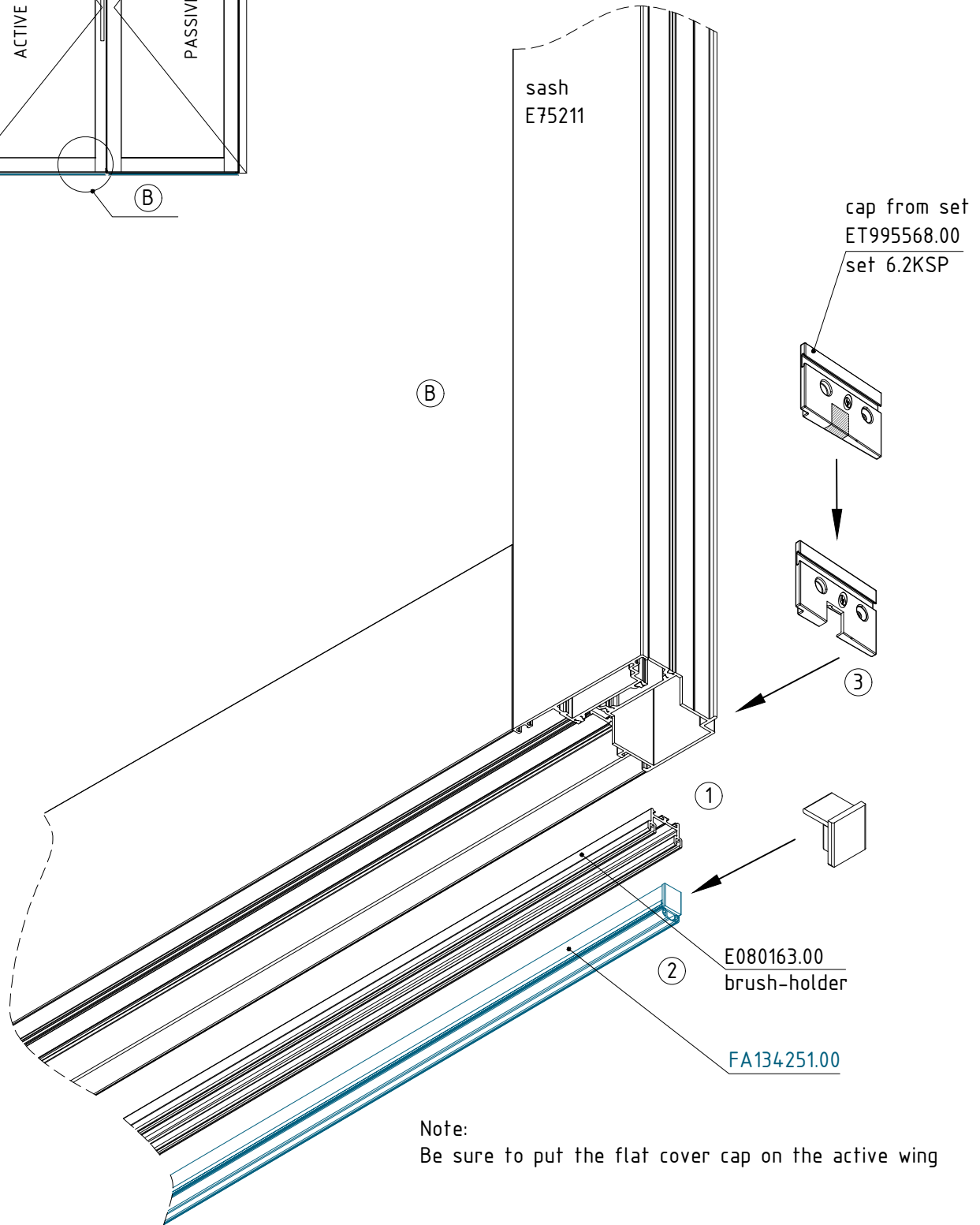

Note:  
Be sure to put the flat cover cap on the active wing

not to scale

Machining for door sealing system for E75 double-sash flat door with kick plate

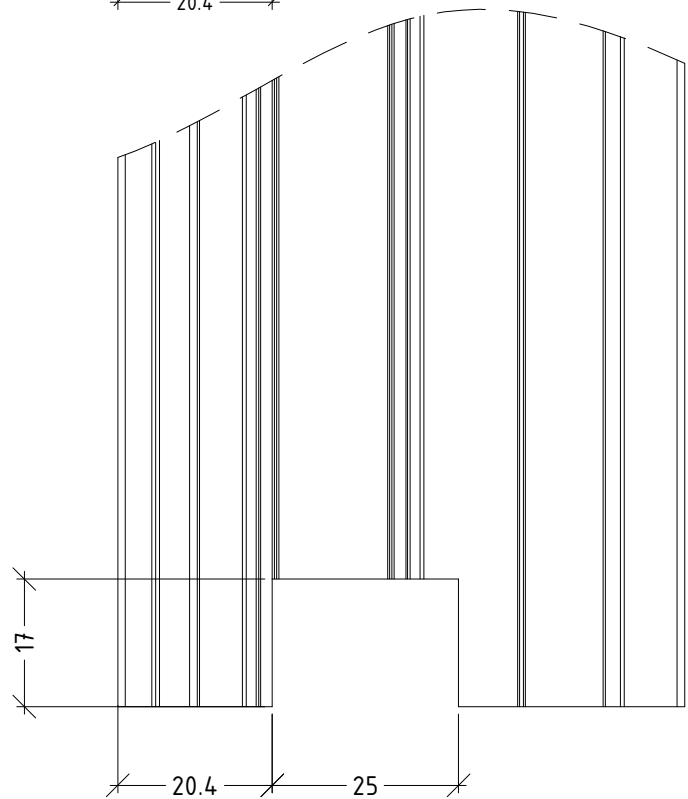
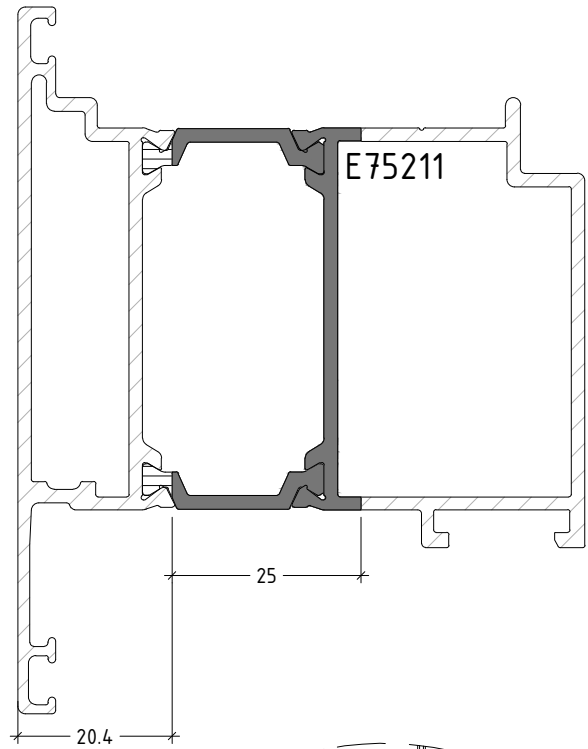
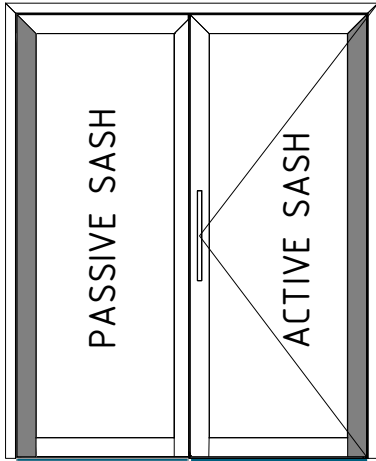

not to scale

Machining for door sealing system for E75 double-sash flat door with kick plate

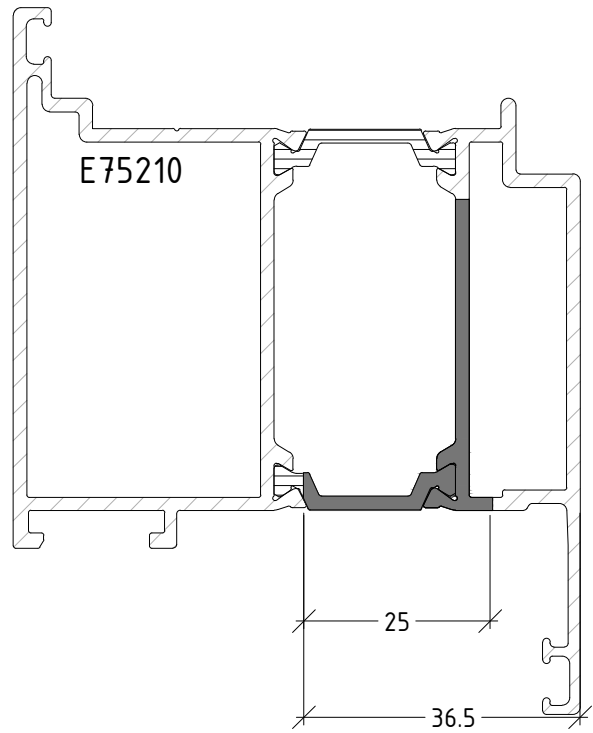
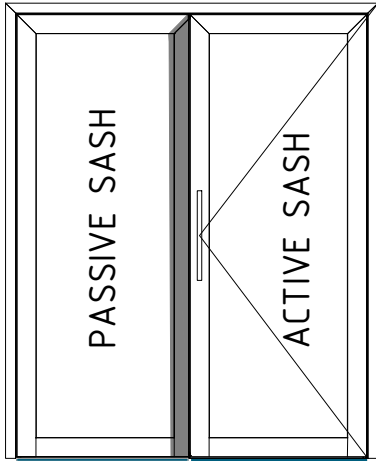

Note:  
Cutting the other wall of the aluminium profile is not obligatory.

scale: 1:2

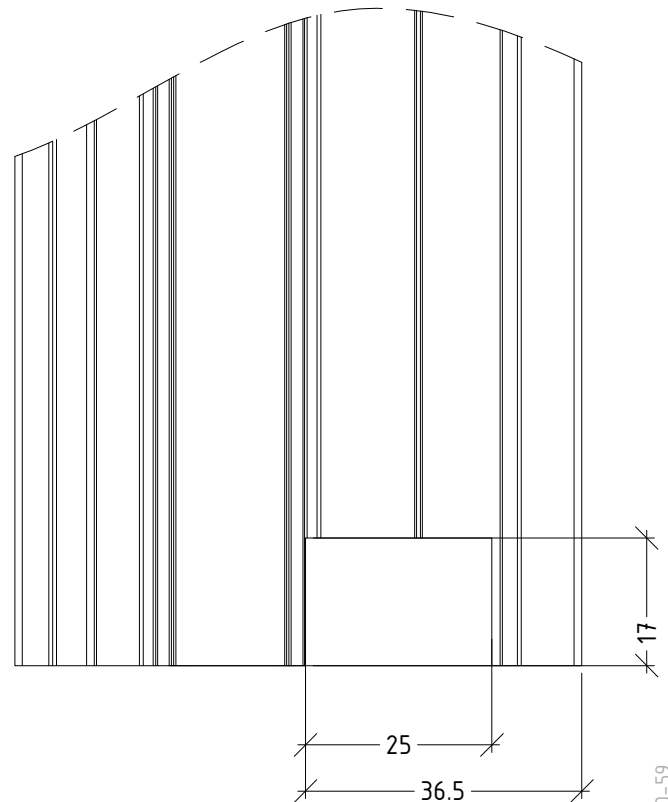
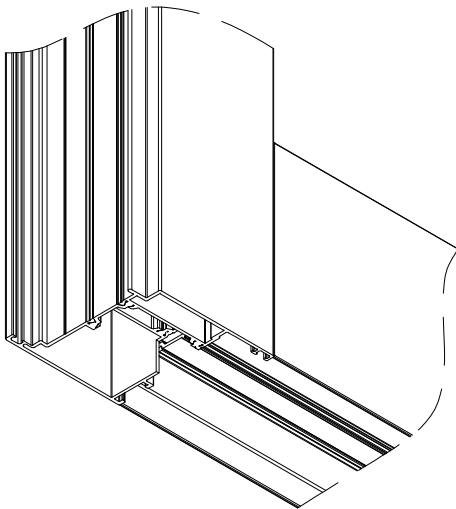

not to scale

M75D-59



TYPE 3: Mounting door sealing system for E75 single-sash flat door with kick plate

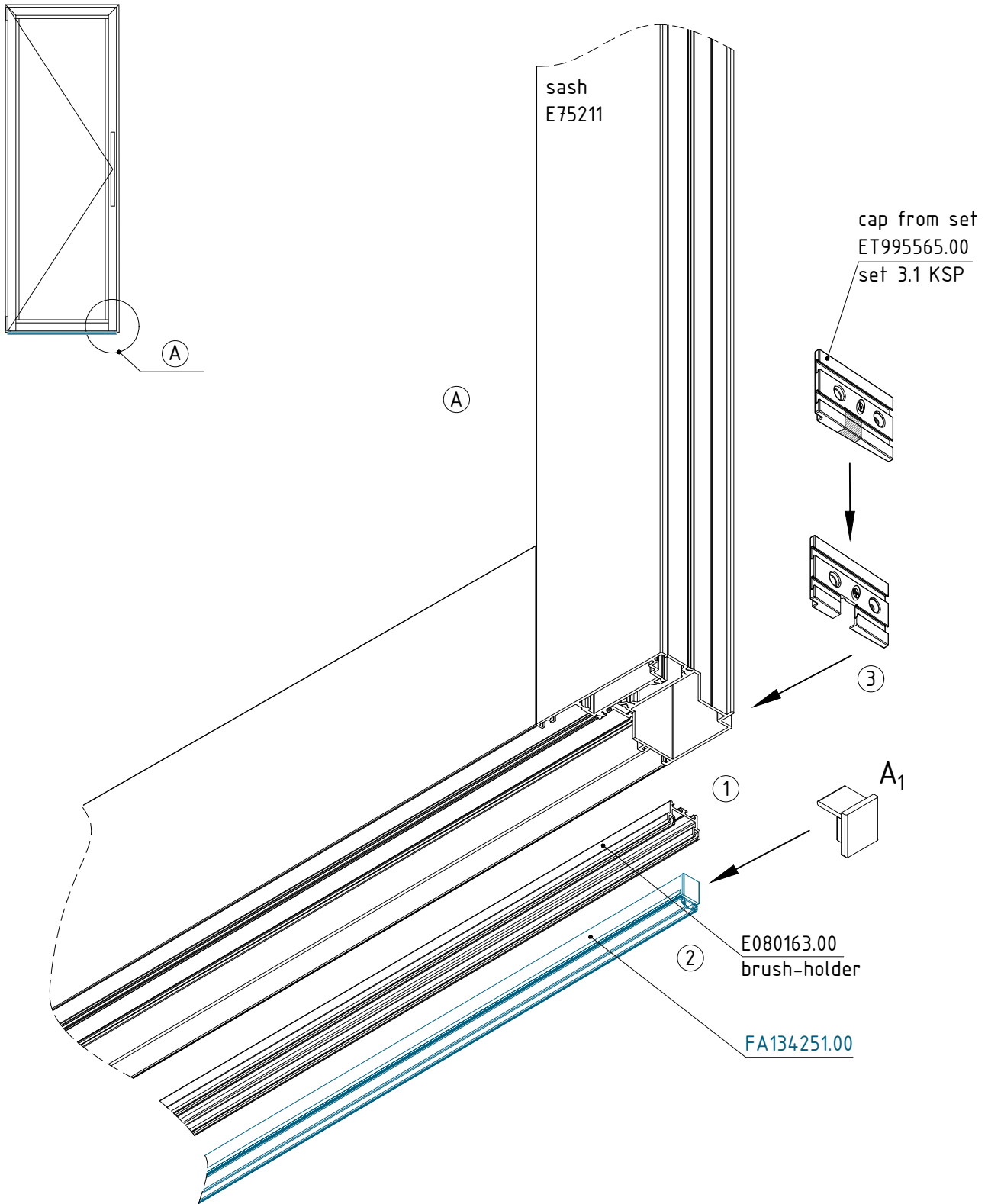

not to scale

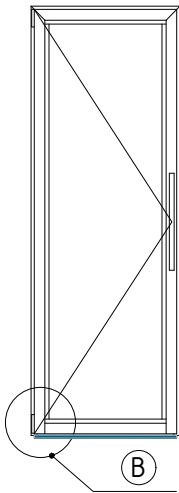

Sealing system for active sash.

Install cap A<sub>1</sub>

FA134251.00

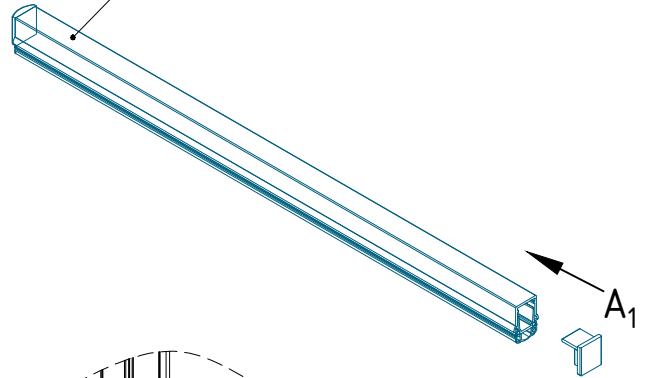

Note:

Before installing the cap, remove the part in which the door sealing system is positioned

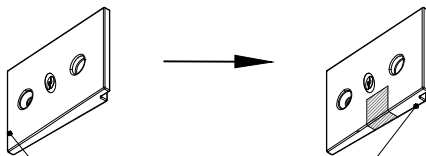

cap from set  
ET995565.00  
set 3.1 KSP

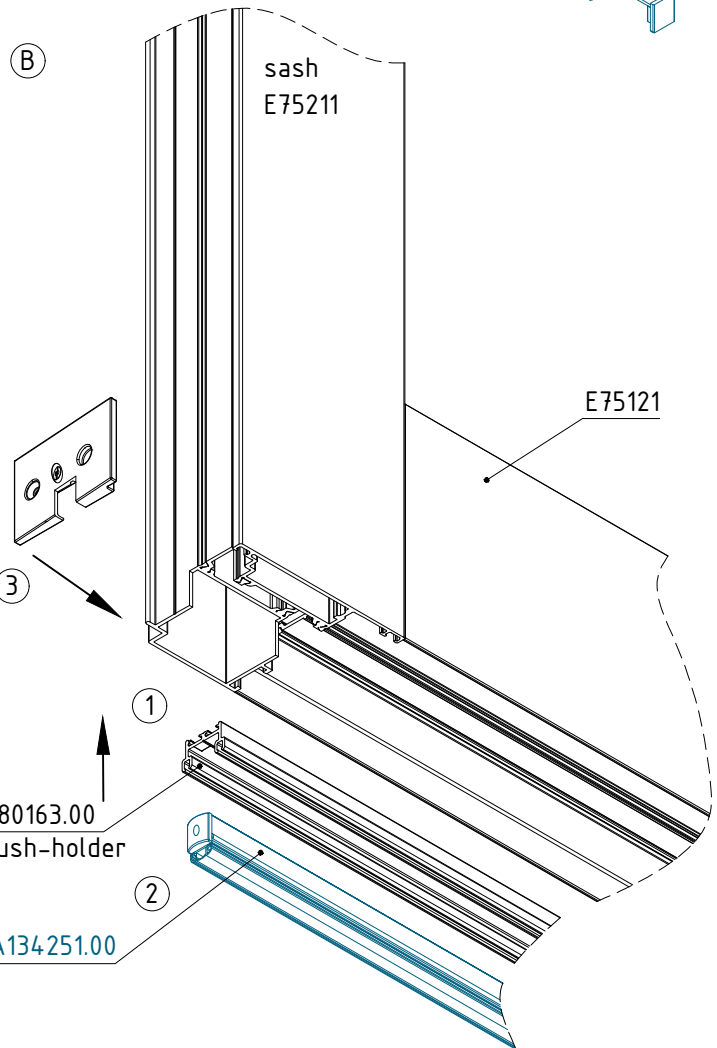

not to scale

TYPE 4: Mounting door sealing system for E75FP single-sash four side E45211 with brush holder

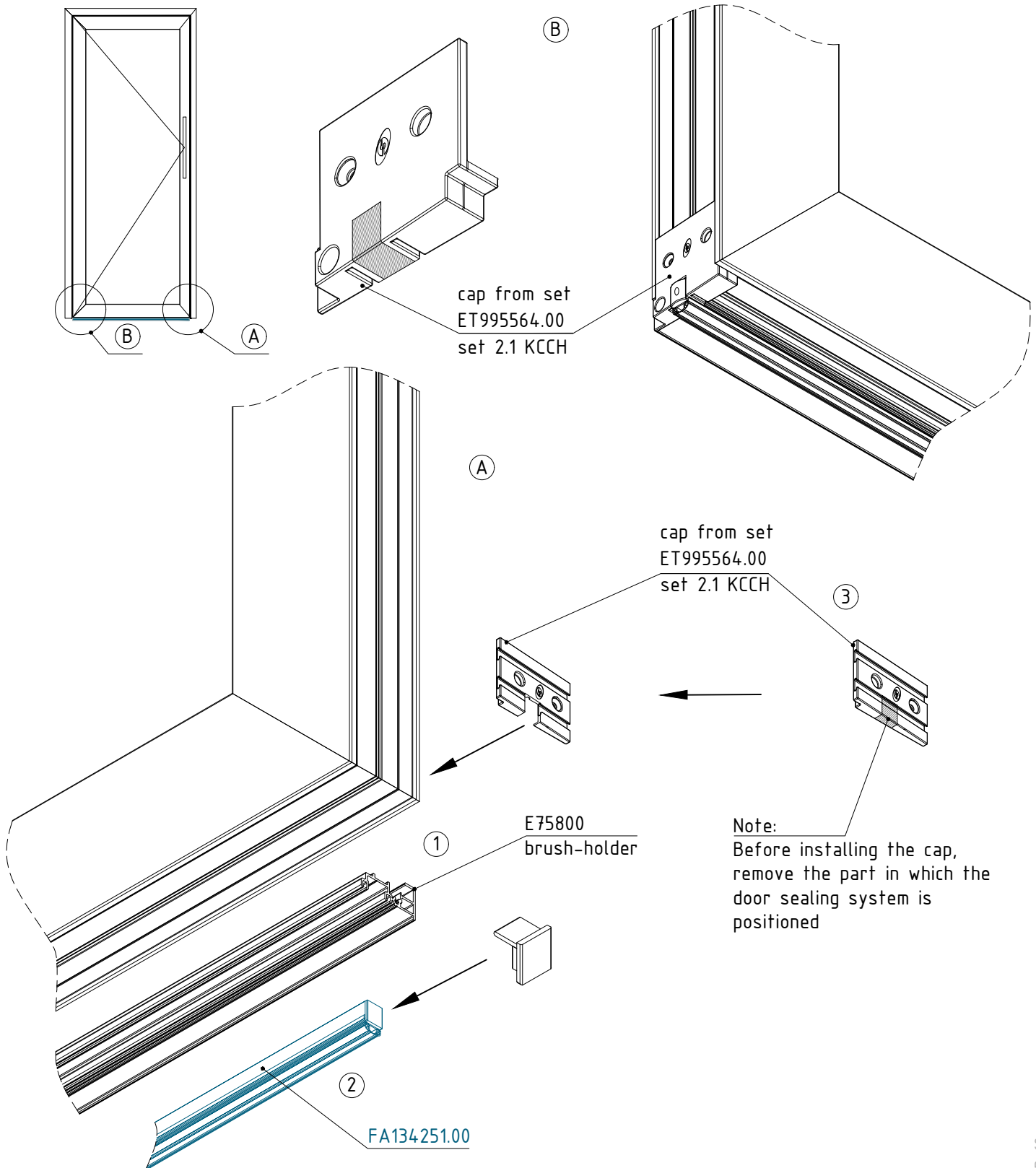

not to scale

# flat door system with thermal break

# E75

code/description	package/pcs	colour
ET <b>995563.00</b>	1	●

SET 1.1KSTP

set pl. plugs for  
single-sash flat door with  
thermal threshold

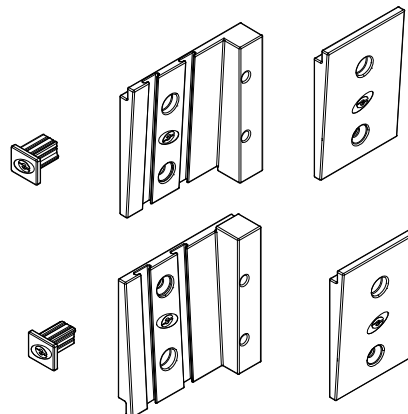

ET <b>995564.00</b>	1	●
---------------------	---	---

SET 2.1KCCH

set pl. plugs for  
single-sash flat door with  
brush holder

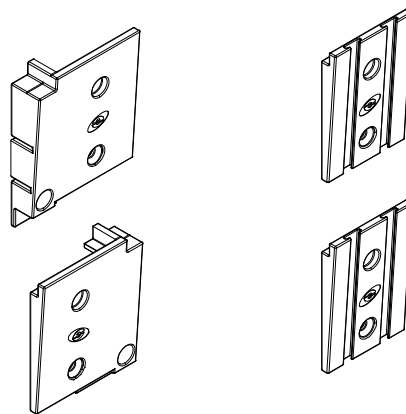

ET <b>995565.00</b>	1	●
---------------------	---	---

SET 3.1KSP

set pl. plugs for  
single-sash flat door with  
kick-plate

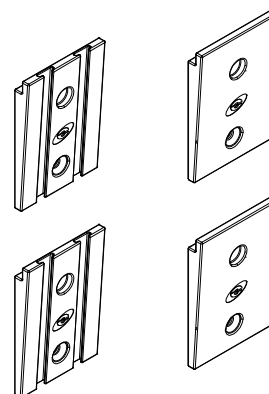

ET <b>995566.00</b>	1	●
---------------------	---	---

SET 4.2KSTP

set pl. plugs for  
double-sash flat door with  
thermal threshold

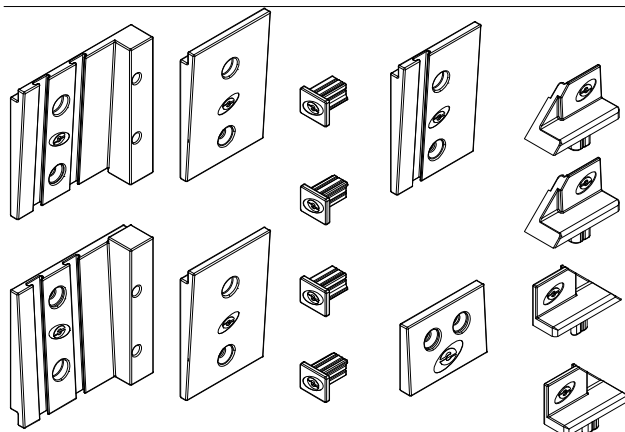

# flat door system with thermal break

# E75

code/description	package/pcs	colour
ET <b>995567.00</b>	1	●

SET 5.2KSCH

set pl. plugs for  
double-sash flat door with  
brush holder

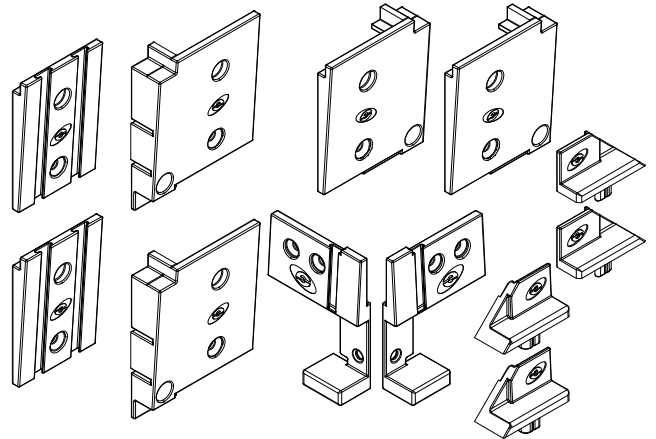

ET <b>995568.00</b>	1	●
---------------------	---	---

SET 6.2KSP

set pl. plugs for  
double-sash flat door with  
kick-plate

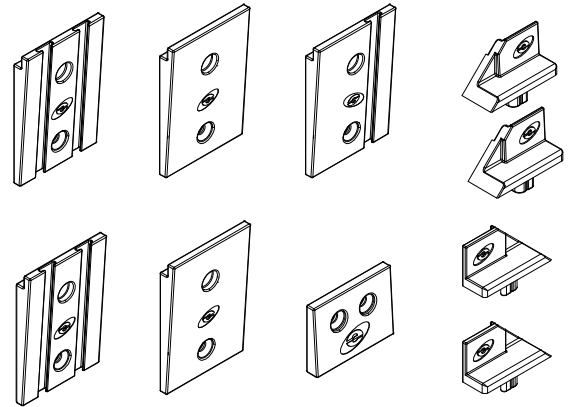

FA <b>134251.00</b>	1	
---------------------	---	--

Automatic door sealing  
systems - 1000 mm

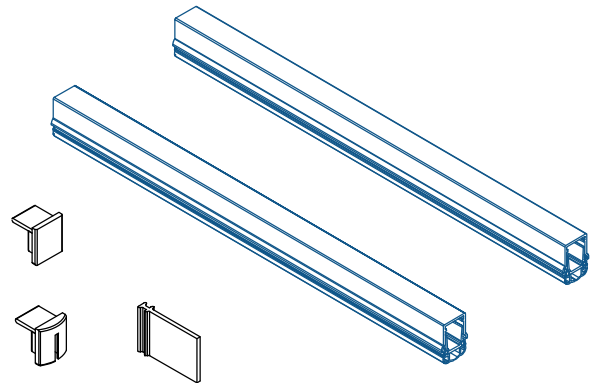

--	--	--