

# TECHNICAL BULLETIN

N 87 - 2019. 11

# E50 EVO

Solution for increased productivity

content:

- PROFILES
- PROFILES 1:1
- DETAILS
- ACCESSORIES

**ETEM**

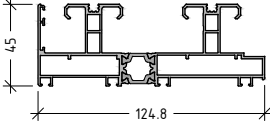
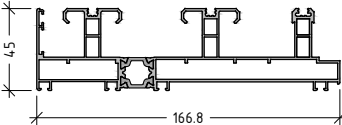
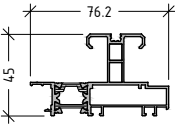
code	Profile	Weight Length Moment of inertia	code	Profile	Weight Length Moment of inertia
E50130 Double rail		2177 g/m L=6.01 m			
E50133 Triple rail (double glazing & fly screen)		2744 g/m L=6.01 m			
E50111 Additional single glazing rail		1216 g/m L=6.01 m			

E50130

Double rail

2177 g/m

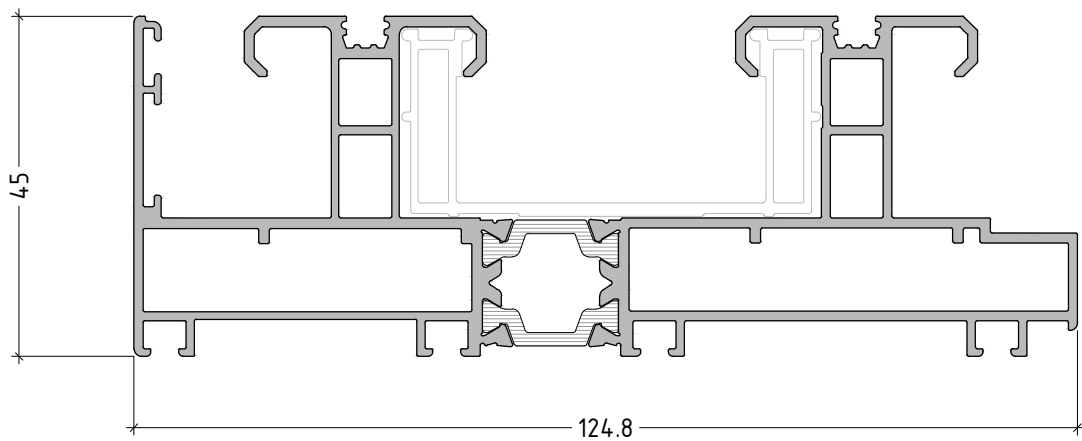

E50133

Triple rail  
(double glazing & fly  
screen)

2678 g/m

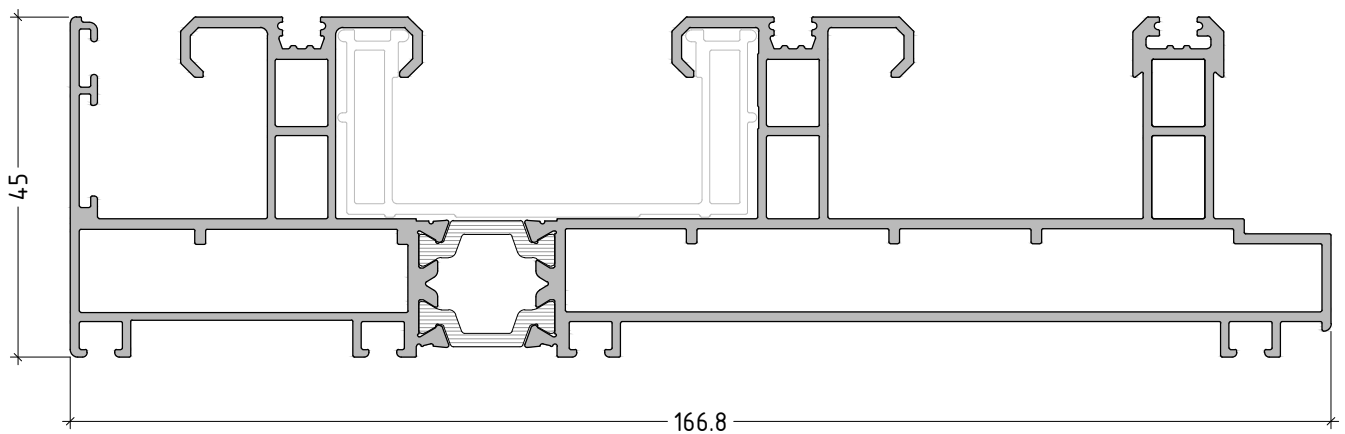

scale : 1:1

E50111

Additional single  
glazing rail

1216 gr/m

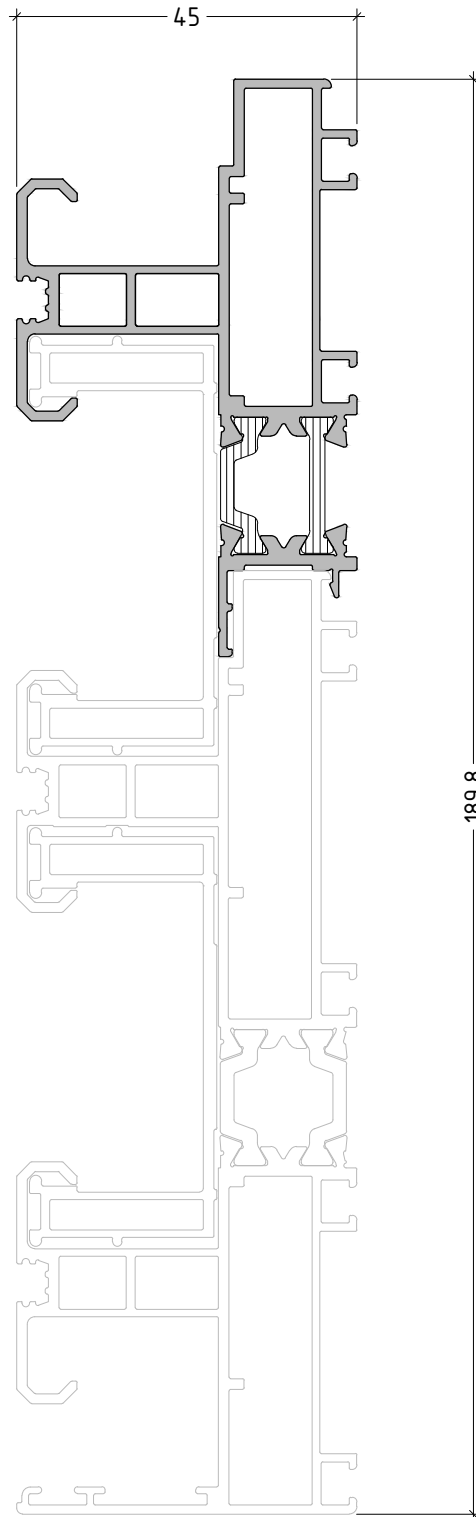

scale : 1:1

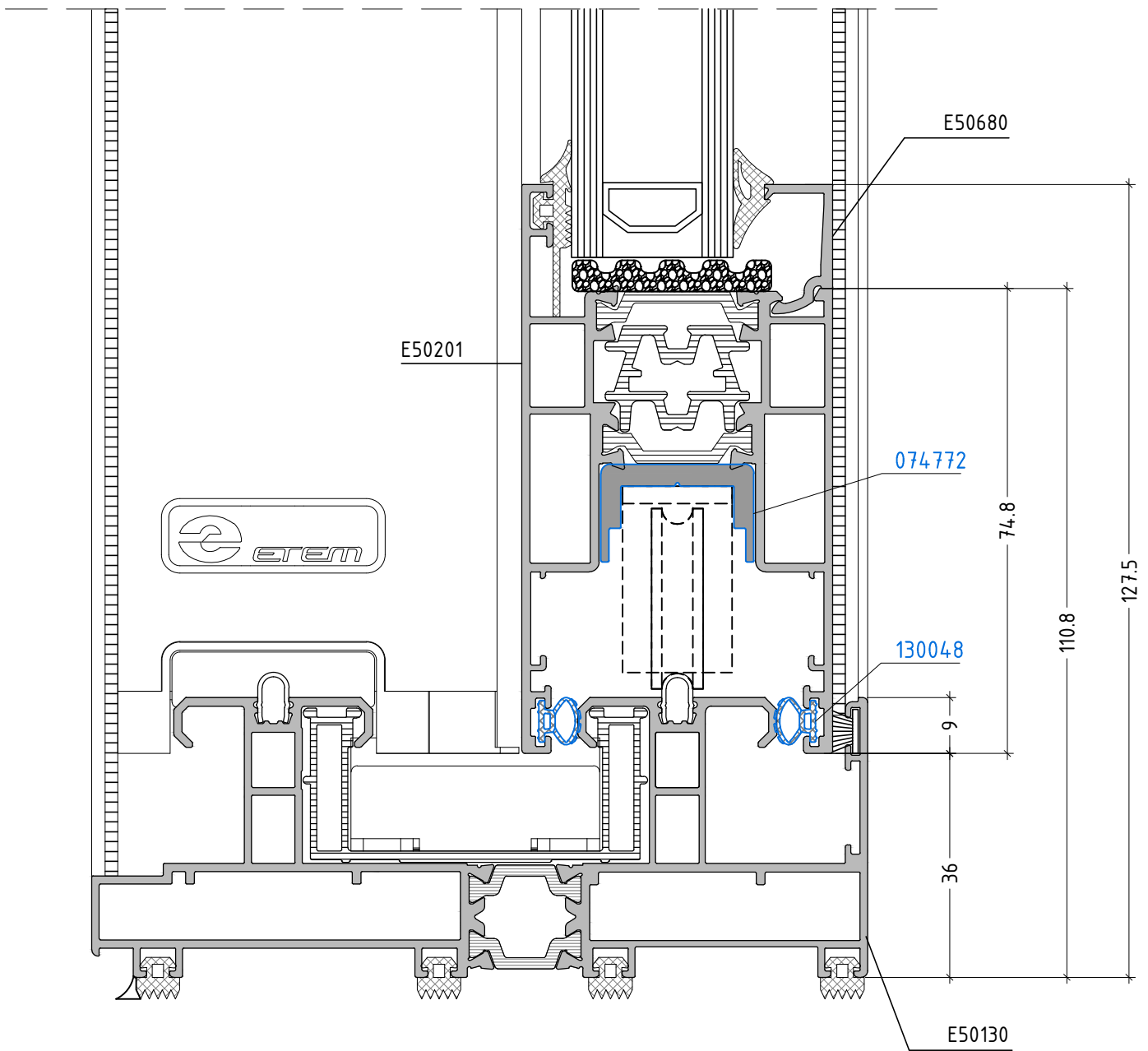
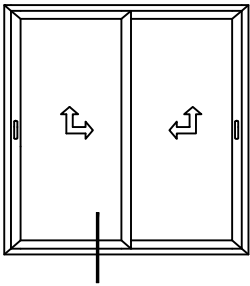

scale : 1:1

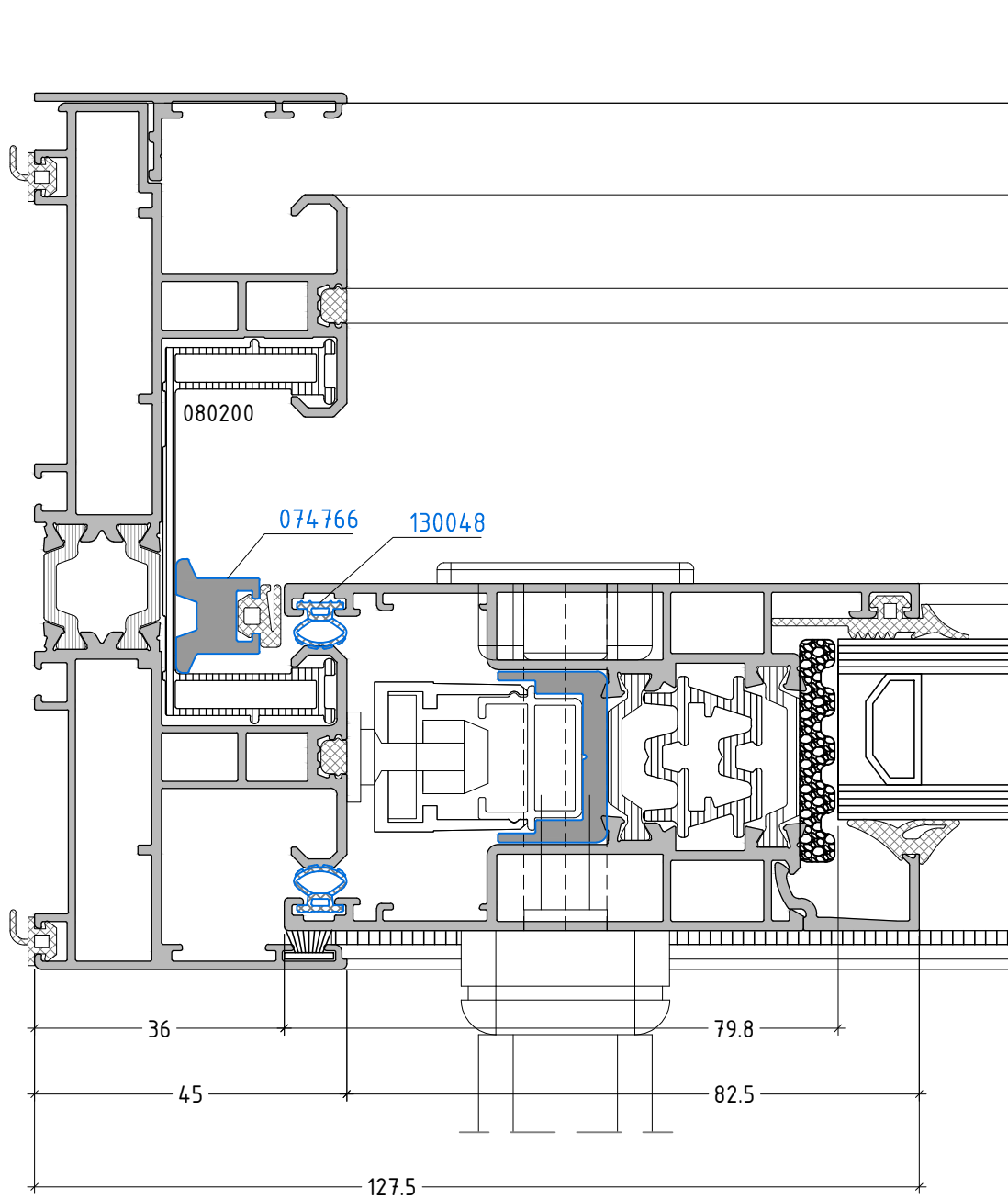
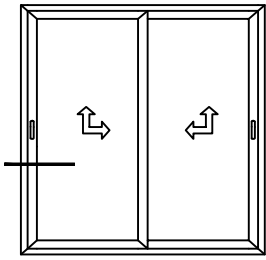

scale : 1:1

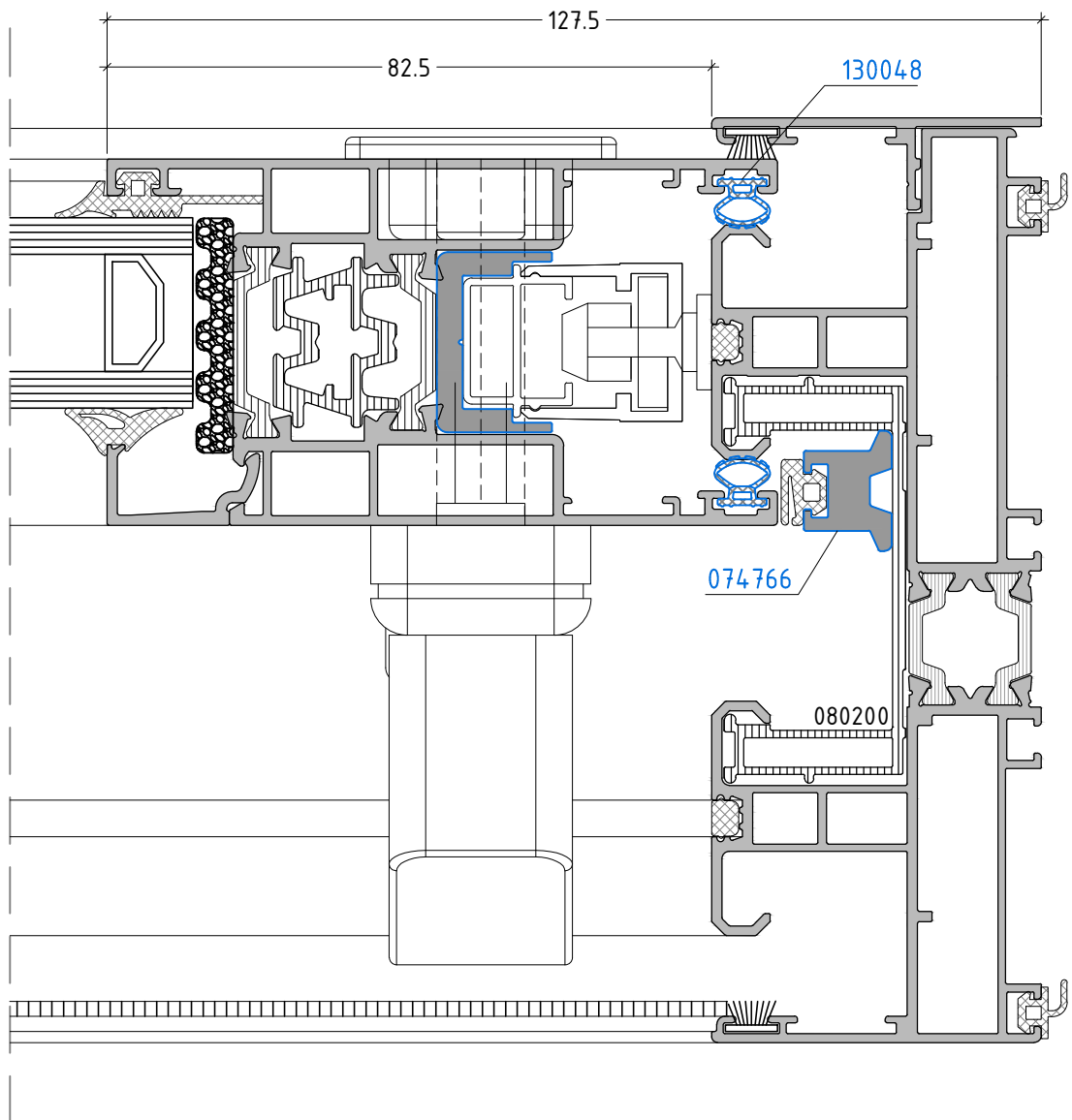
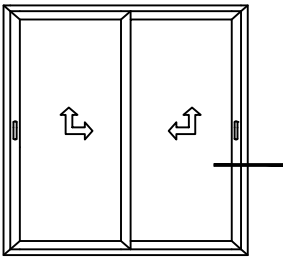

scale : 1:1

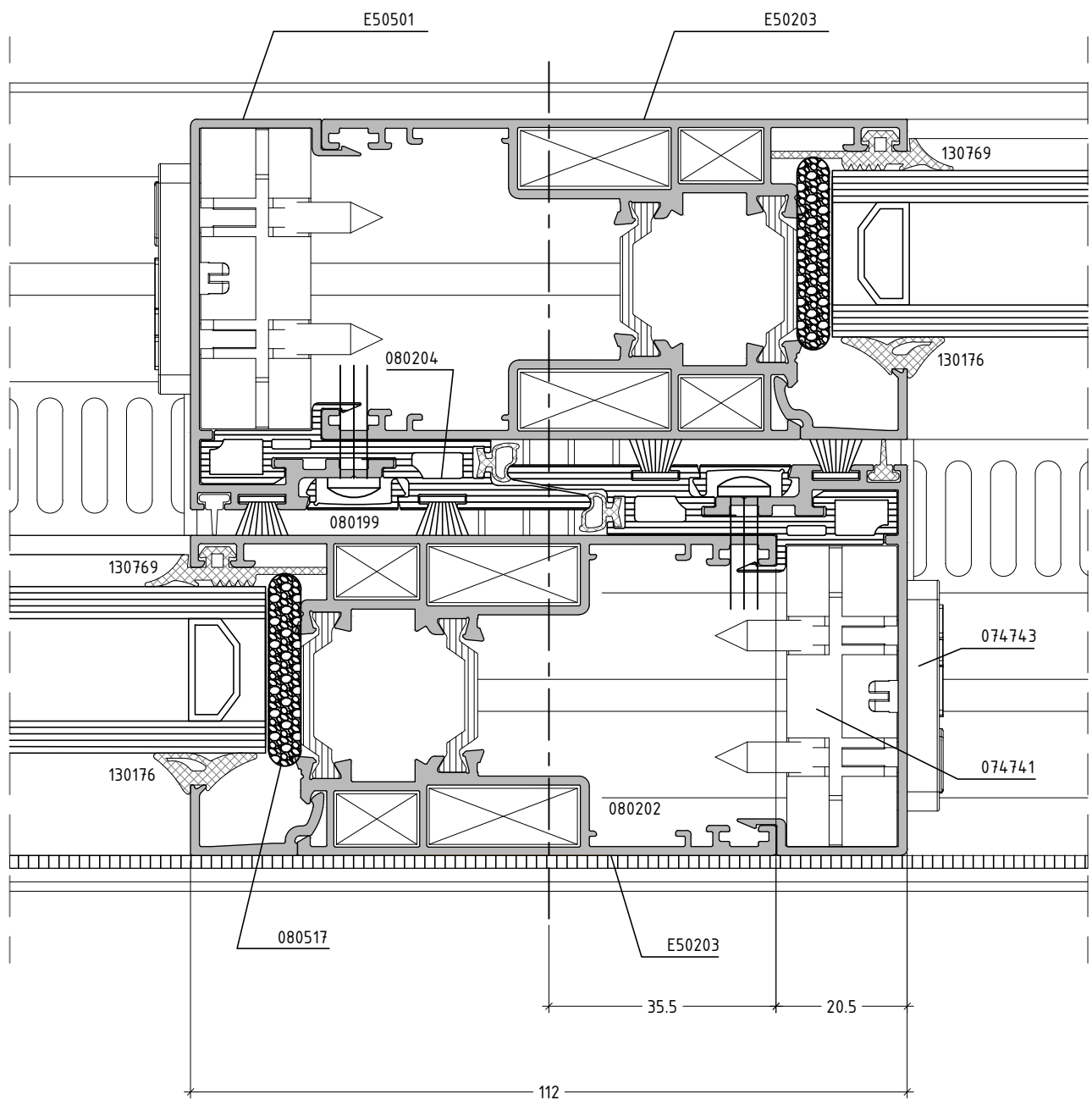
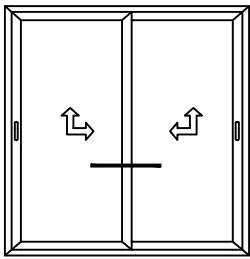



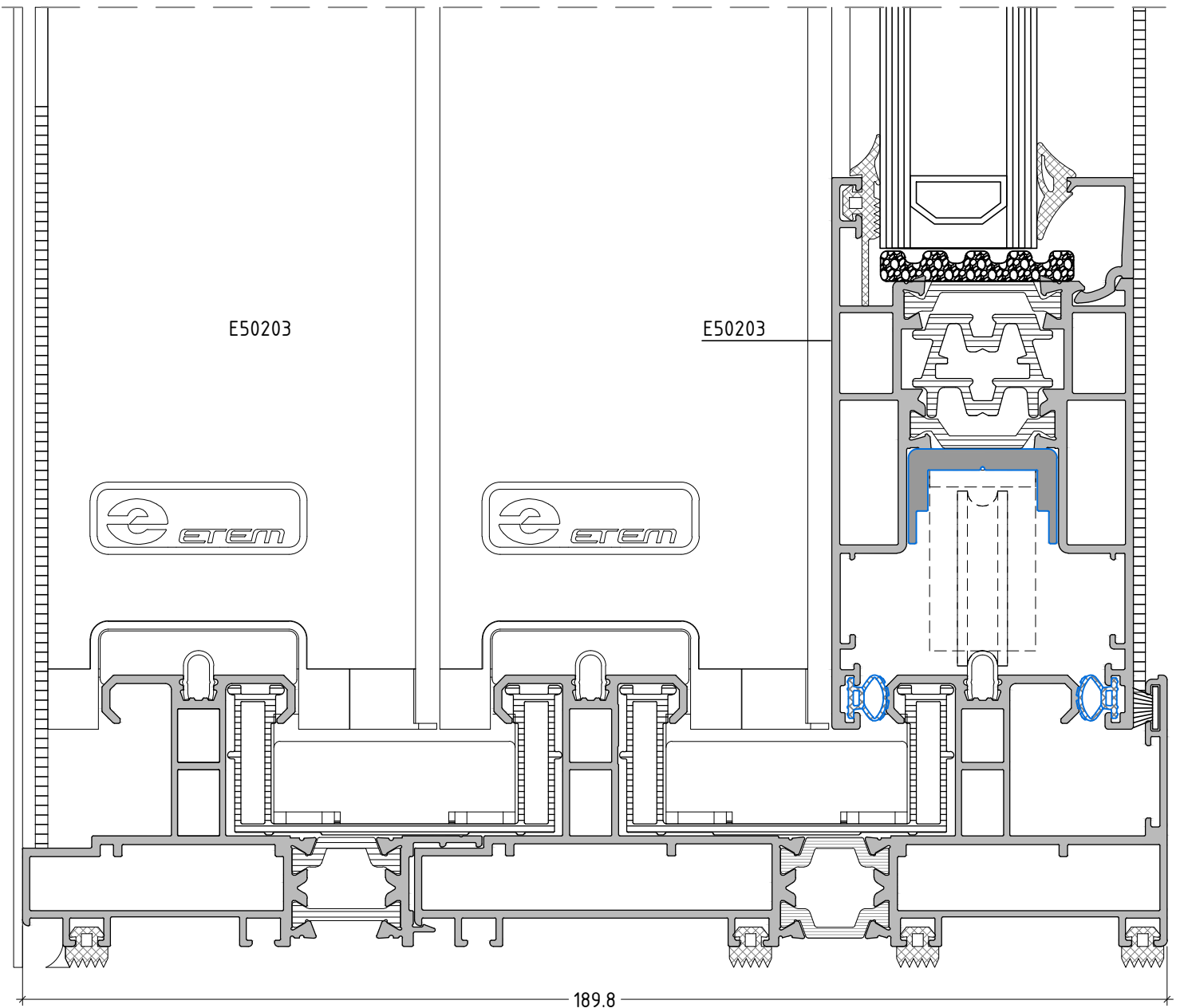
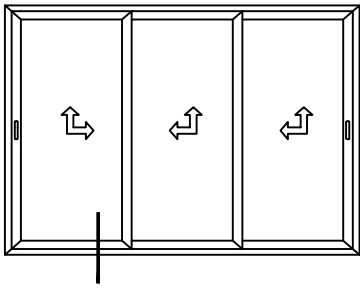

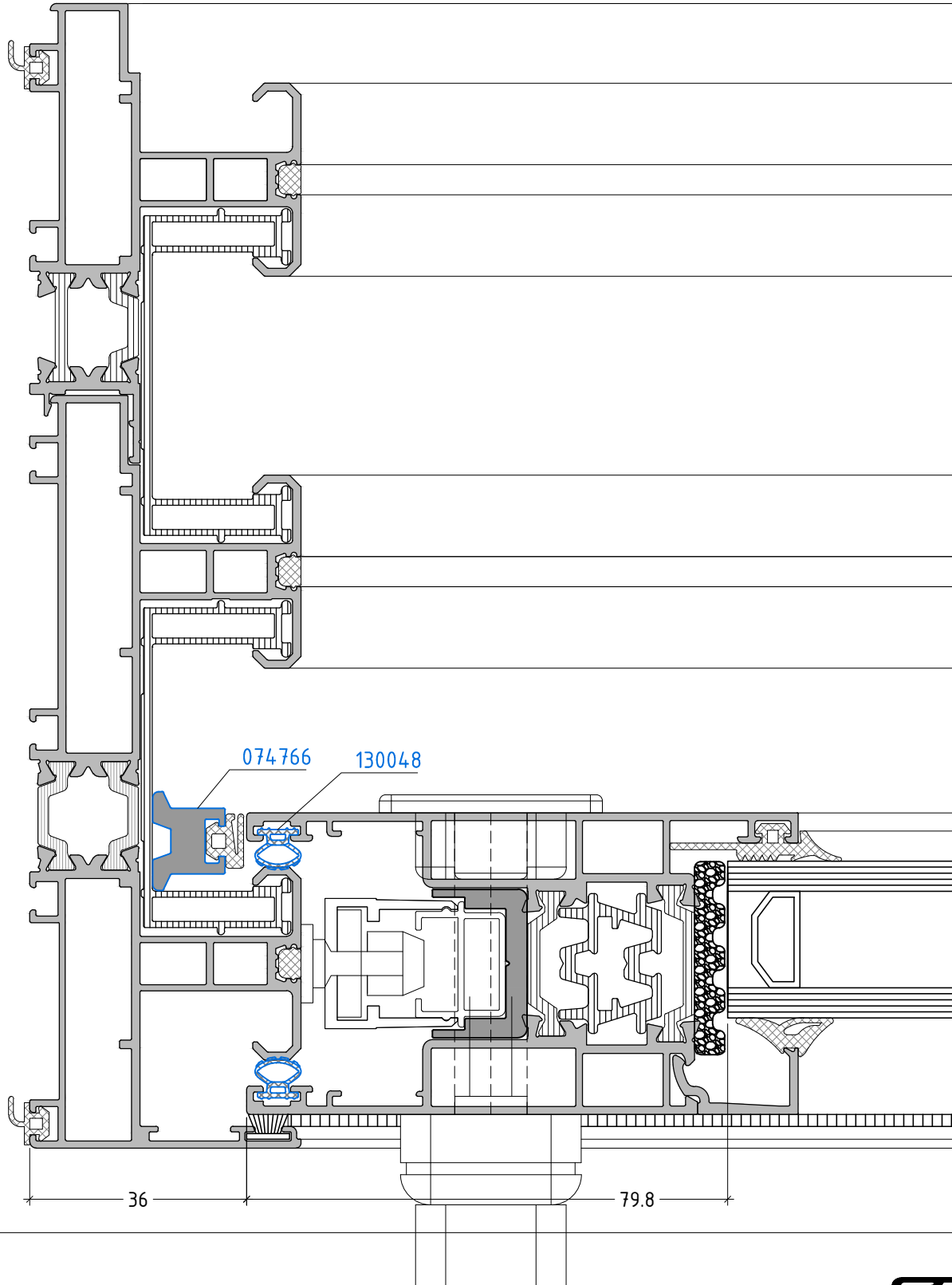
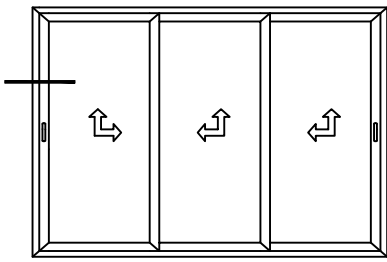

INSTRUCTIONS FOR SEALING BLOCK ET.240839.00

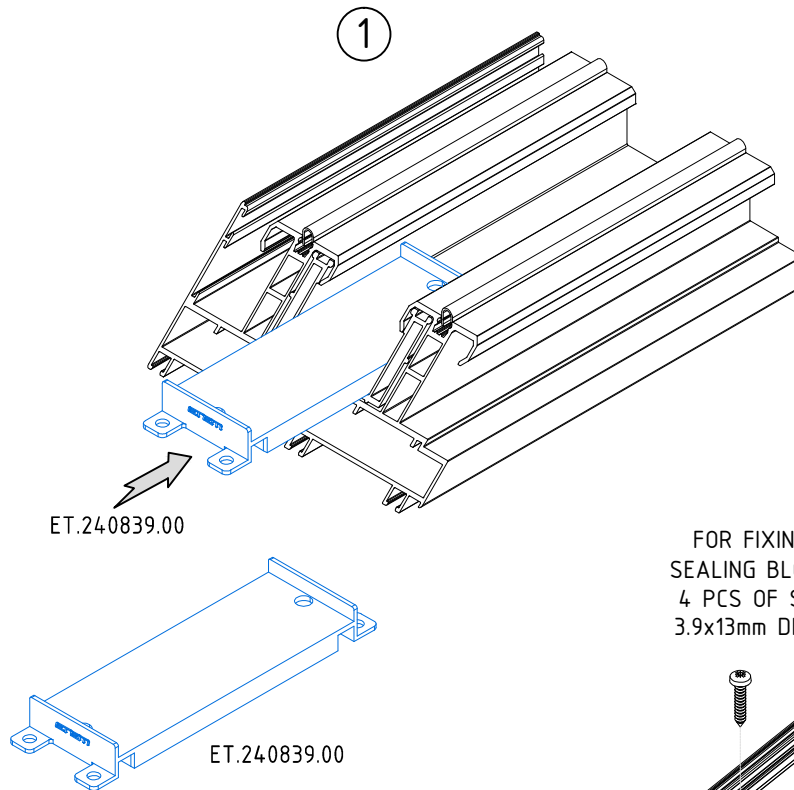

SEALING BLOCK  
ET.240839.00 IS INSERTED  
INTO THE BOTTOM RAIL  
BEFORE ASSEMBLING ALL  
PARTS OF THE RAIL  
(RAIL & PVC ET.080200.00  
ARE CUT TOGETHER).

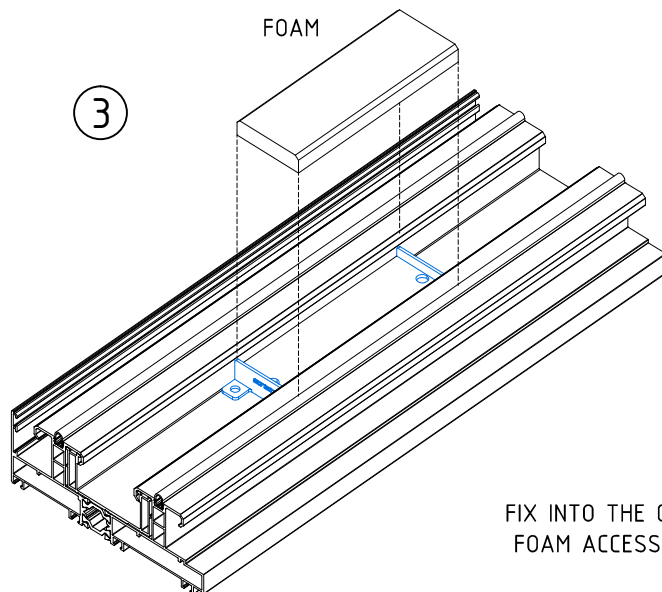
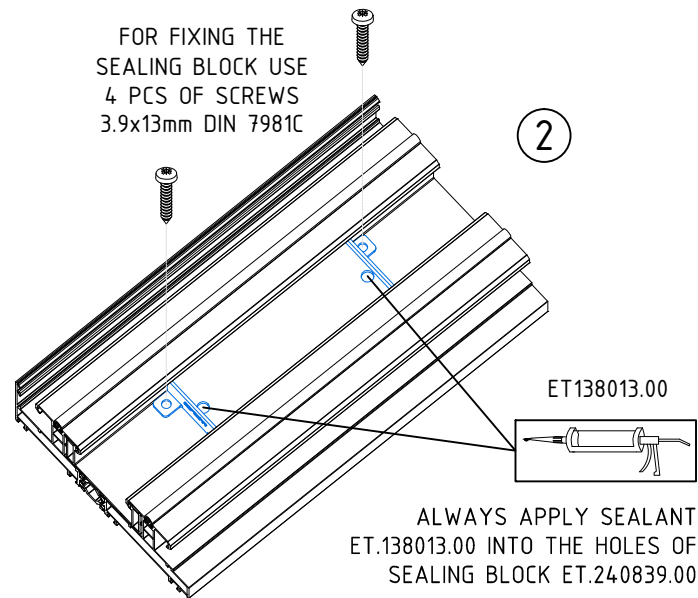

FIX INTO THE CAVITY OF THE SEALING BLOCK THE  
FOAM ACCESSORY (FOR LIFT & SLIDE HARDWARE)

MACHINING ON E50130 FOR DRAINAGE

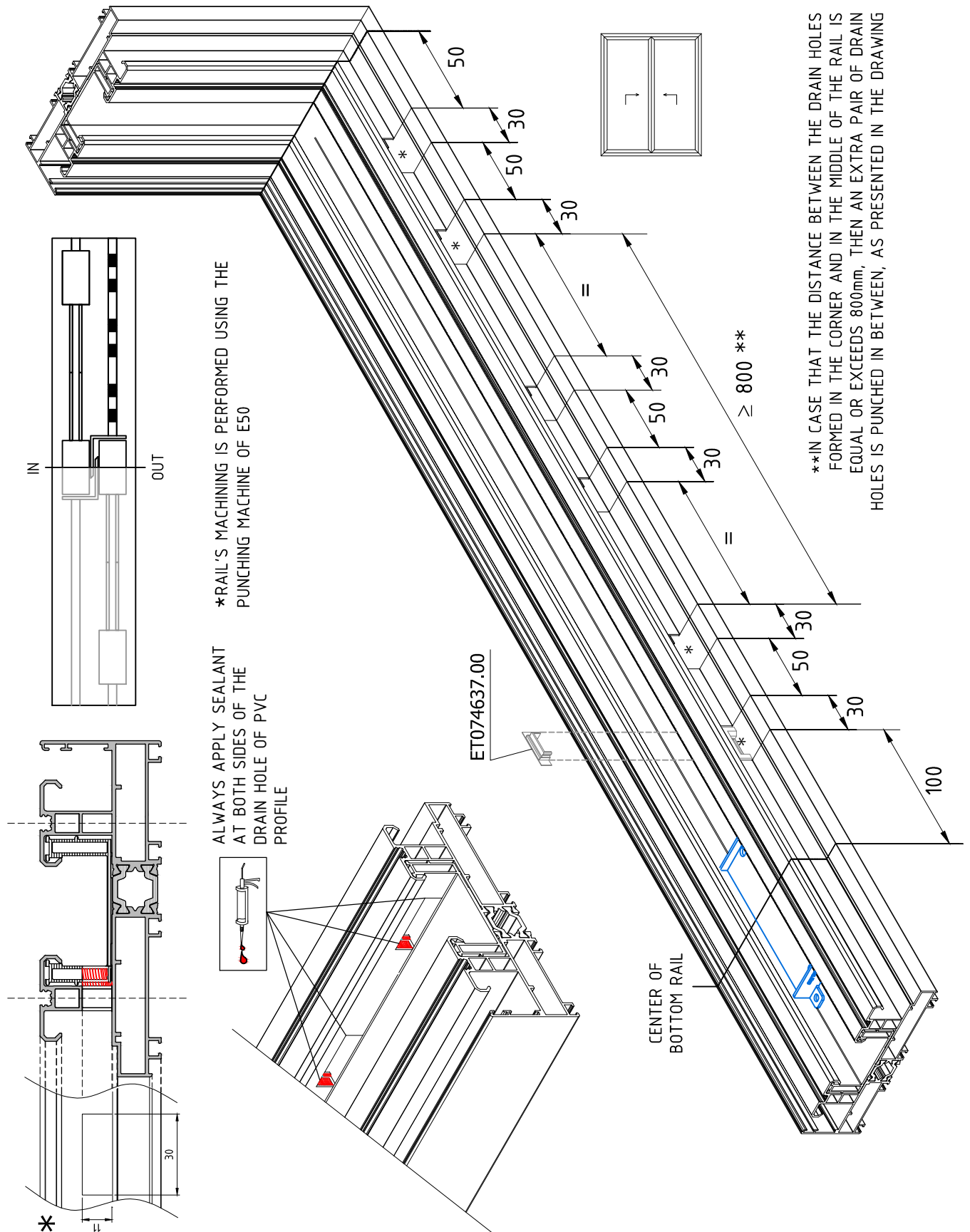

MACHINING ON E50130 FOR DRAINAGE (REQUIRED FOR HIGH PERFORMANCES)

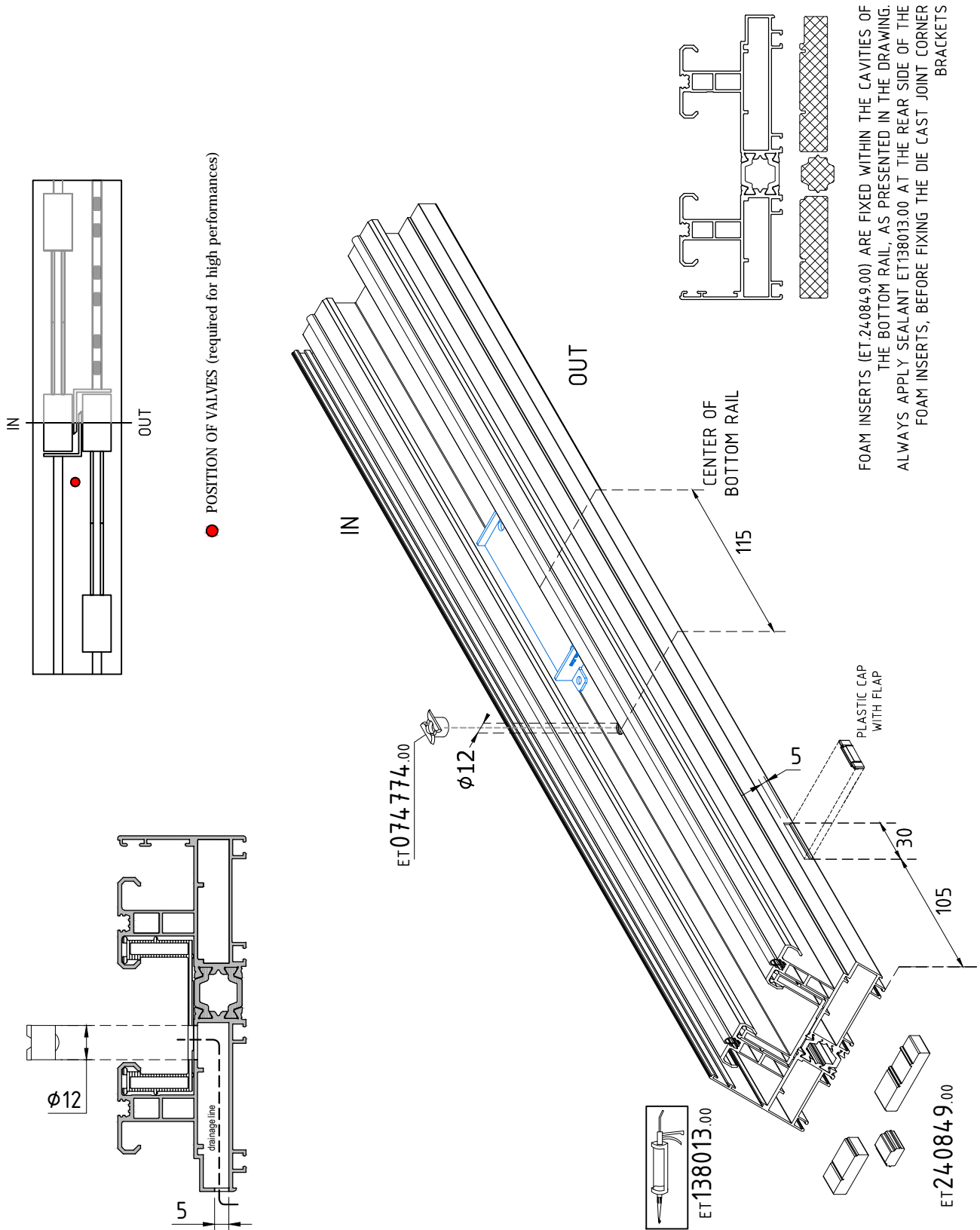

INSTRUCTIONS FOR PLASTIC STOPPER ET.074766.00

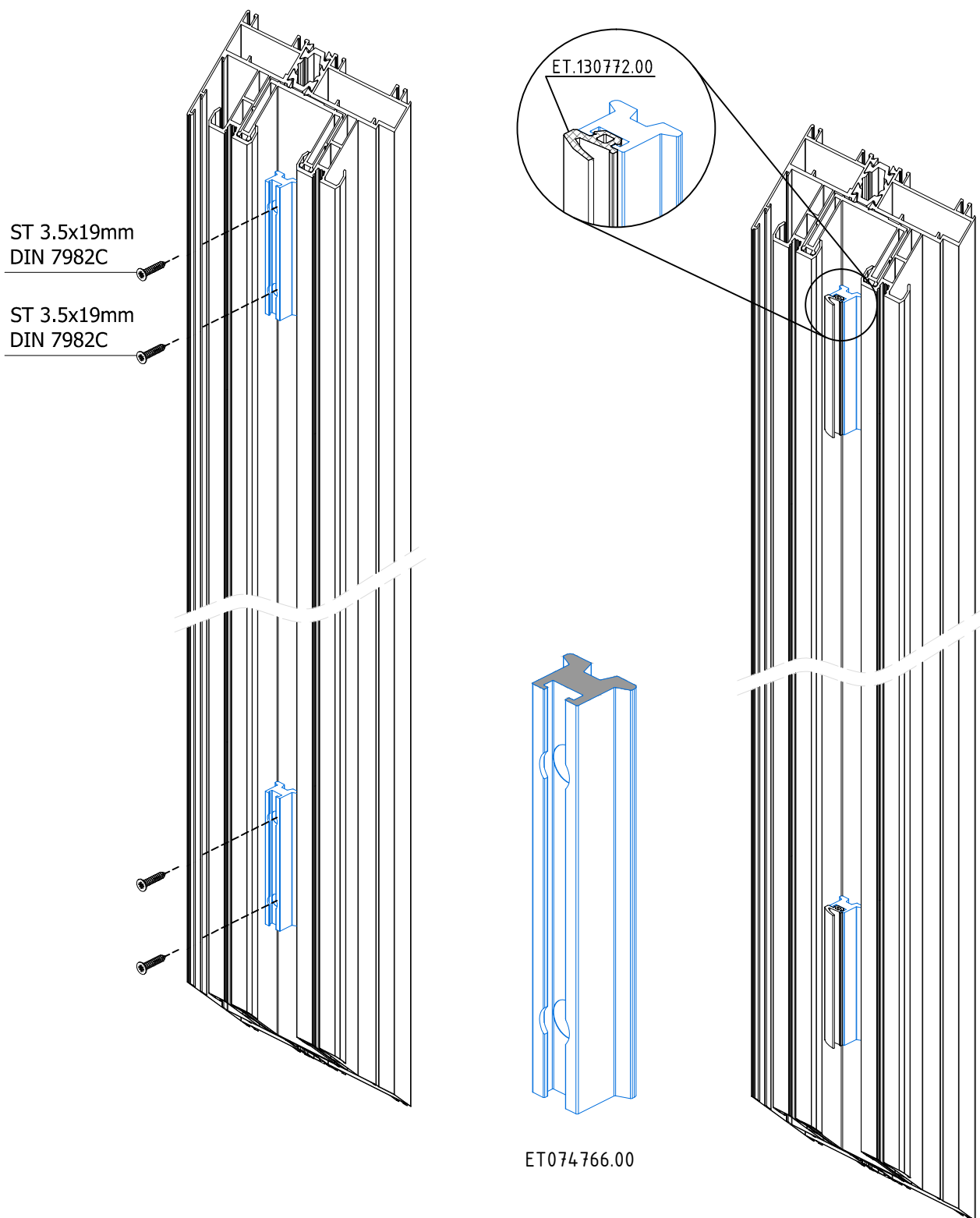

MACHINING REQUIRED FIXING HANDLE & HARDWARE ON BALCONY DOOR SASH  
FOR GU HARDWARE

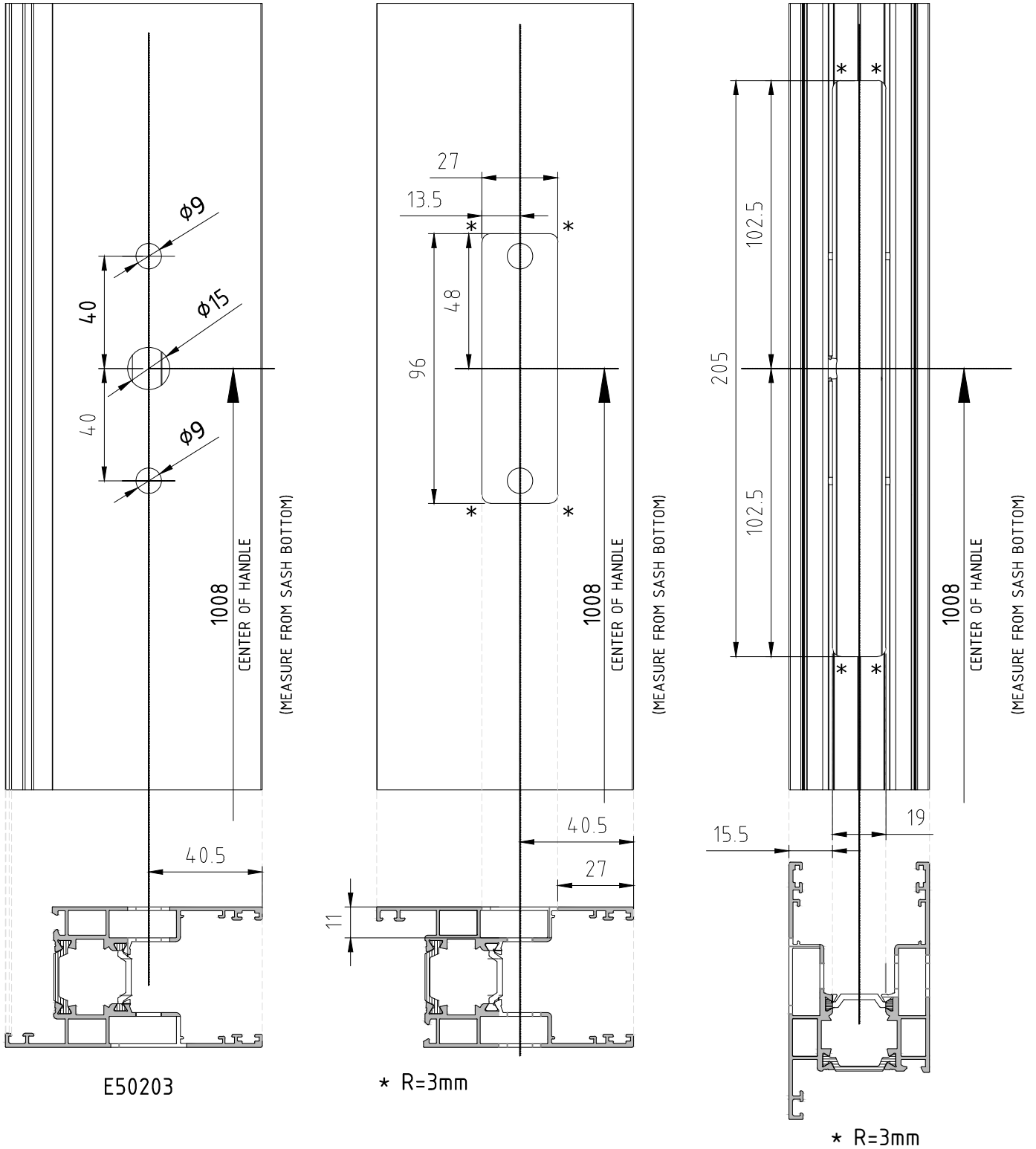

ATTENTION: ALL THE ABOVE ARE VALID FOR 150KG LIFT & SLIDE HARDWARE

ATTENTION: THE CENTRE OF THE HARDWARE IS VALID ONLY FOR DOORS

ATTENTION: THESE INSTRUCTIONS ARE ALSO VALID FOR E50201 AND E50202

INSTRUCTIONS FOR FIXING ET.074813 ONTO THE SASH FRAME

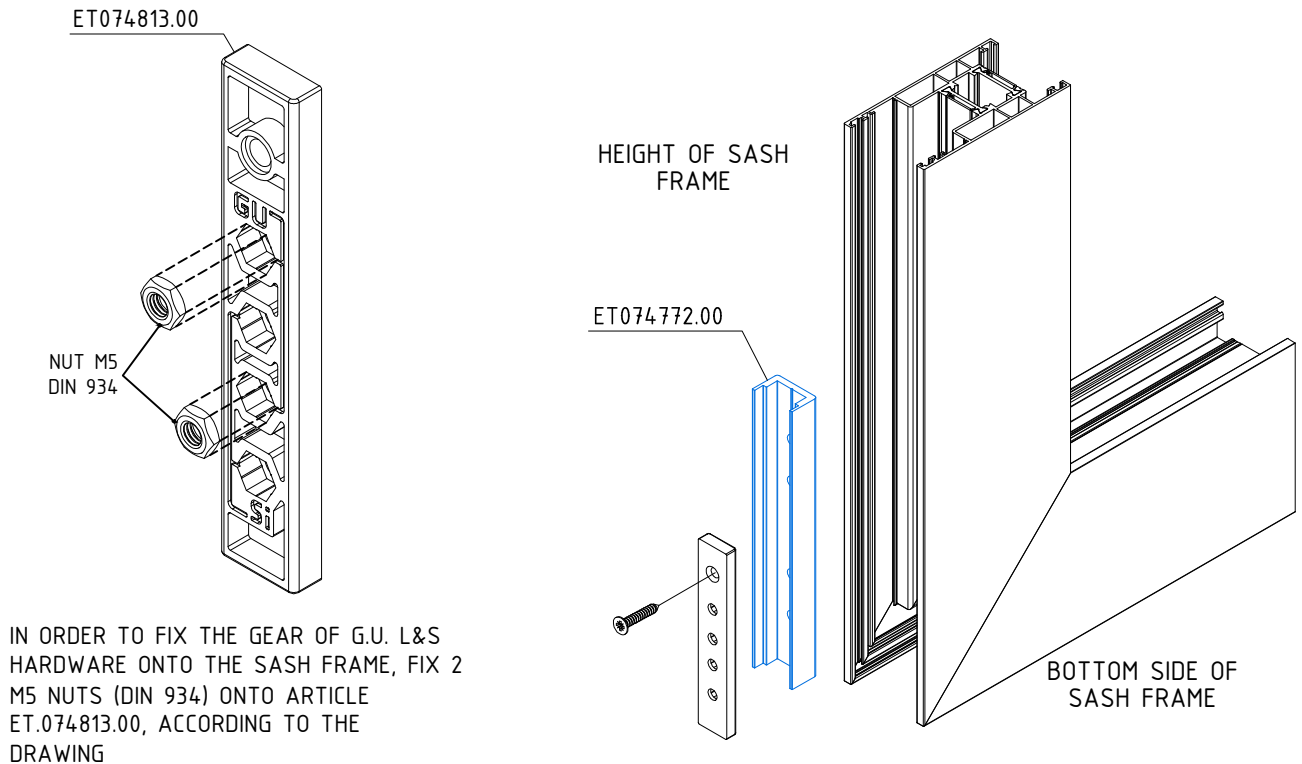

IN ORDER TO FIX THE GEAR OF G.U. L&S HARDWARE ONTO THE SASH FRAME, FIX 2 M5 NUTS (DIN 934) ONTO ARTICLE ET.074813.00, ACCORDING TO THE DRAWING

ARTICLE ET.074813.00 IS FIXED ON THE BOTTOM SIDE OF THE HEIGHT OF THE SASH FRAME, AT THE SIDE WHERE THE GEAR OF THE HARDWARE IS TO BE FIXED.

ATTENTION: THE FIXING HOLE OF ET.074813.00 MUST BE ORIENTED TO THE UPPER SIDE OF THE HEIGHT OF THE SASH FRAME. THE SIDE OF ET.074813.00, WHERE THE NUTS ARE ENCASED, WILL BE IN CONTACT WITH THE PLASTIC SPACER ET.074772.00.

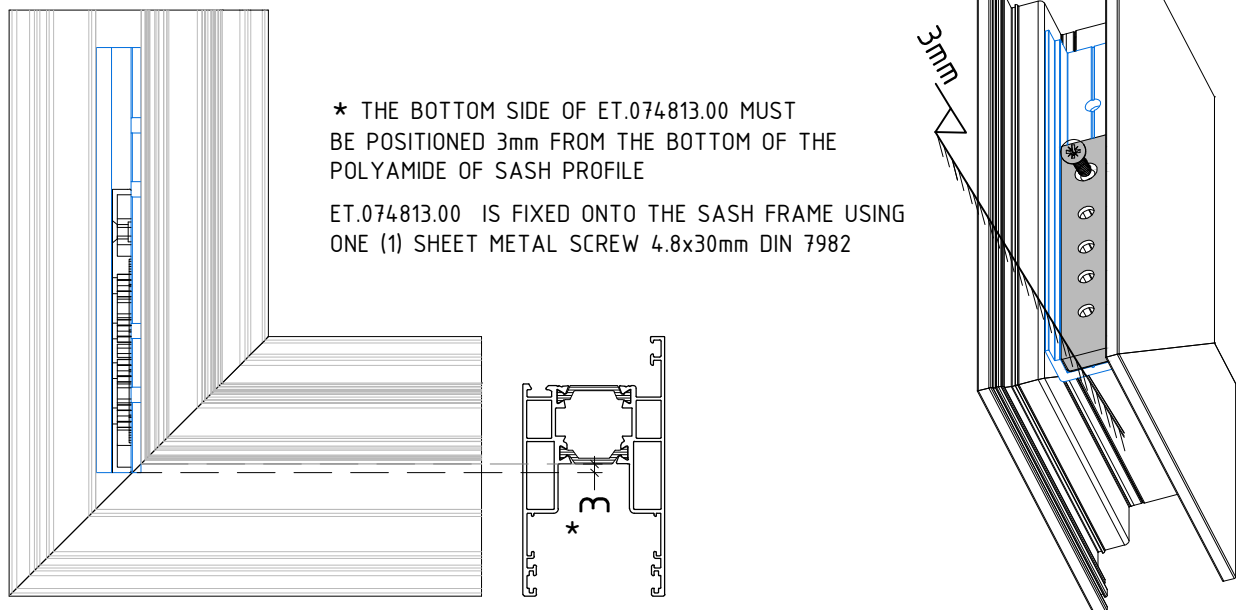



INSTRUCTIONS FOR FIXING ET.074812.00 ONTO THE GEAR OF THE HARDWARE

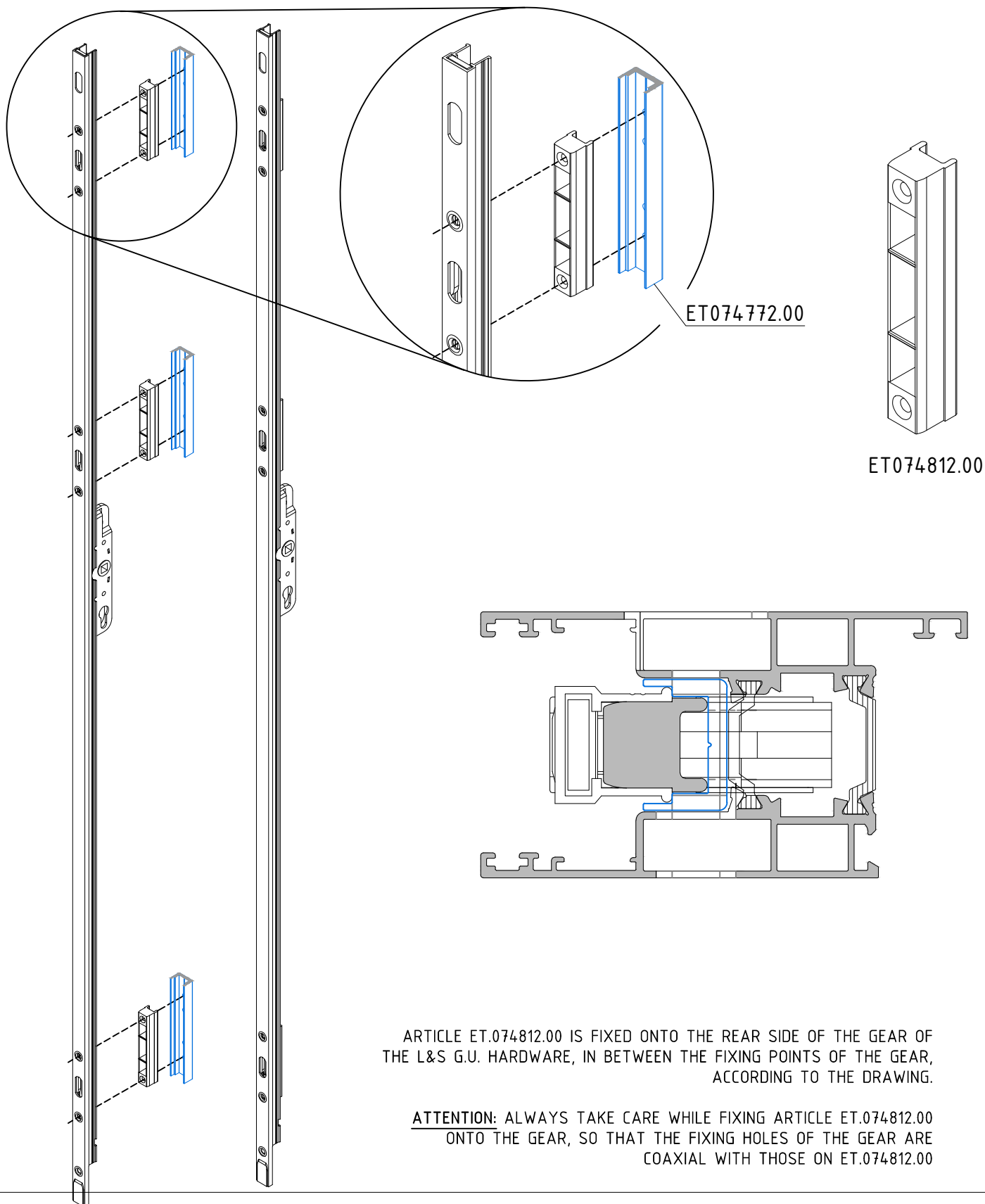

ARTICLE ET.074812.00 IS FIXED ONTO THE REAR SIDE OF THE GEAR OF THE L&S G.U. HARDWARE, IN BETWEEN THE FIXING POINTS OF THE GEAR, ACCORDING TO THE DRAWING.

**ATTENTION:** ALWAYS TAKE CARE WHILE FIXING ARTICLE ET.074812.00 ONTO THE GEAR, SO THAT THE FIXING HOLES OF THE GEAR ARE COAXIAL WITH THOSE ON ET.074812.00

INSTRUCTIONS FOR FIXING G.U. L&S HARDWARE ONTO THE SASH FRAME

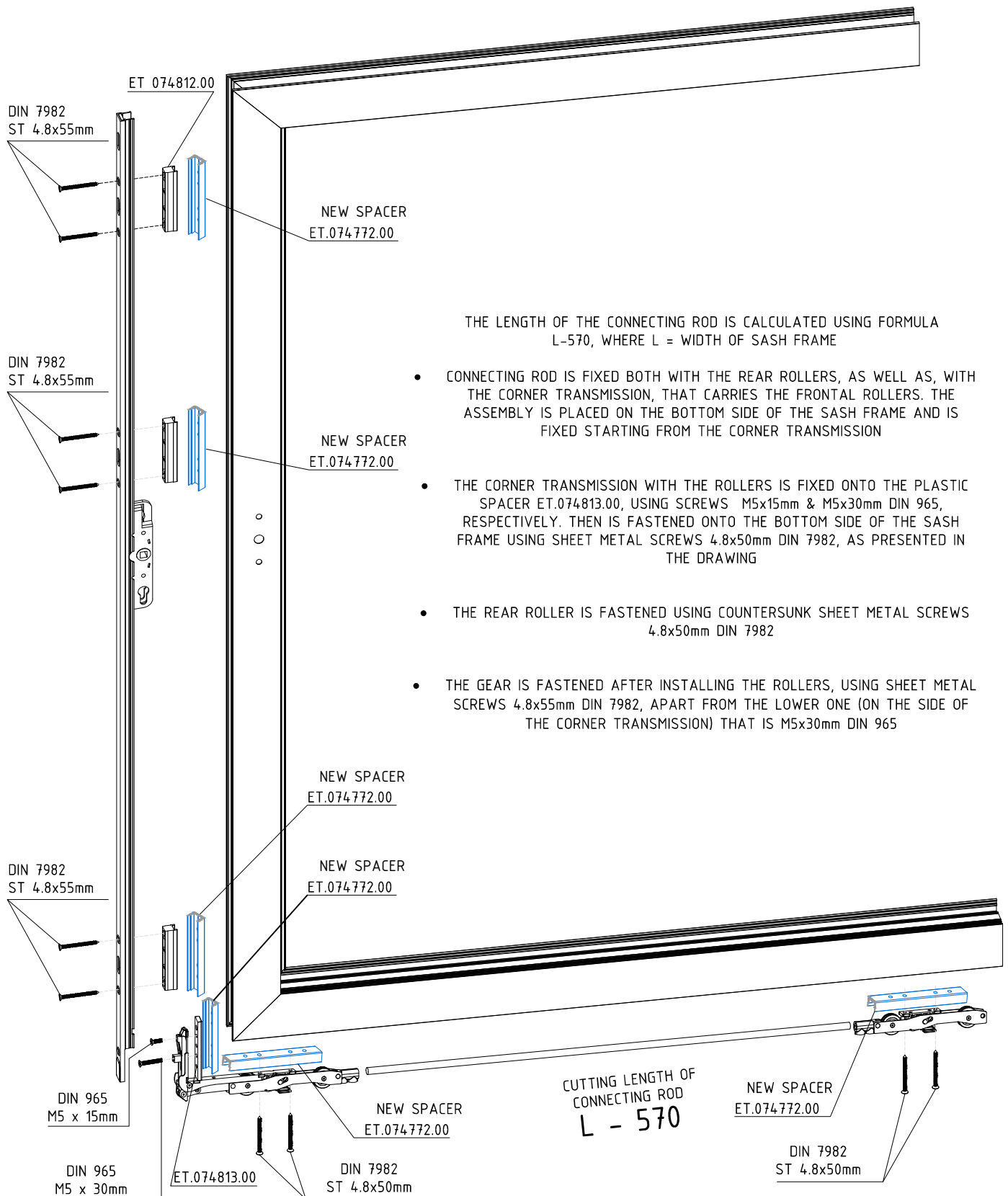

THE LENGTH OF THE CONNECTING ROD IS CALCULATED USING FORMULA  $L-570$ , WHERE L = WIDTH OF SASH FRAME

- CONNECTING ROD IS FIXED BOTH WITH THE REAR ROLLERS, AS WELL AS, WITH THE CORNER TRANSMISSION, THAT CARRIES THE FRONTAL ROLLERS. THE ASSEMBLY IS PLACED ON THE BOTTOM SIDE OF THE SASH FRAME AND IS FIXED STARTING FROM THE CORNER TRANSMISSION
- THE CORNER TRANSMISSION WITH THE ROLLERS IS FIXED ONTO THE PLASTIC SPACER ET.074813.00, USING SCREWS M5x15mm & M5x30mm DIN 965, RESPECTIVELY. THEN IS FASTENED ONTO THE BOTTOM SIDE OF THE SASH FRAME USING SHEET METAL SCREWS 4.8x50mm DIN 7982, AS PRESENTED IN THE DRAWING
- THE REAR ROLLER IS FASTENED USING COUNTERSUNK SHEET METAL SCREWS 4.8x50mm DIN 7982
- THE GEAR IS FASTENED AFTER INSTALLING THE ROLLERS, USING SHEET METAL SCREWS 4.8x55mm DIN 7982, APART FROM THE LOWER ONE (ON THE SIDE OF THE CORNER TRANSMISSION) THAT IS M5x30mm DIN 965

code/description	package/pcs	colour
ET 130048.00		

Gasket for sash profile

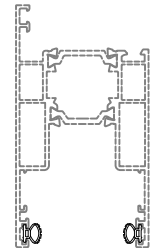

ET 074766.00		●
--------------	--	---

Plastic stopper 80mm

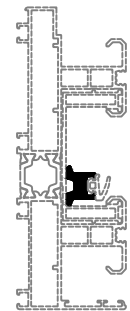
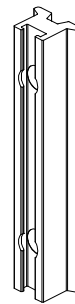

ET 130772.00		
--------------	--	--

EPDM seal gasket for stopper

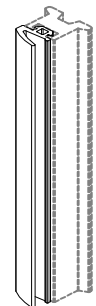

ET 074772.00		●
--------------	--	---

Plastic spacer 150mm, for gear GU937 & rollers

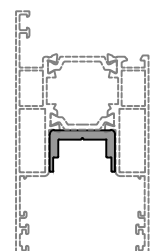
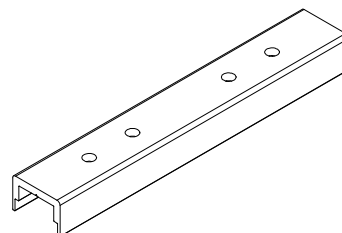

code/description	package/pcs	colour
ET 080200.00		●

PVC profile for rails  
(bottom, upper, jamb)



ET 240849.00		
--------------	--	--

Set of foam inserts for  
cavities of rail E50130

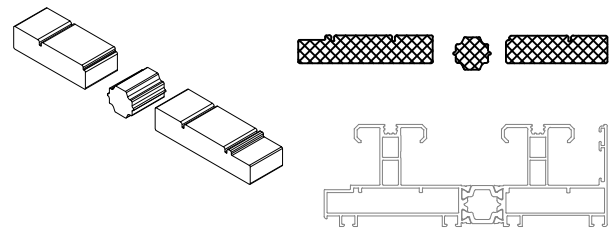

ET 240850.00		
--------------	--	--

Set of foam inserts for  
cavities of rail E50133

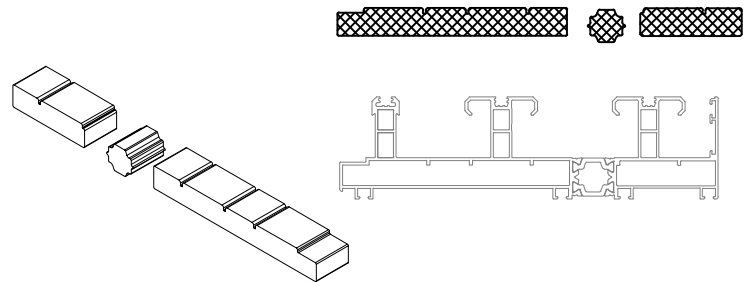

ET 240839.00		
--------------	--	--

Central sealing block  
for bottom rails (lift &  
slide)

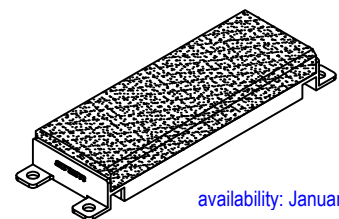

availability: January 2020

code/description	package/pcs	colour
ET 240818.00		

Foam part (41 mm) for sealing  
sash - interlock  
on top of E50

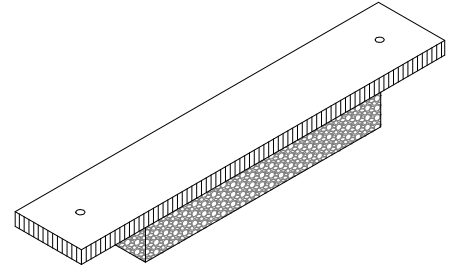

ET 074750.00		
--------------	--	--

Pair of plastic plugs  
for interlock

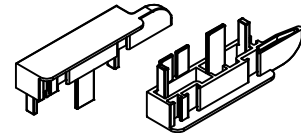

ET 074741.00		
--------------	--	--

Plastic plug with foam insert  
for interlock bottom  
(ONLY lift & slide)

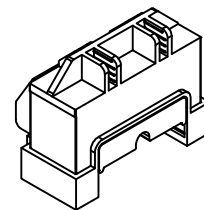

ET 074742.00		
--------------	--	--

Plastic plug for upper side  
of interlock (for lift &  
slide)

