

TECHNICAL BULLETIN

N 104 - 2023. 01

E50 – ES70

New profiles for slim fly screen sash 36mm

content:

- PROFILES
- PROFILES 1:1
- DETAILS
- ACCESSORIES

ETEM

slim fly screen sash 36mm

E50 - ES70

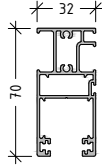
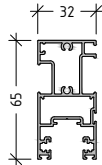
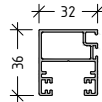
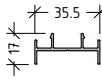
code	Profile	Weight Length Moment of inertia	code	Profile	Weight Length Moment of inertia
E50220 Fly screen sash for classic rails		1175 g/m L=6.01 m			
E50221 Fly screen sash for flat rails E50 - ES70		1112 g/m L=6.01 m			
E50222 Slim fly screen sash for classic & flat rails		632 g/m L=6.01 m			
E50223 Central adaptor for E50221		248 g/m L=6.01 m			

E50220

Fly screen sash
for classic rails

1175 g/m

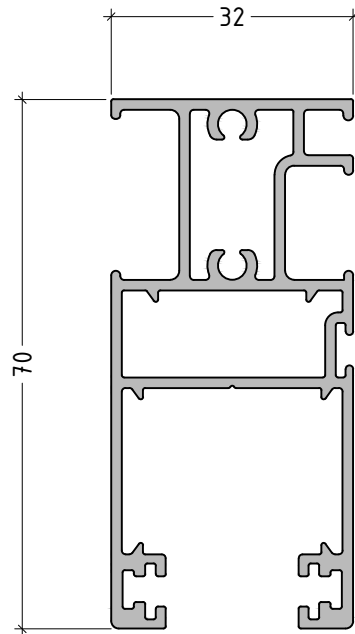

E50221

Fly screen sash
for flat rails
E50 - ES70

1112 g/m

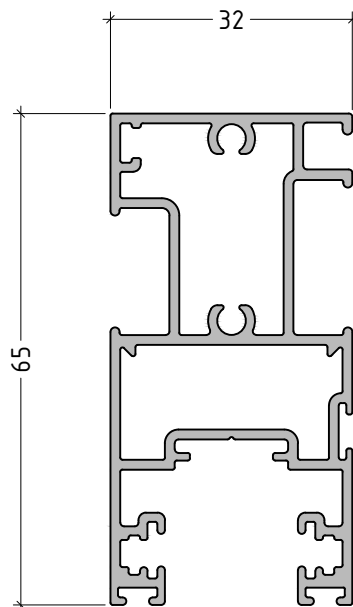

scale : 1:1

E50222

Slim fly screen sash
for classic &
flat rails

632 g/m

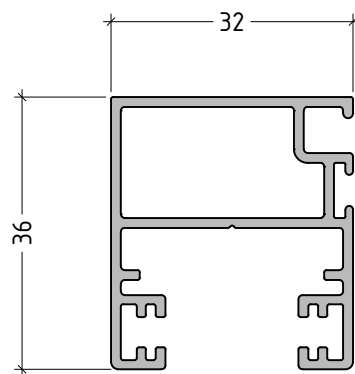

E50223

Central adaptor
for E50221

248 g/m

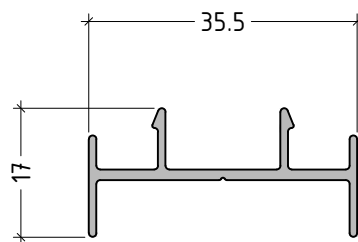

scale : 1:1

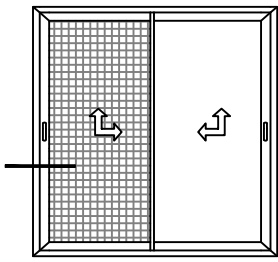

E50 - Evo

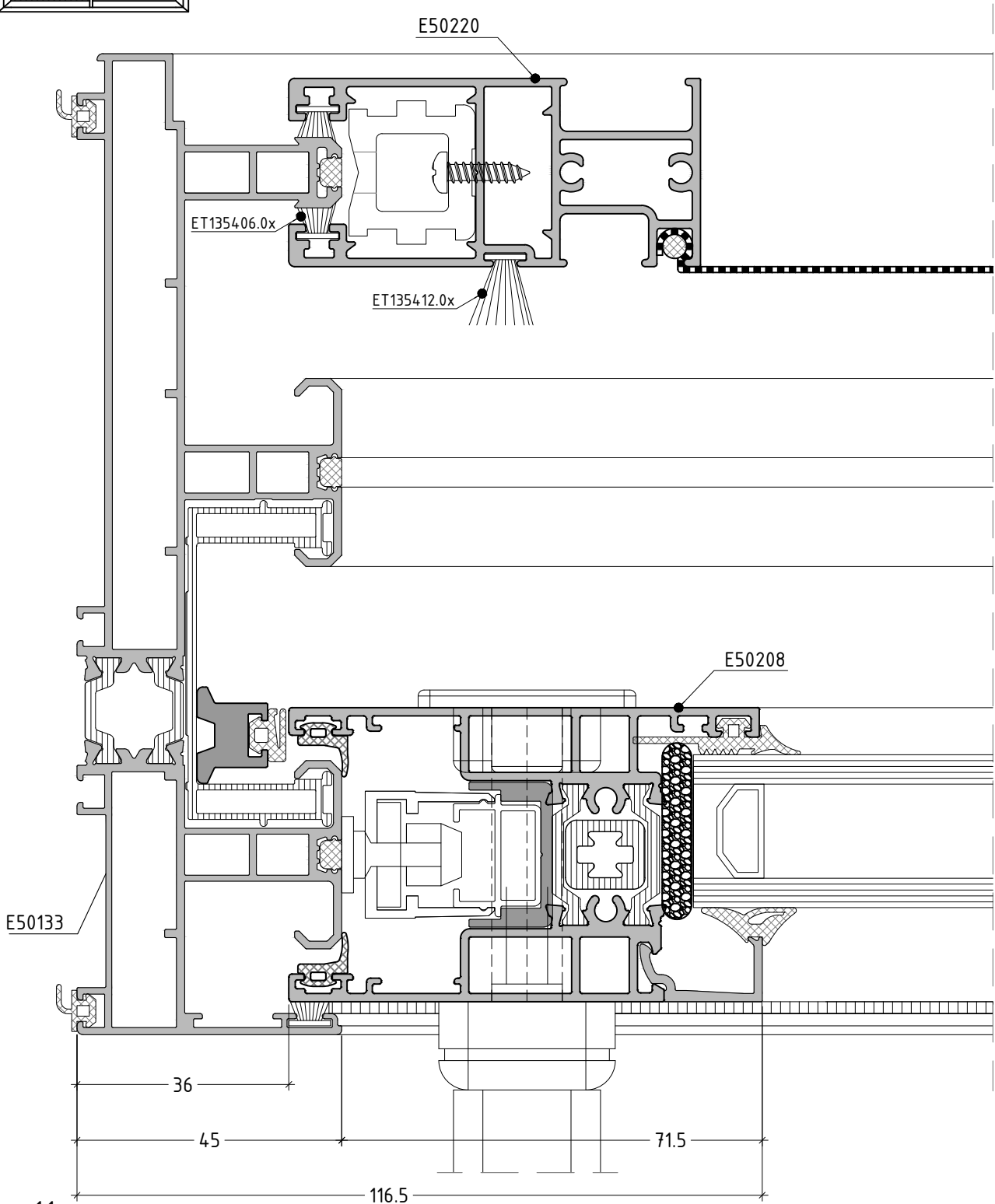

scale : 1:1

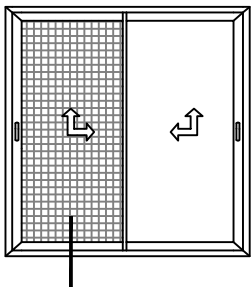

E50 - Evo

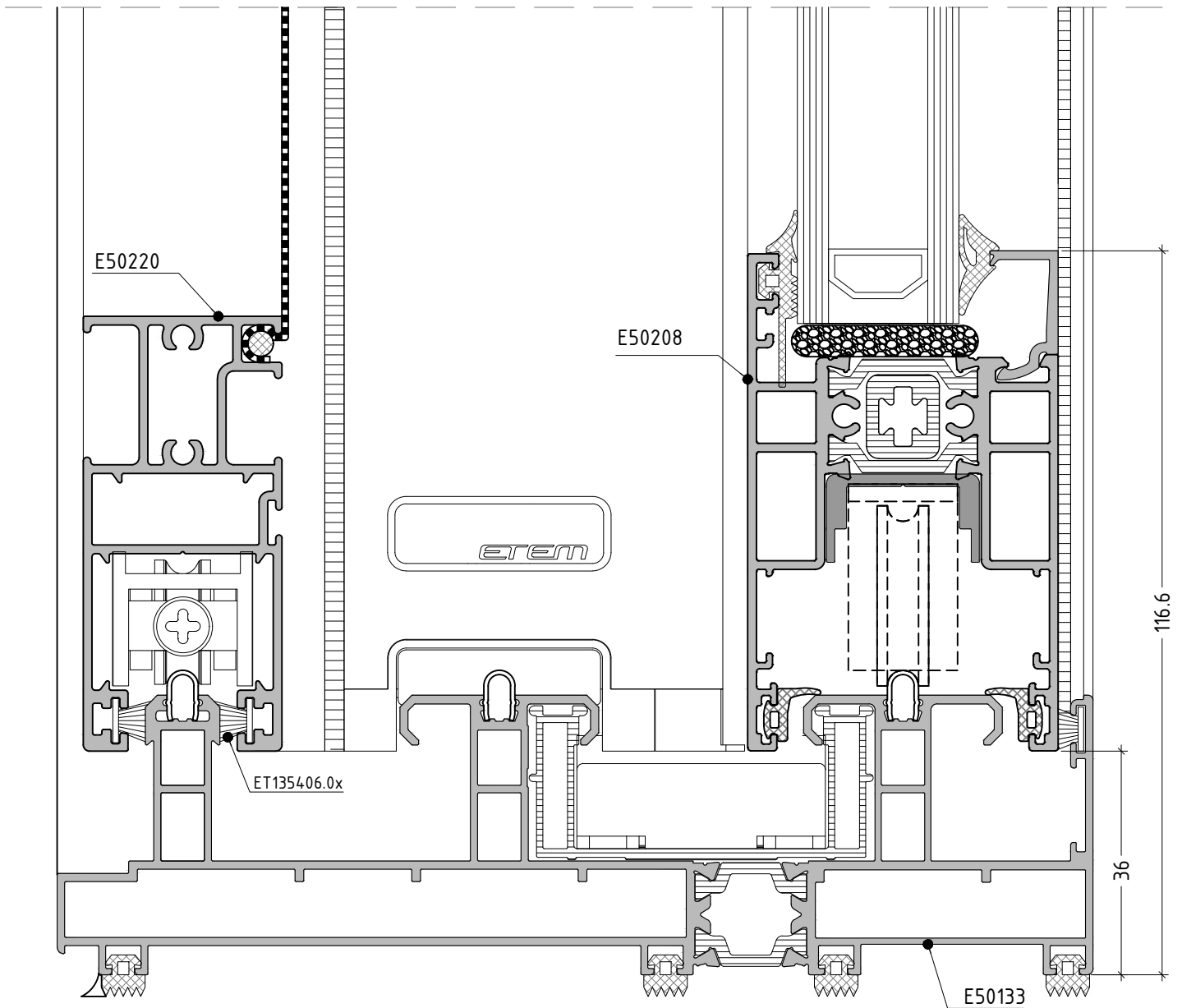

scale : 1:1

05

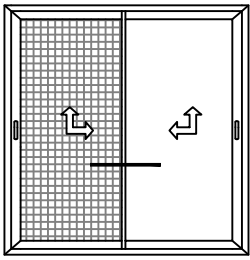

E50 - Evo & Flat rail (interlock 36mm)

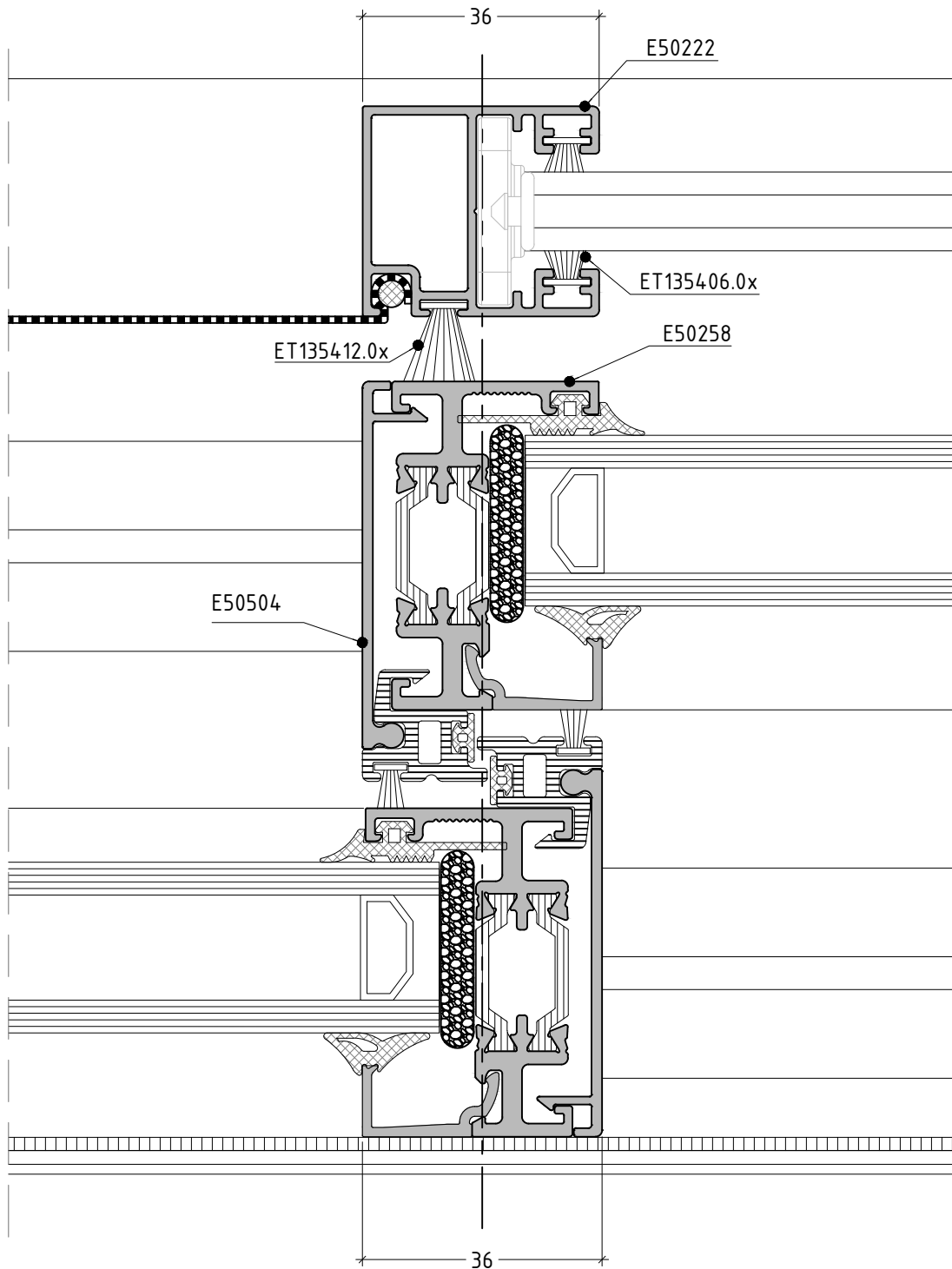

scale : 1:1

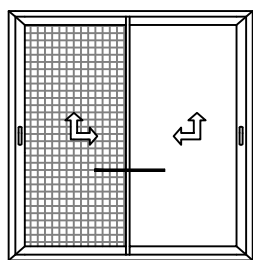

E50 - Evo & Flat rail (interlock 49mm)

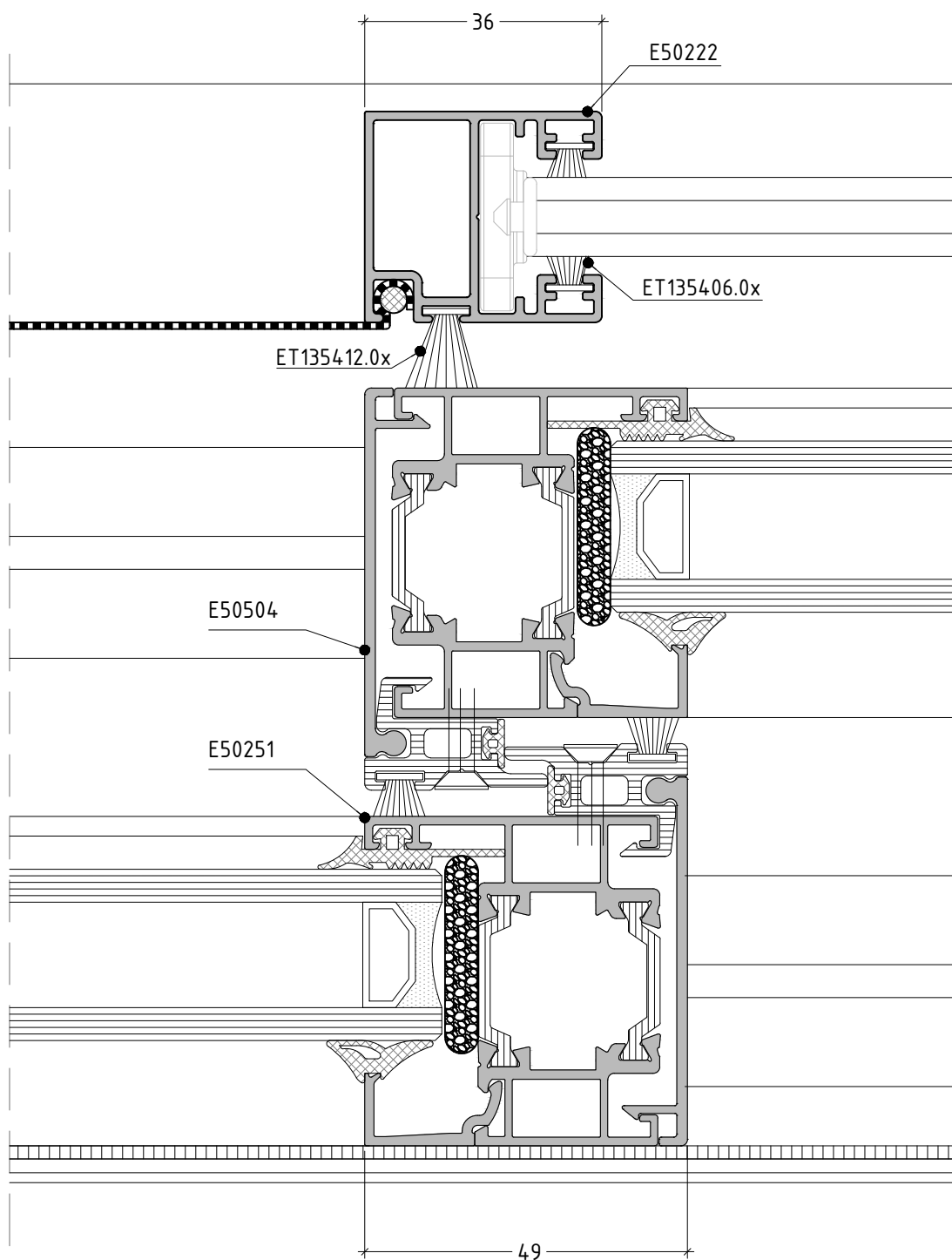

scale : 1:1

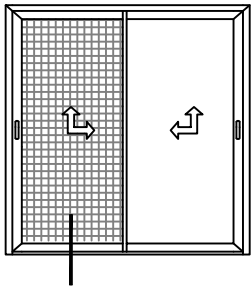

E50 - Flat rail

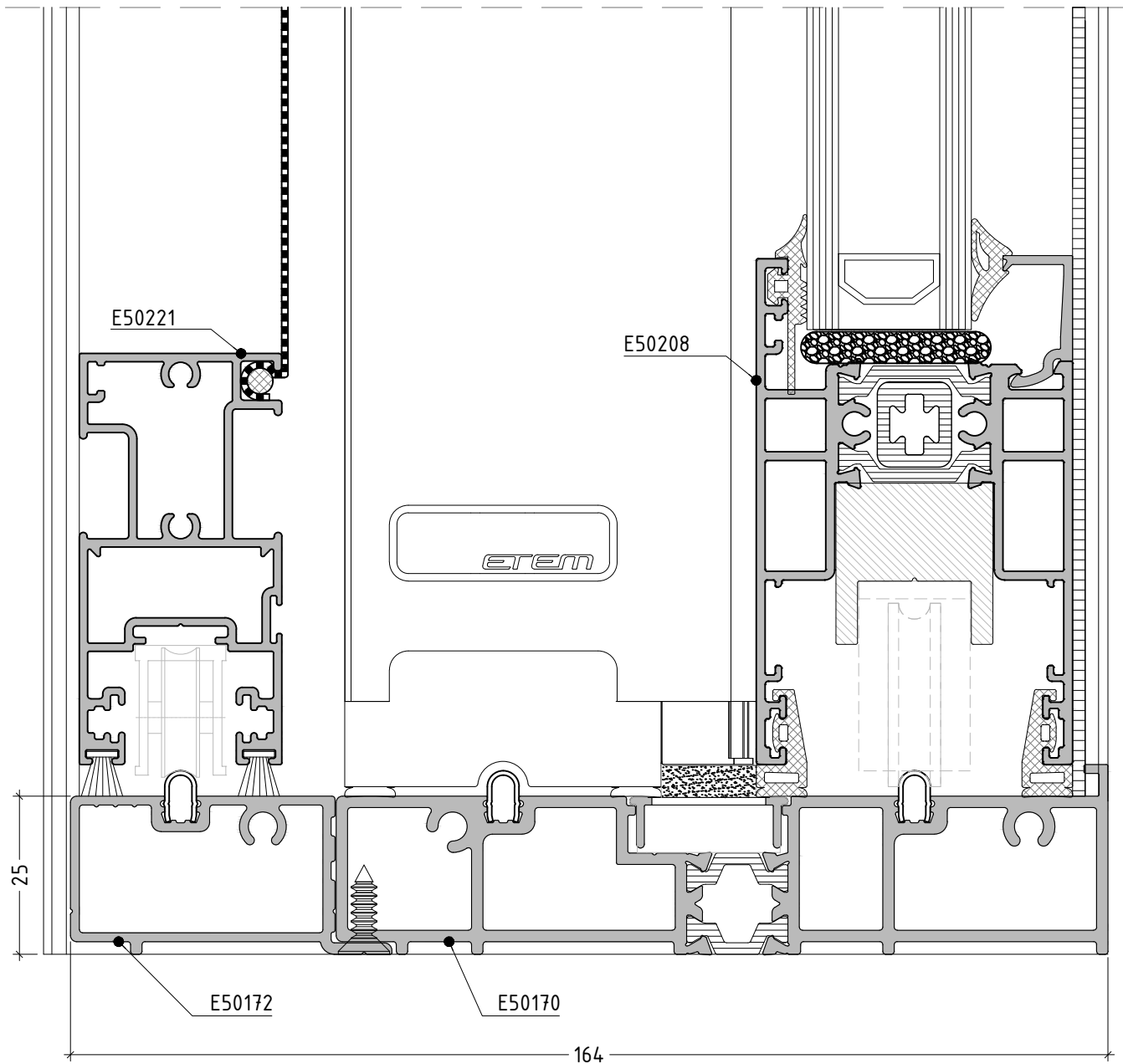

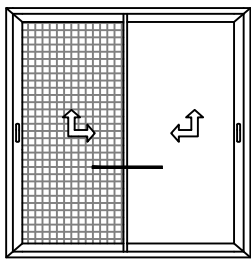

ES70 - Classic & Flat rail

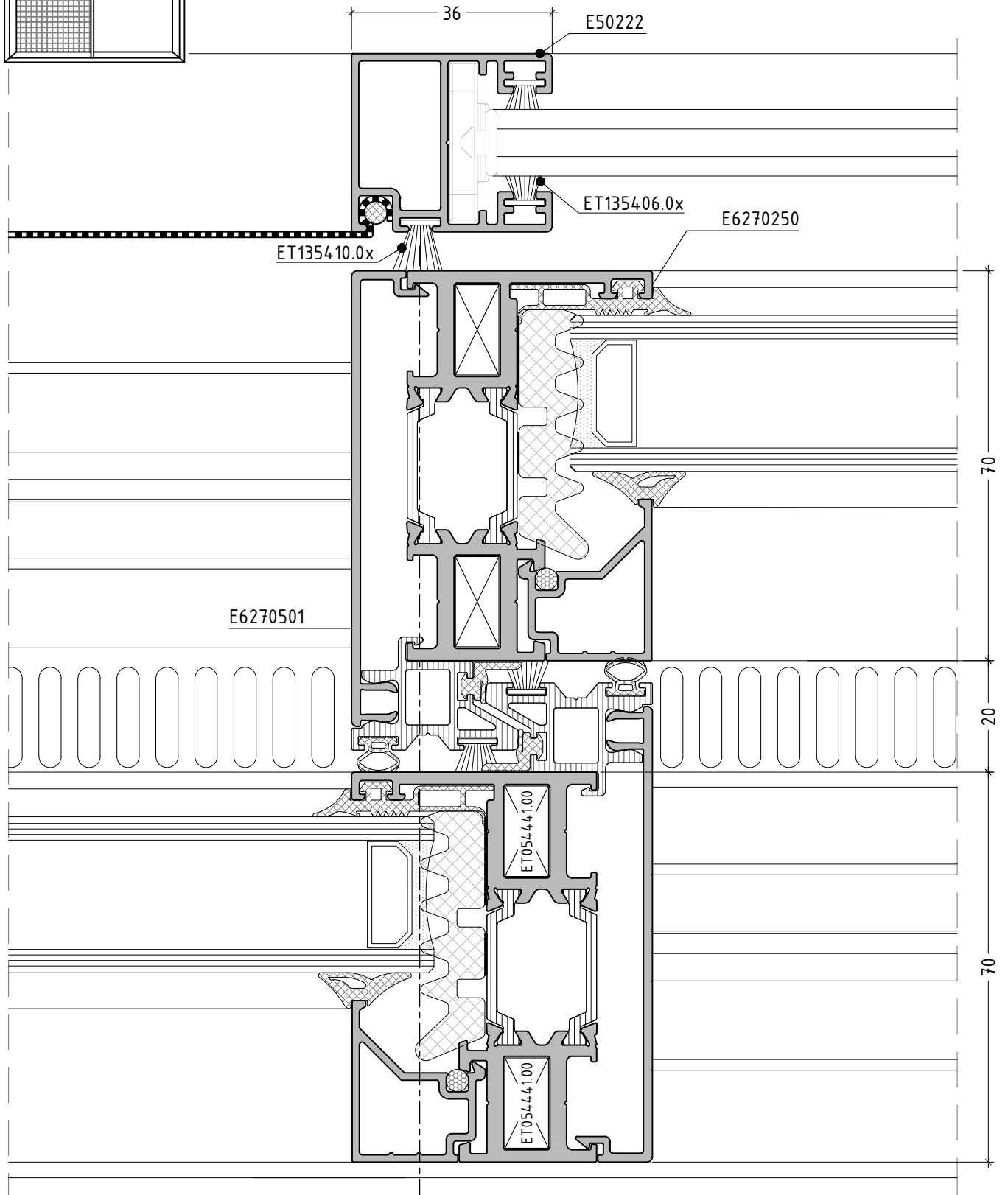

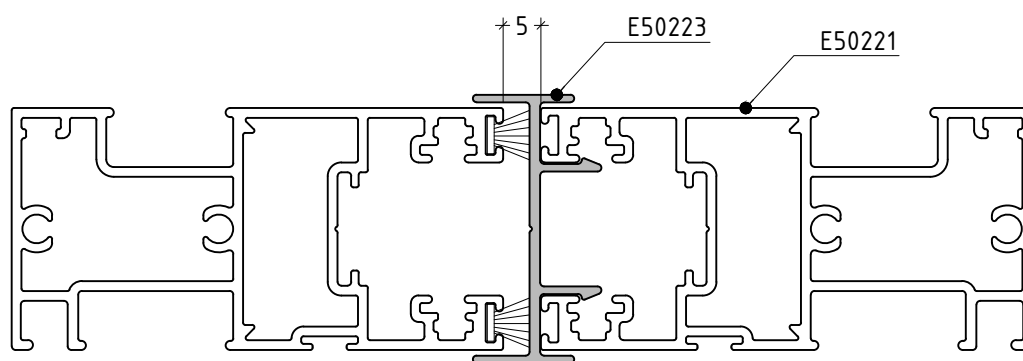
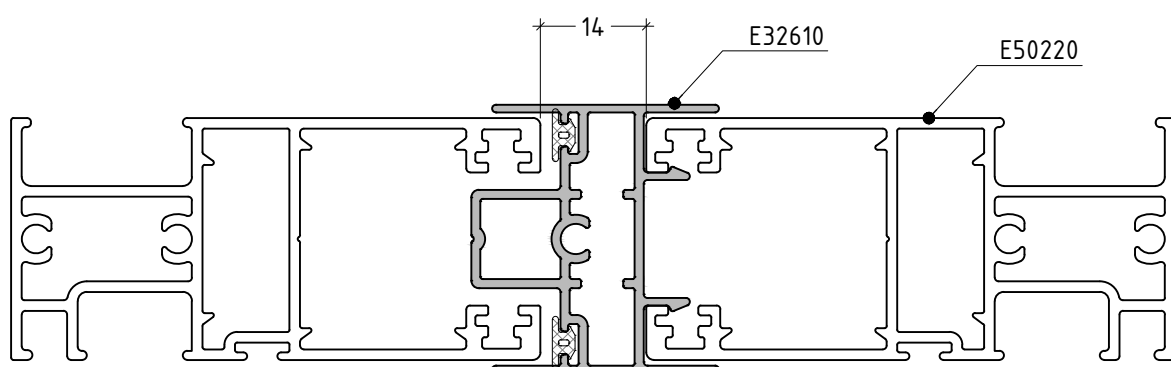

DOUBLE LEAF WITH LIFT-SLIDE MECHANISM (INTERLOCK 49mm)

E50 - Classic rail

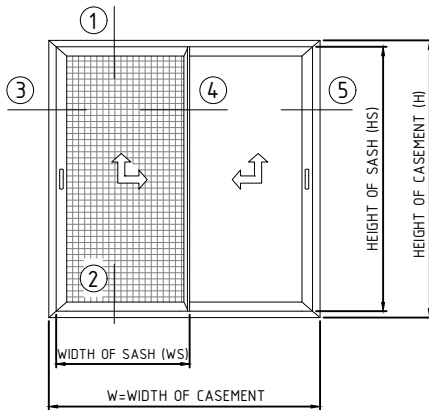

CUTTING LENGTHS	
WIDTH OF FRAME E50130 (or E50100)	= W
HEIGHT OF FRAME E50130 (or E50100)	= H
WIDTH OF SASH (WS)	= $\frac{W + 62}{2}$
FINAL WIDTH OF SASH	= WS - 47
HEIGHT OF SASH	= H - 72
HEIGHT OF E50251	= H - 166
HEIGHT OF SUPL. E50504	= H - 92
WIDTH OF SCREEN SASH E50220	= $\frac{W - 121}{2}$
HEIGHT OF E50220 & E50222	= H - 72

DIMENSION IN MILLIMETERS
ALL MEASUREMENTS ARE TAKEN FROM THE EXTERNAL SIDE OF THE FRAME

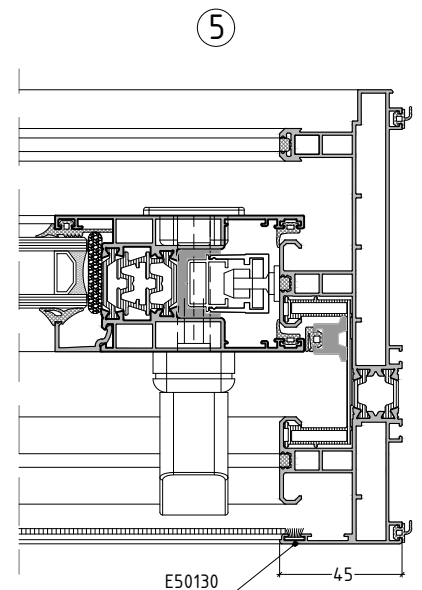
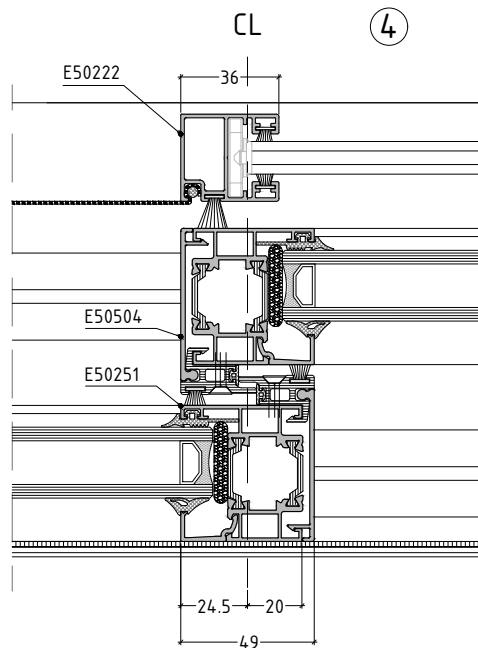
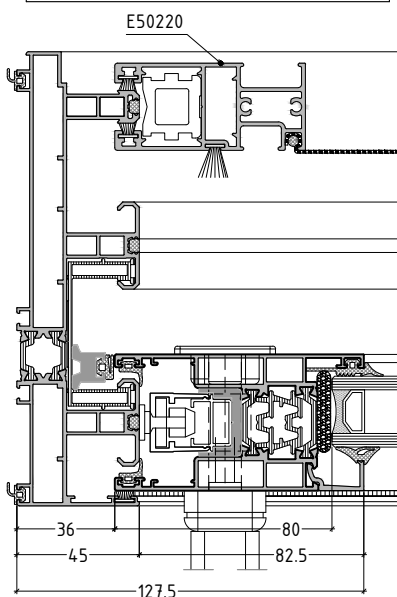
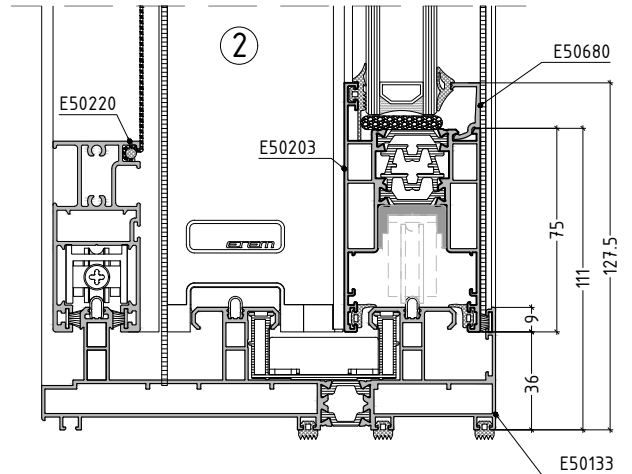
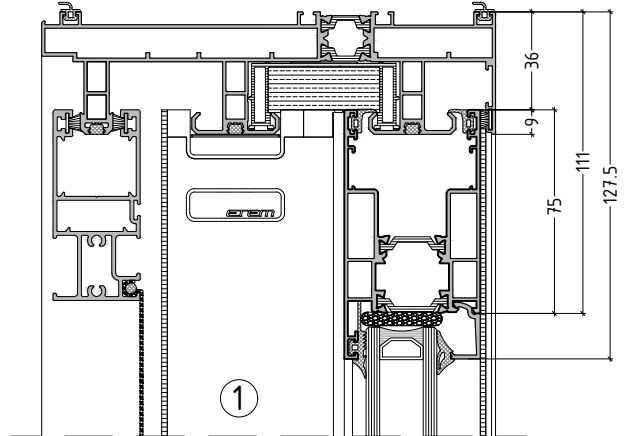
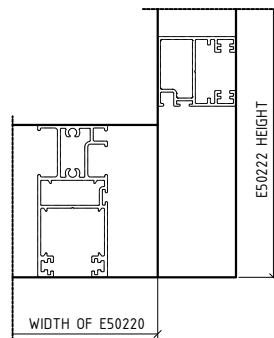
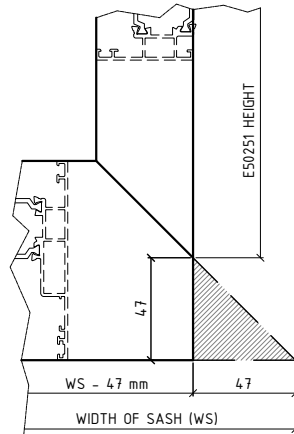

no scale

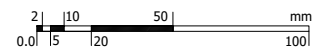

Cutting list 01

DOUBLE LEAF WITH LIFT-SLIDE MECHANISM (INTERLOCK 49mm)

E50 - Flat rail

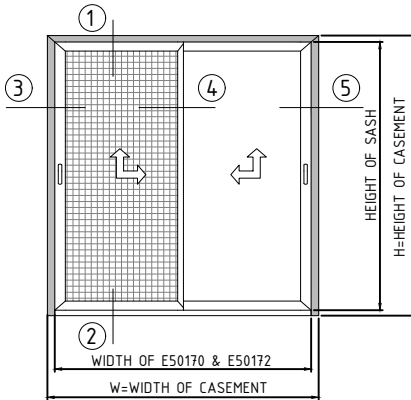

CUTTING LENGTHS

WIDTH OF FRAME E50133	= W
HEIGHT OF FRAME E50133	= H
WIDTH OF FRAMES E50170 & E50172	= W - 40*
WIDTH OF SASH E50203 (WS)	= $\frac{W + 62}{2}$
FINAL WIDTH OF SASH	= WS - 47
HEIGHT OF SASH E50203	= H - 66
HEIGHT OF SASH E50251	= H - 160
HEIGHT OF SUPL. E50504	= H - 86
WIDTH OF SCREEN SASH E50221	= $\frac{W - 121}{2}$
HEIGHT OF SCREEN SASH E50221 & E50222	= H - 66

DIMENSION IN MILLIMETERS
ALL MEASUREMENTS ARE TAKEN FROM THE EXTERNAL SIDE OF THE FRAME
*NOTE: CUTTING LENGTH INCLUDES FLANGE THICKNESS (ET076700.00)

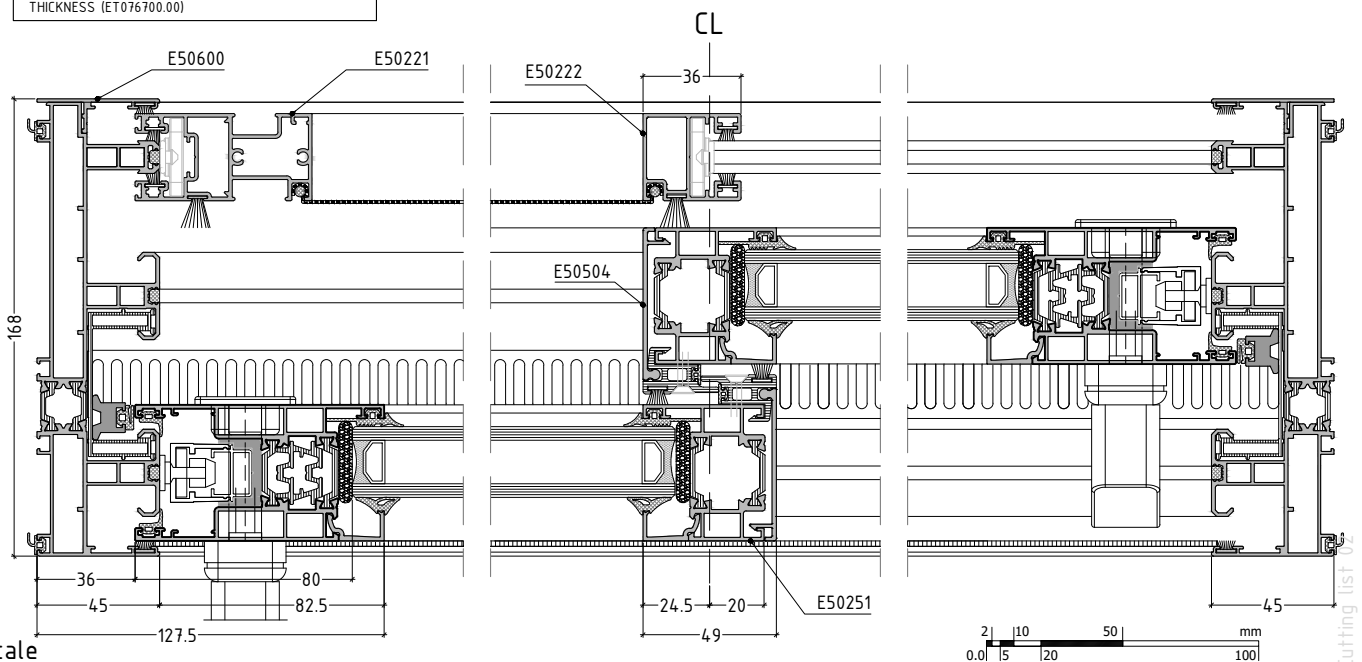
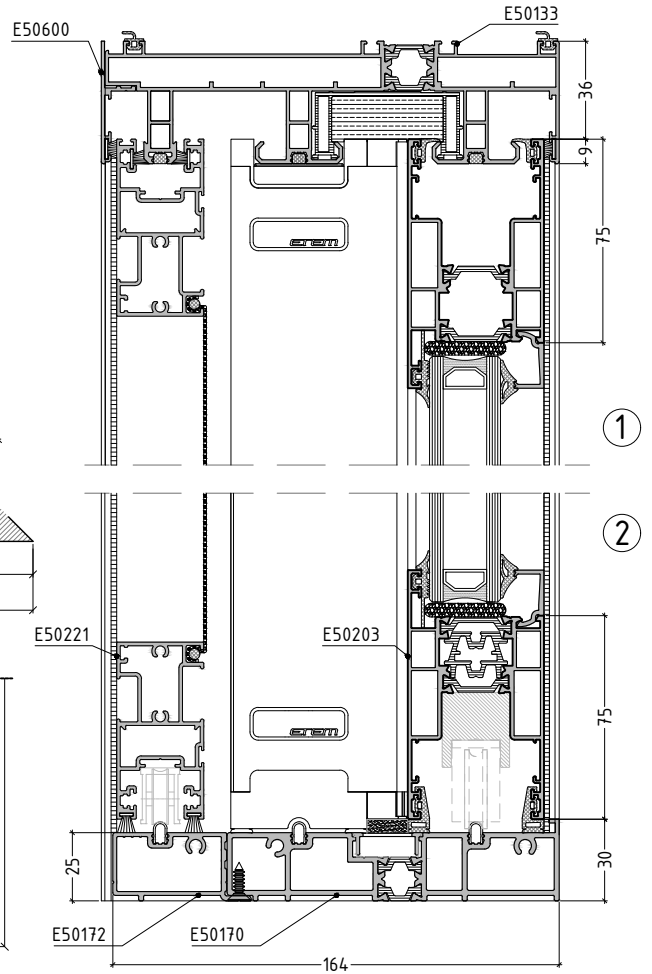
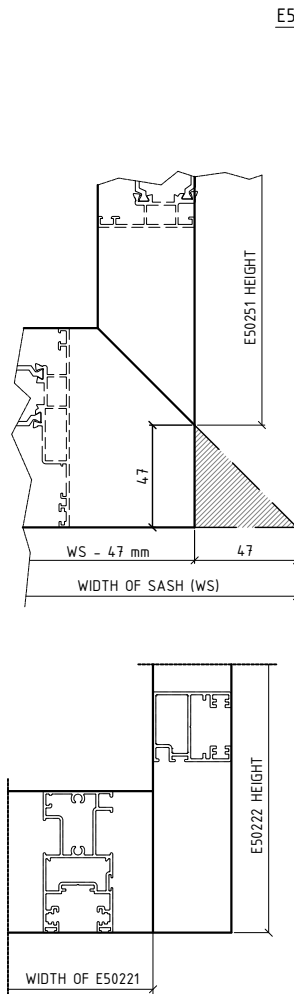

no scale

DOUBLE LEAF WITH LIFT-SLIDE MECHANISM (INTERLOCK 36mm)

E50 - Classic rail

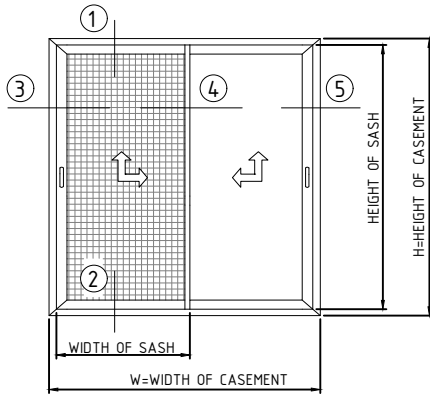

CUTTING LENGTHS	
WIDTH OF FRAME E50130	= W
HEIGHT OF FRAME E50130	= H
WIDTH OF SASH (WS)	= $\frac{W - 44}{2}$
HEIGHT OF SASH	= H - 72
HEIGHT OF E50258	= H - 92
HEIGHT OF SUPL. E50504	= H - 92
WIDTH OF SCREEN SASH E50220	= $\frac{(W - 108)}{2}$
HEIGHT OF E50220 & E50222	= H - 72

ALL MEASUREMENTS ARE TAKEN FROM THE EXTERNAL SIDE OF THE FRAME

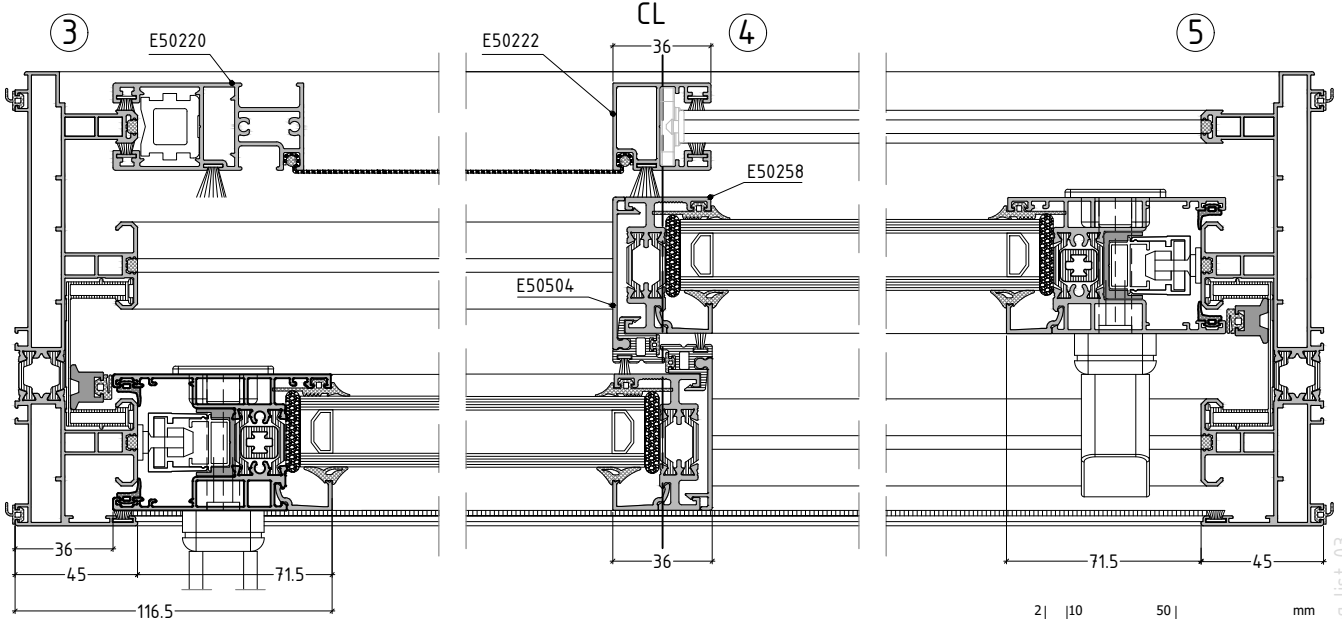
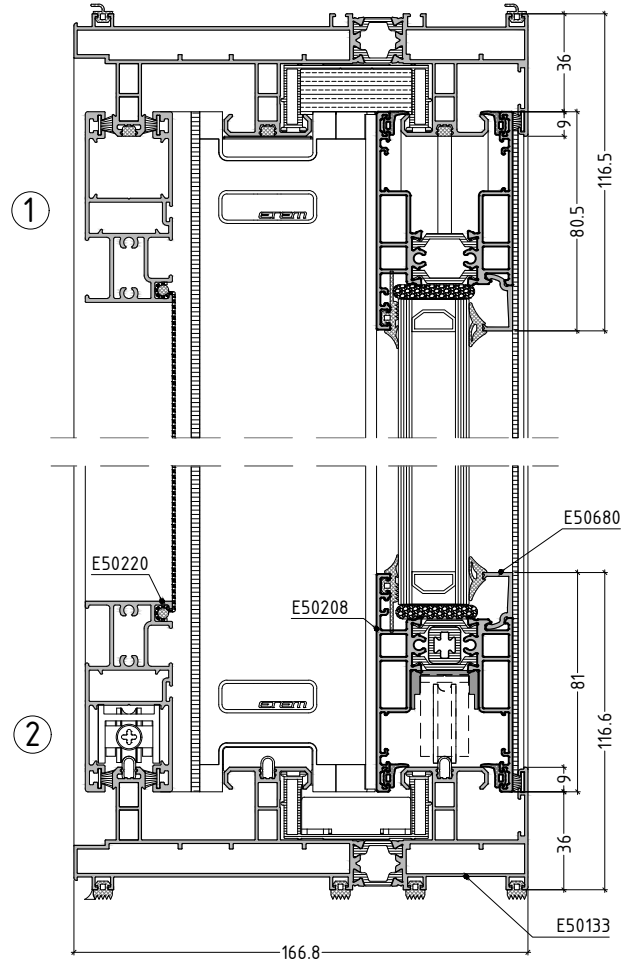
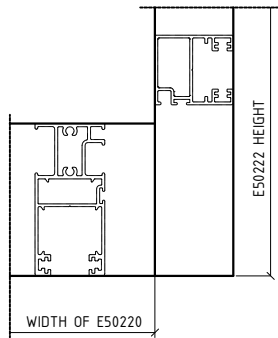
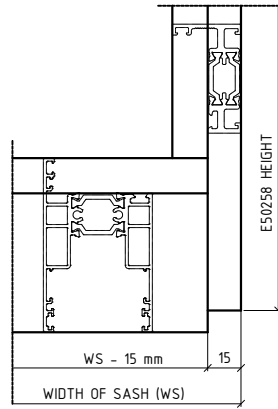

no scale

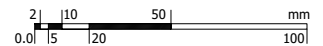

Cutting list 03

DOUBLE LEAF WITH LIFT-SLIDE MECHANISM (INTERLOCK 36mm)

E50 - Flat rail

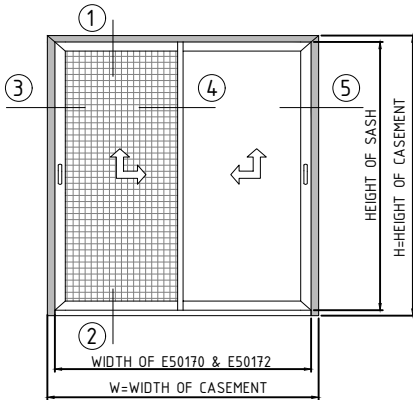

CUTTING LENGTHS

WIDTH OF FRAME E50133	= W
HEIGHT OF FRAME E50133	= H
WIDTH OF FRAMES E50170 & E50172	= W - 40*
WIDTH OF SASH (WS)	= $\frac{W - 44}{2}$
HEIGHT OF SASH	= H - 66
HEIGHT OF E50504-E50258	= H - 86
WIDTH OF SCREEN SASH E50221	= $\frac{(W-108)}{2}$
HEIGHT OF E50221 & E50222	= H - 66

ALL MEASUREMENTS ARE TAKEN FROM THE EXTERNAL SIDE OF THE FRAME

*NOTE: CUTTING LENGTH INCLUDES FLANGE THICKNESS (ET076700.00)

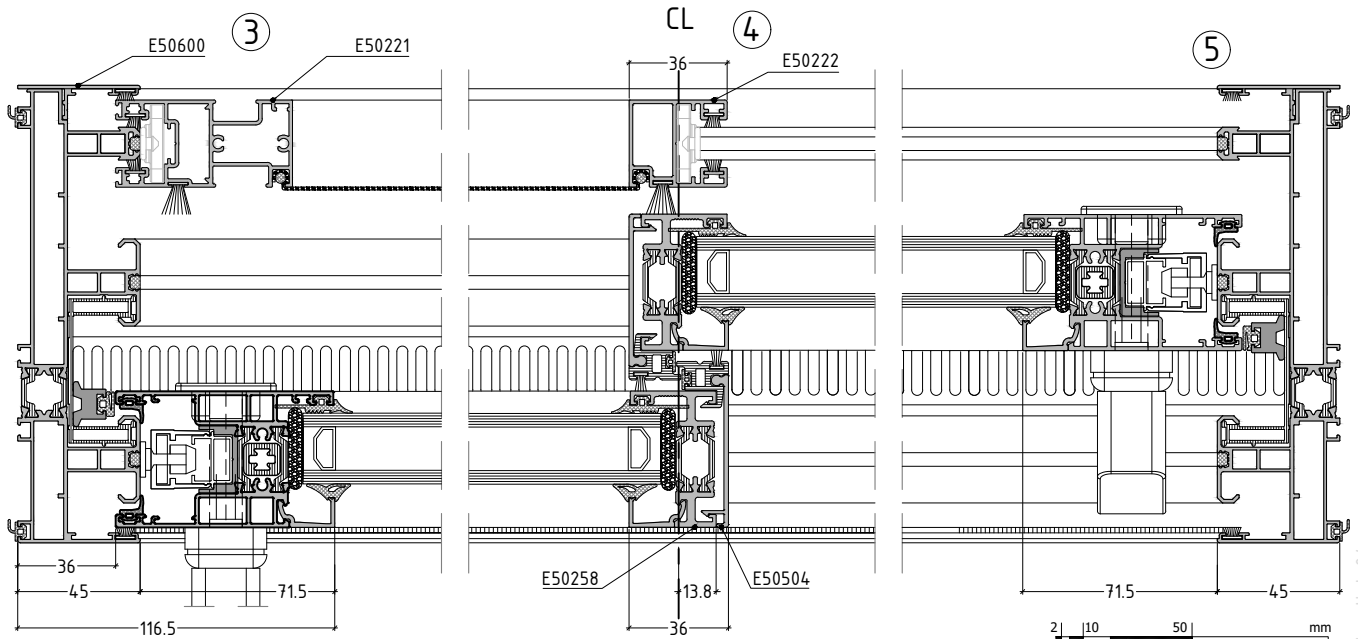
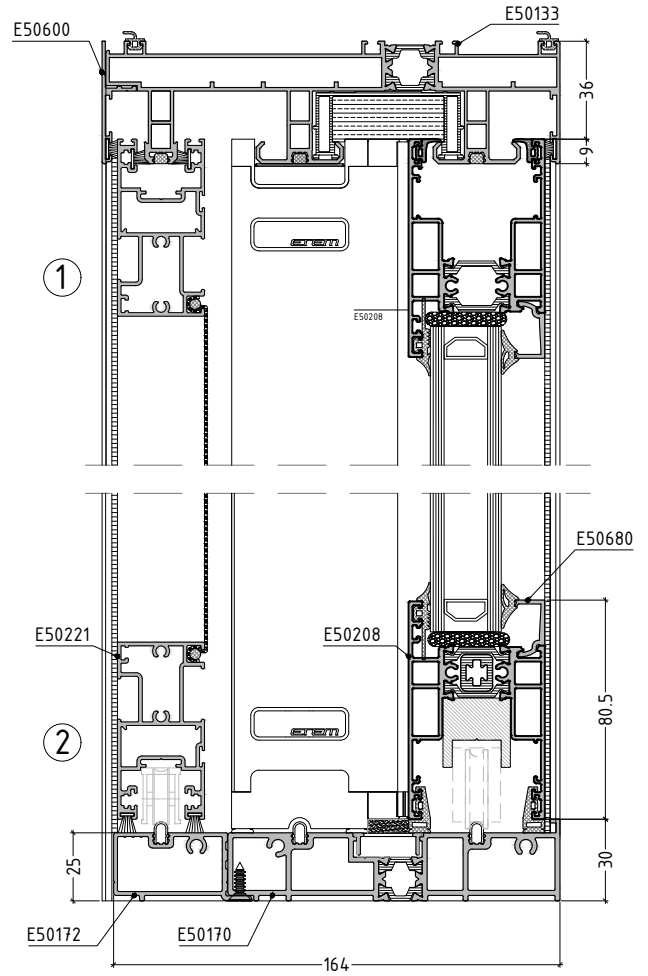
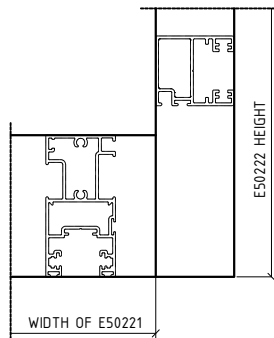
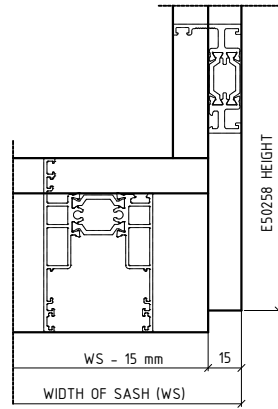

no scale

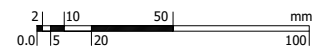

Cutting list 04

QUADRUPLE LEAF LIFT-SLIDE MECHANISM (CLASSIC INTERLOCK) - SASH E50208

E50 - Flat rail

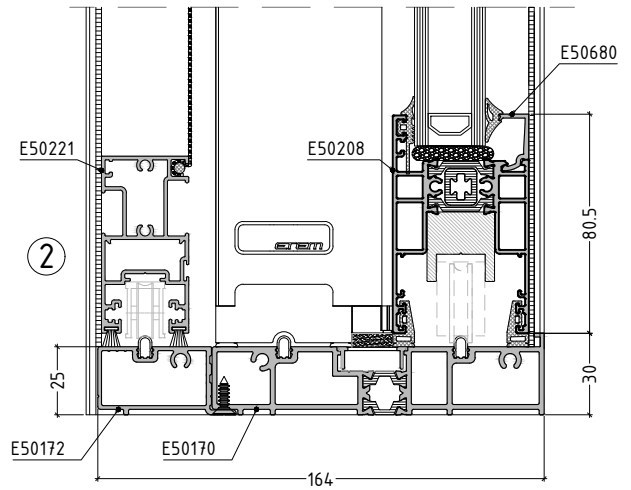
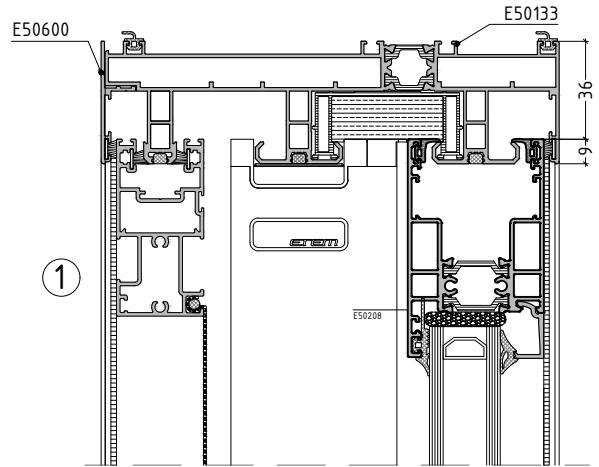
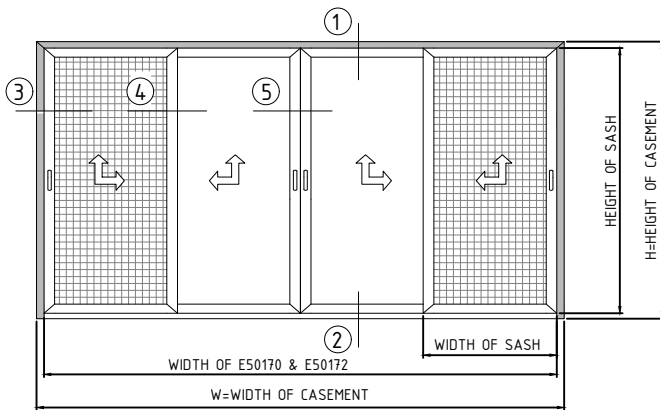

CUTTING LENGTHS	
WIDTH OF FRAME E50133	= W
HEIGHT OF FRAME E50133	= H
WIDTH OF FRAMES E50170 & E50172	= W - 40*
WIDTH OF SASH E50208	= $\frac{W + 66}{4}$
HEIGHT OF SASH E50208	= H - 66
HEIGHT OF SUPL. E50504	= H - 86
HEIGHT OF ADJOIN. E50500	= H - 120

DIMENSION IN MILLIMETERS
ALL MEASUREMENTS ARE TAKEN FROM THE EXTERNAL SIDE OF THE FRAME

* NOTE: CUTTING LENGTH INCLUDES FLANGE THICKNESS (ET076700.00)

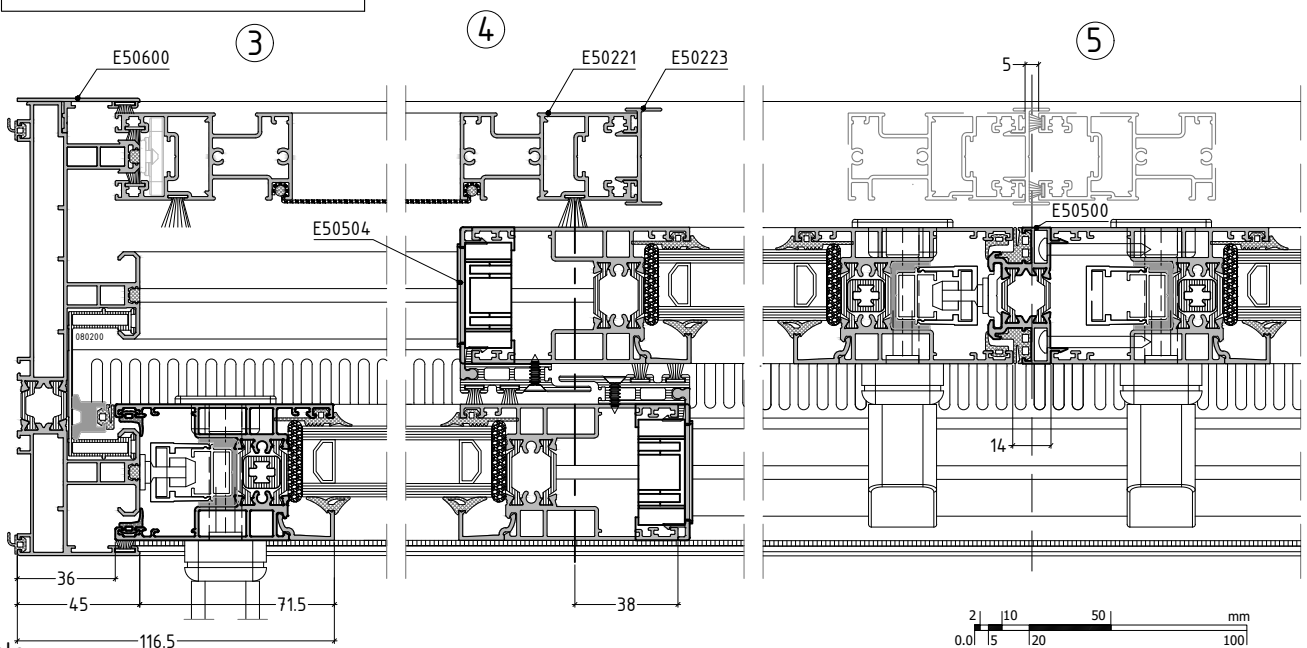
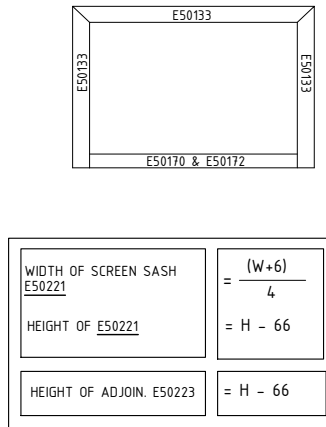

no scale

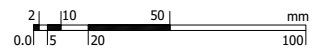

Cutting list 05

DOUBLE LEAF SLIDING WINDOW WITH FLY SCREEN

ES70- Flat rail
Vertical sect.

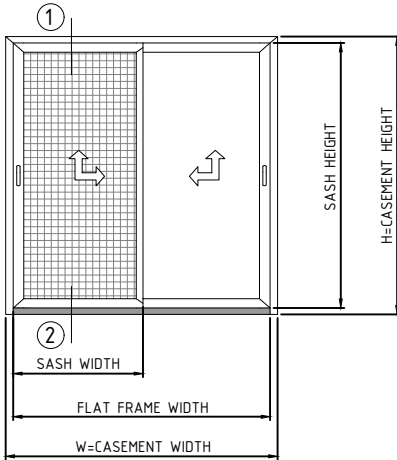

SLIM INTERLOCK

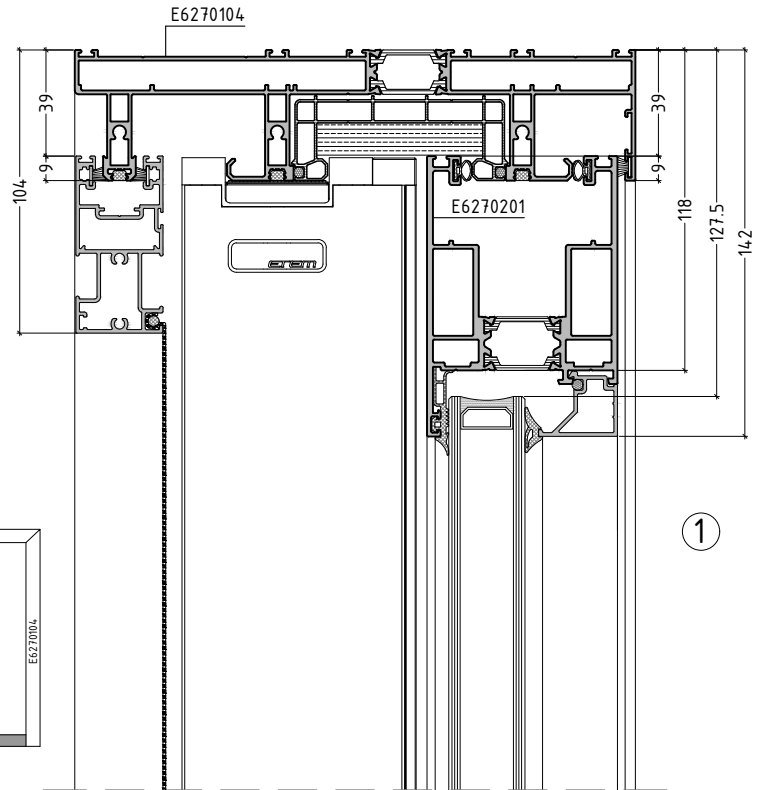

CUTTING LENGTHS

E6270104 FRAME WIDTH	= W
E6270130 & E6270132 FLAT FRAMES WIDTH	= W - 36*
E6270104 FRAME HEIGHT	= H
SASH WIDTH (WS)	= $\frac{(W+74)}{2}$
FINAL SASH WIDTH	= WS - 59
SASH HEIGHT	= H - 69
NARROW SASH HEIGHT (E6270250)	= H - 187
INTERLOCKING HEIGHT	= H - 89
WIDTH OF SCREEN SASH E50221	= $\frac{(W-132)}{2}$
HEIGHT OF E50221 & E50222	= H - 69

DIMENSION IN MILLIMETERS

*NOTE: CUTTING LENGTH INCLUDES FLANGE THICKNESS (ET076701.00)

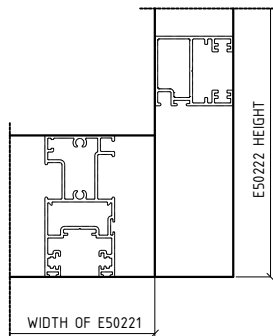
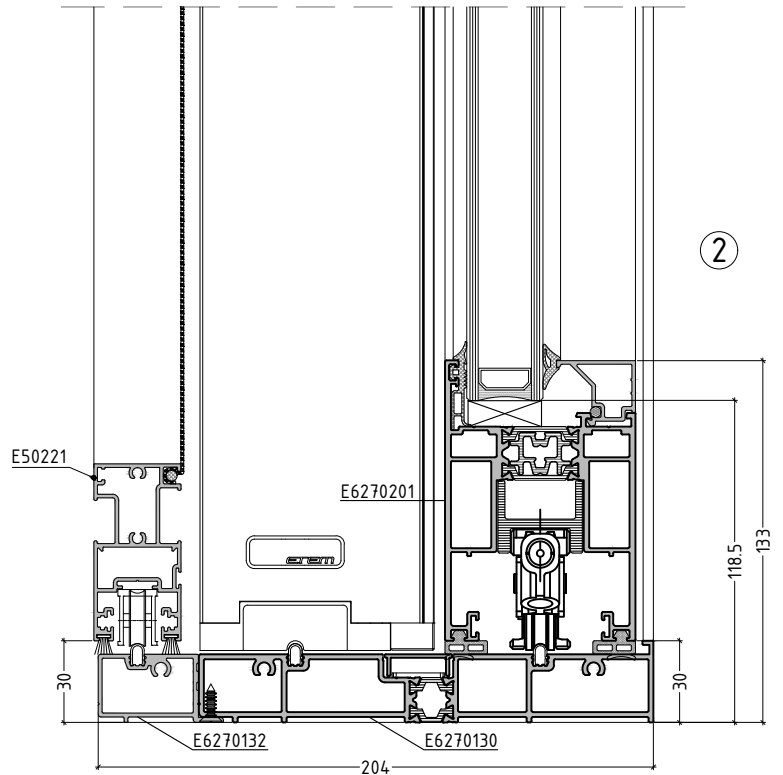
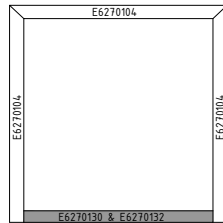

no scale

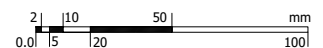

Cutting list 06

DOUBLE LEAF SLIDING WINDOW WITH FLY SCREEN

ES70- Flat rail
Horizontal sect.

SLIM INTERLOCK

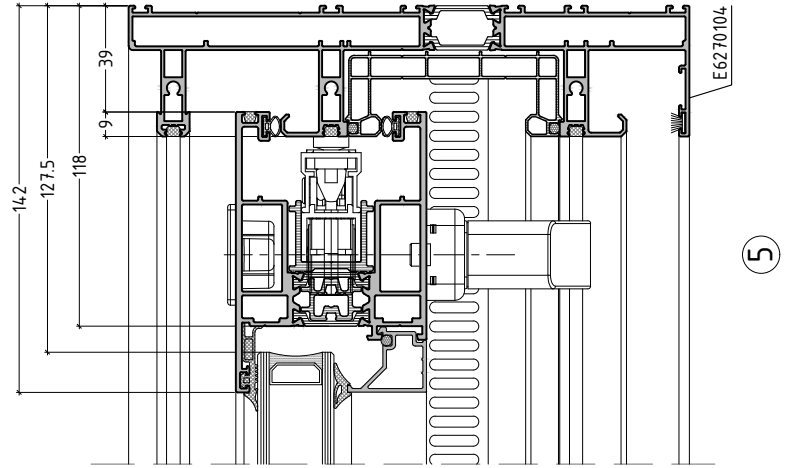
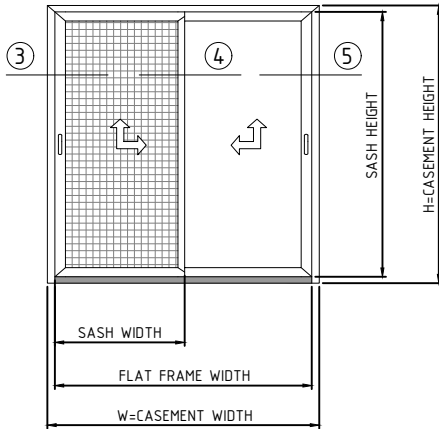

CUTTING LENGTHS

E6270104 FRAME WIDTH	= W
E6270130 & E6270132 FLAT FRAMES WIDTH	= W - 36*
E6270104 FRAME HEIGHT	= H
SASH WIDTH (WS)	= $\frac{(W+74)}{2}$
FINAL SASH WIDTH	= WS - 59
SASH HEIGHT	= H - 69
NARROW SASH HEIGHT (E6270250)	= H - 187
INTERLOCKING HEIGHT	= H - 89
WIDTH OF SCREEN SASH E50221	= $\frac{(W-132)}{2}$
HEIGHT OF E50221 & E50222	= H - 69

DIMENSION IN MILLIMETERS

* NOTE: CUTTING LENGTH INCLUDES FLANGE THICKNESS (ET076701.00)

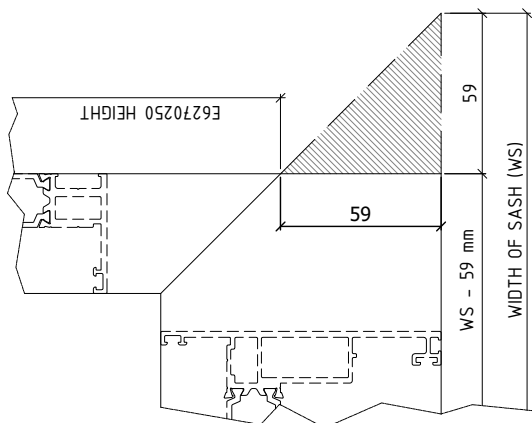
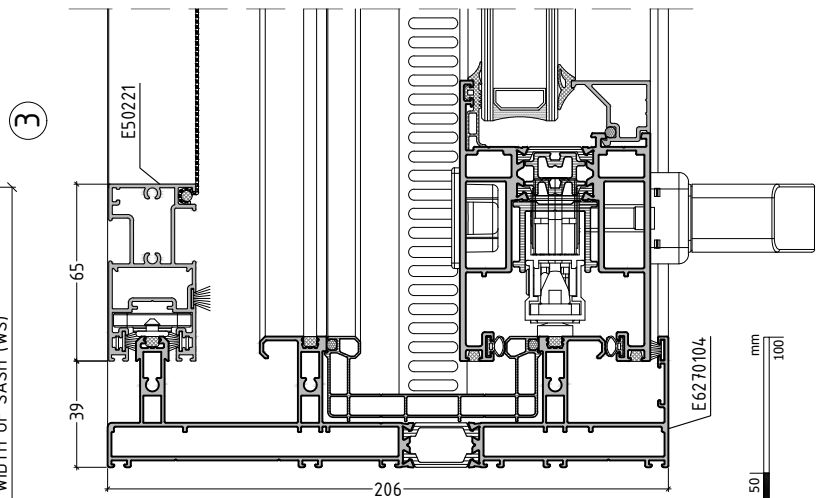
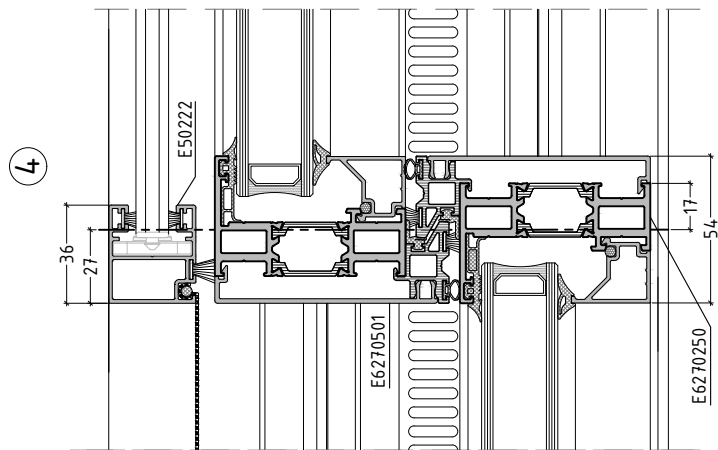

no scale

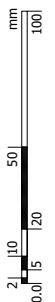

Cutting list 07

DOUBLE LEAF SLIDING WINDOW WITH FLY SCREEN

ES70- Classic rail
Vertical sect.

SLIM INTERLOCK

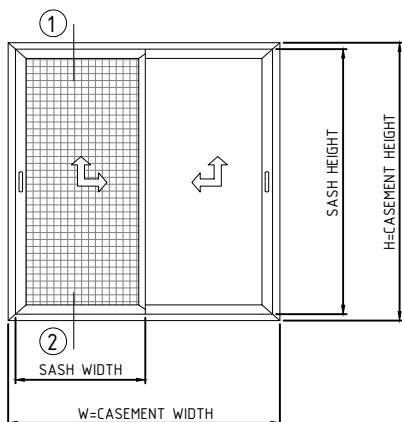

CUTTING LENGTHS

FRAME WIDTH	= W
FRAME HEIGHT	= H
SASH WIDTH (WS)	$= \frac{(W+74)}{2}$
FINAL SASH WIDTH	= WS - 59
SASH HEIGHT	= H - 78
NARROW SASH HEIGHT (E6270250)	= H - 196
INTERLOCKING HEIGHT	= H - 98
WIDTH OF SCREEN SASH E50220	$= \frac{(W-132)}{2}$
HEIGHT OF E50220 & E50222	= H - 78

DIMENSIONS IN MILLIMETERS

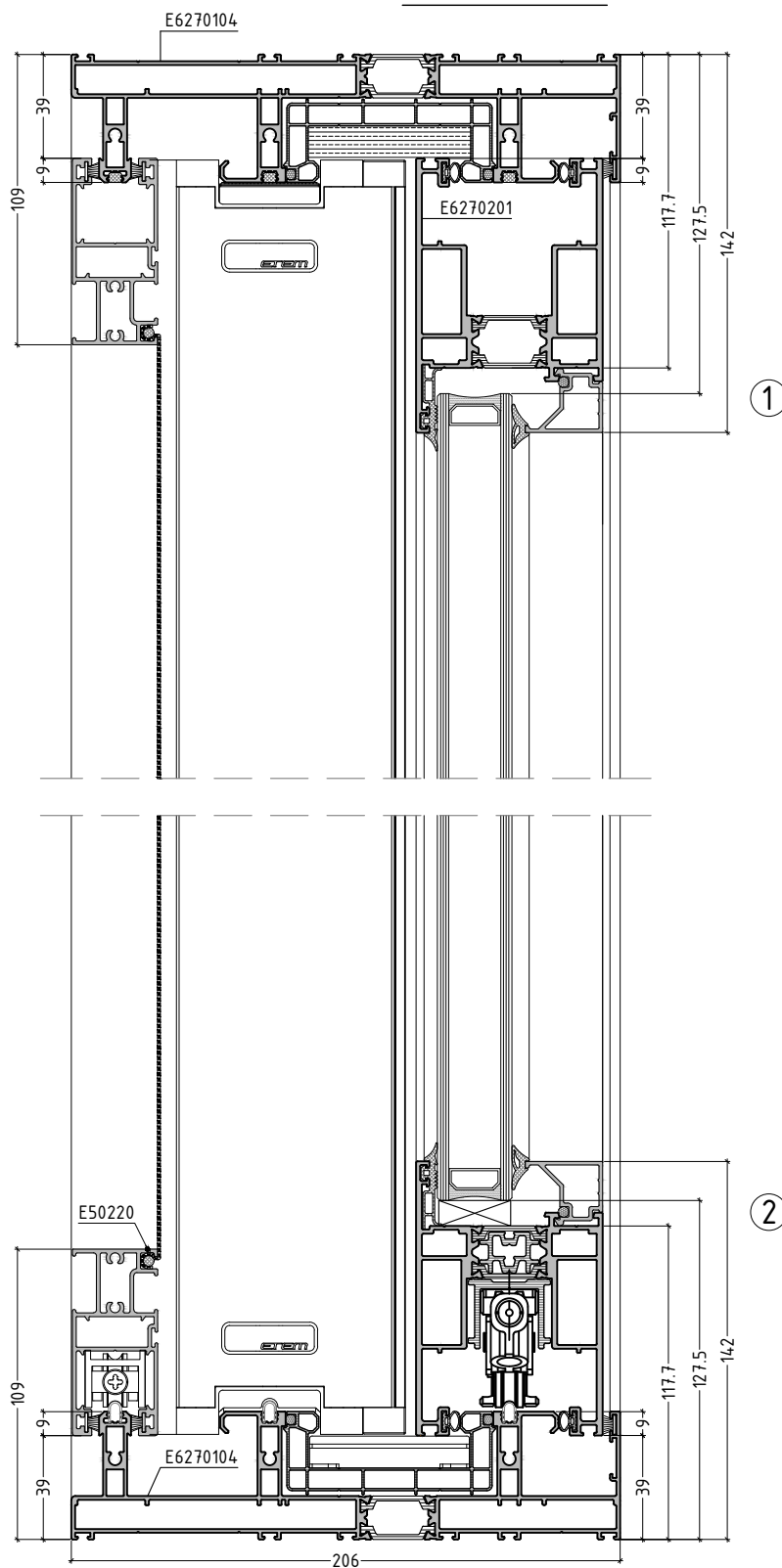
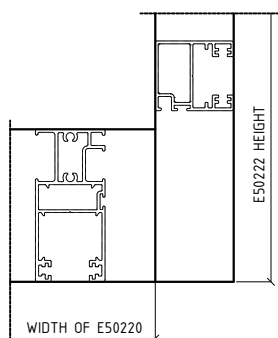

no scale

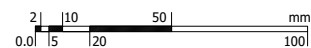

DOUBLE LEAF SLIDING WINDOW WITH FLY SCREEN

ES70- Classic rail
Horizontal sect.

SLIM INTERLOCK

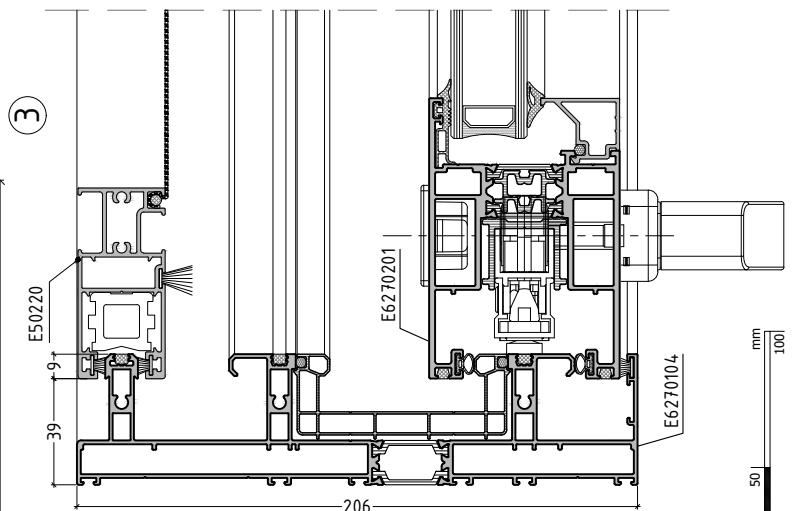
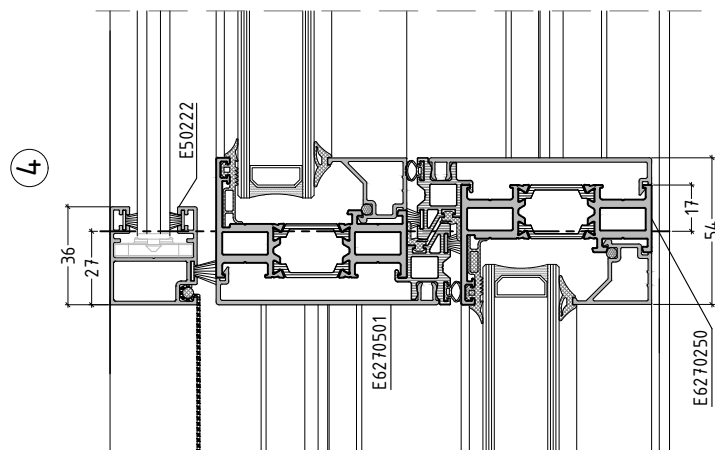
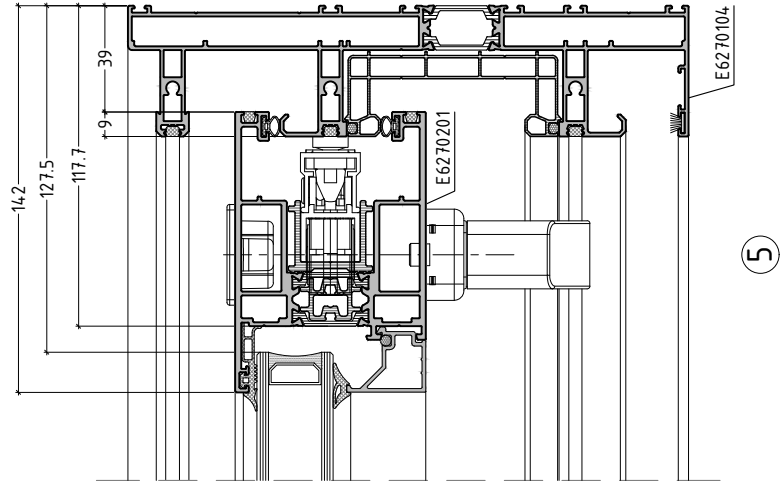
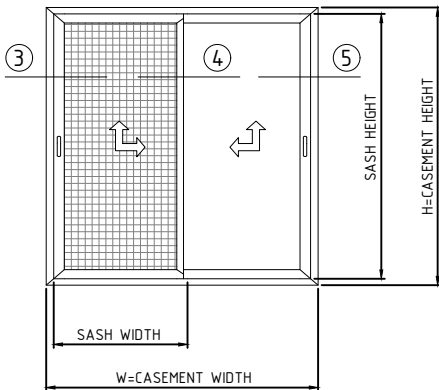

CUTTING LENGTHS

FRAME WIDTH	= W
FRAME HEIGHT	= H
SASH WIDTH (WS)	$= \frac{(W+74)}{2}$
FINAL SASH WIDTH	= WS - 59
SASH HEIGHT	= H - 78
NARROW SASH HEIGHT (E6270250)	= H - 196
INTERLOCKING HEIGHT	= H - 98
WIDTH OF SCREEN SASH E50220	$= \frac{(W-132)}{2}$
HEIGHT OF E50220 & E50222	= H - 78

DIMENSIONS IN MILLIMETERS

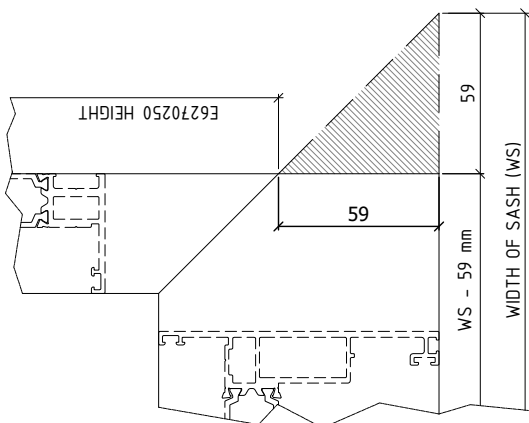

no scale



Cutting list 09

MACHINING ON SLIM FLY SCREEN SASH E50222 & CONNECTION WITH E50220

FOR CLASSIC RAILS

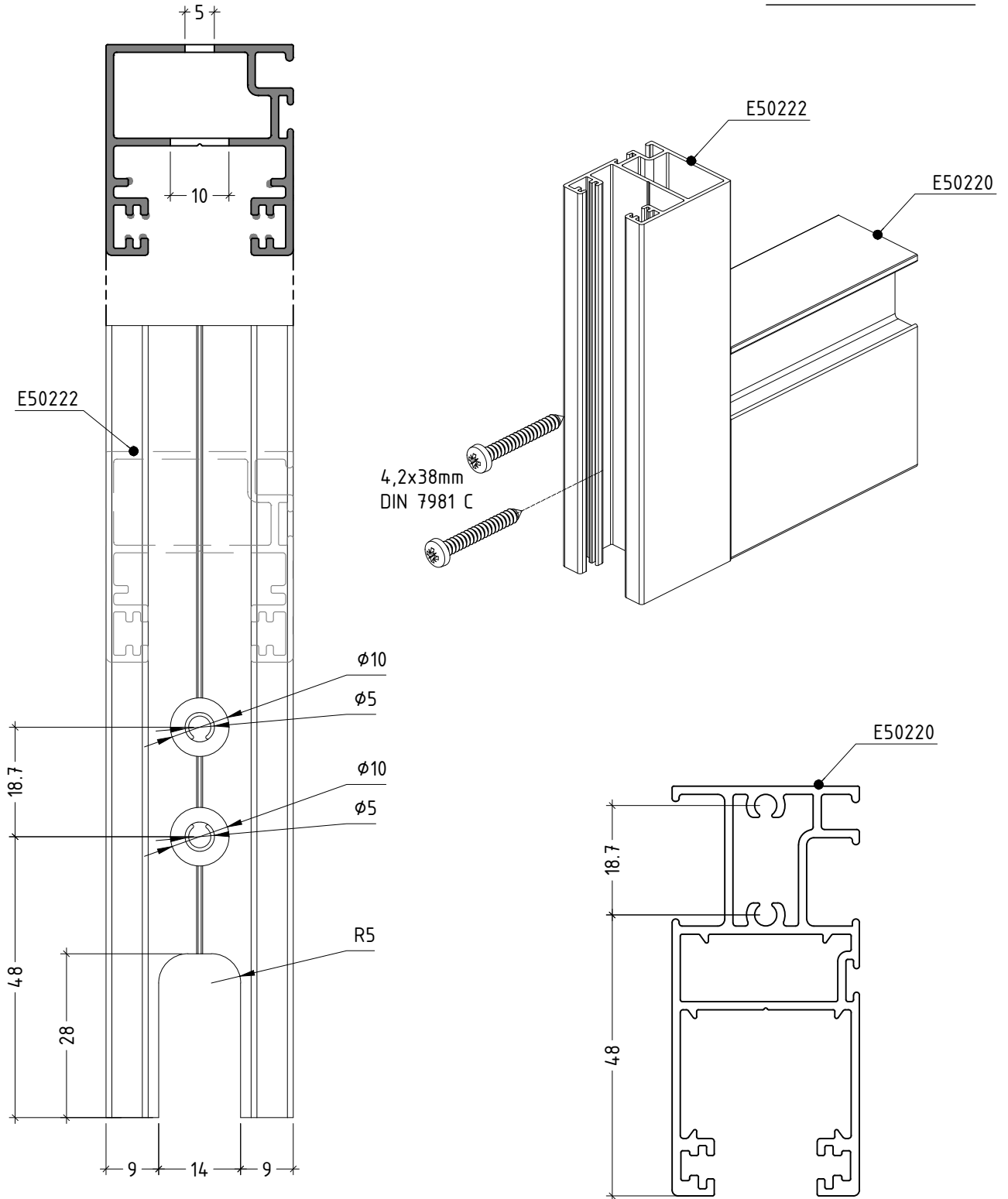

MACHINING ON SLIM FLY SCREEN SASH E50222 & CONNECTION WITH E50221

FOR FLAT RAILS

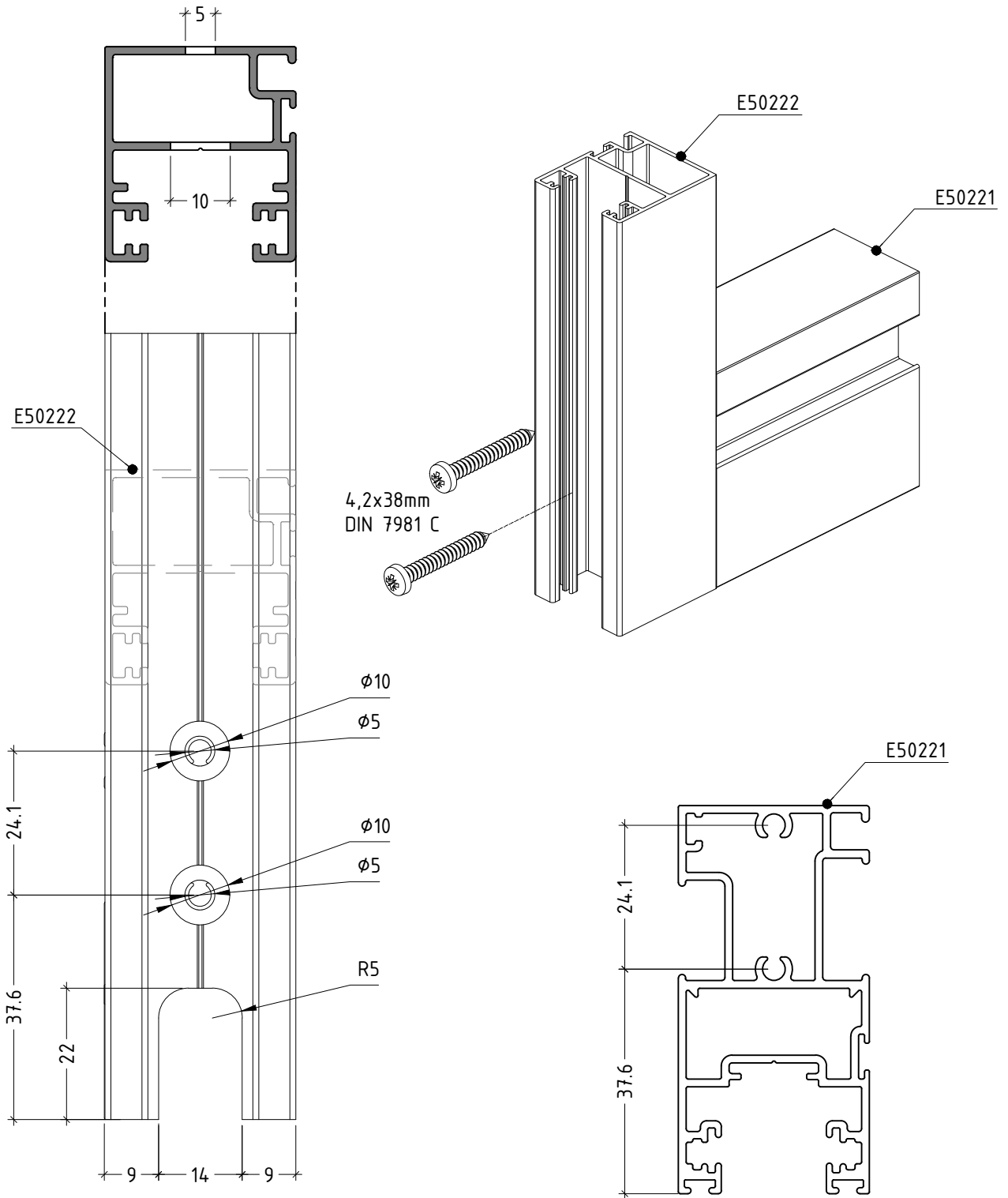

MACHINING ON CENTRAL ADAPTOR E50223

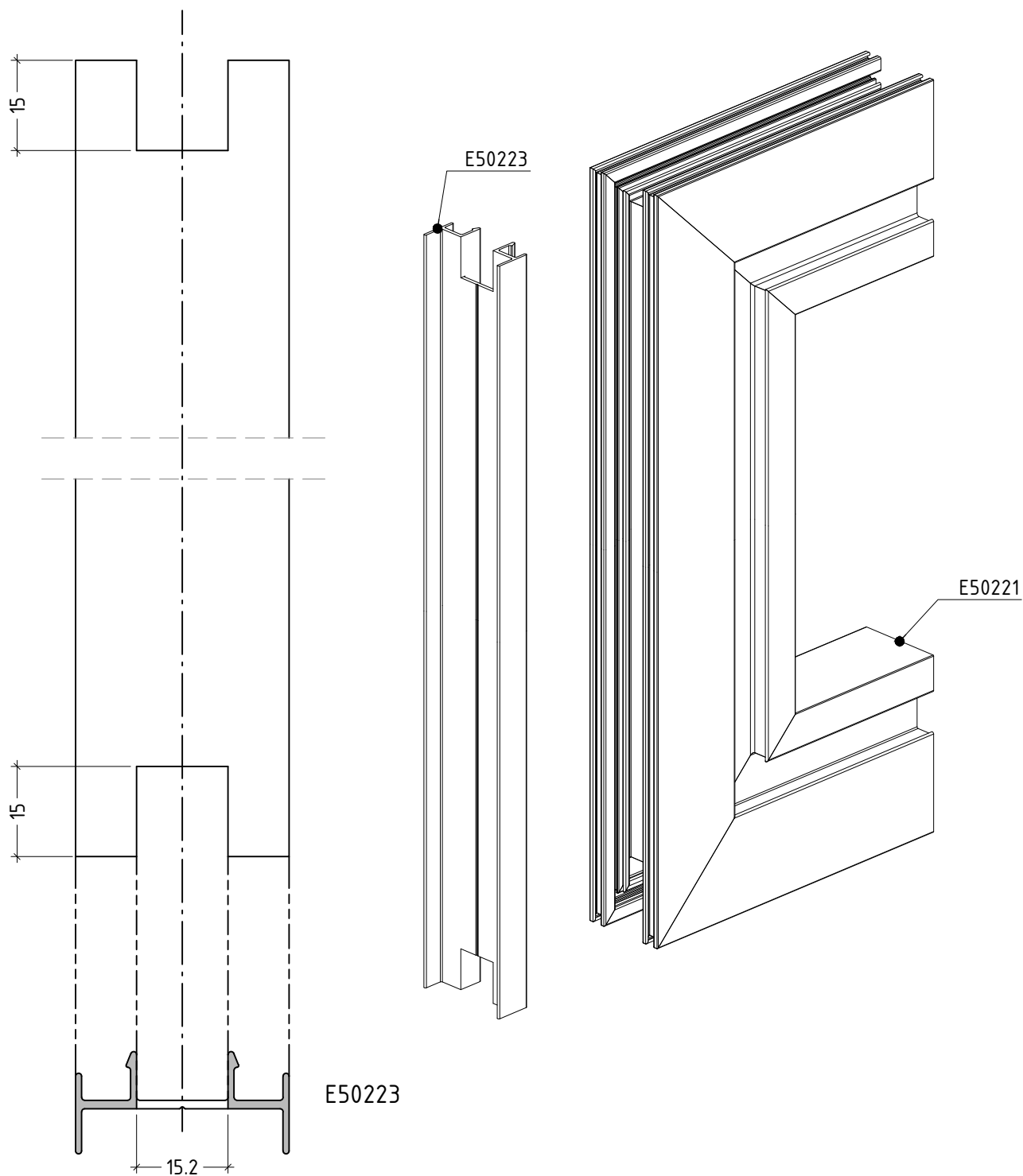

PUNCHING MACHINE FOR SLIM FLY SCREEN SASHES - CODE ET162271.00

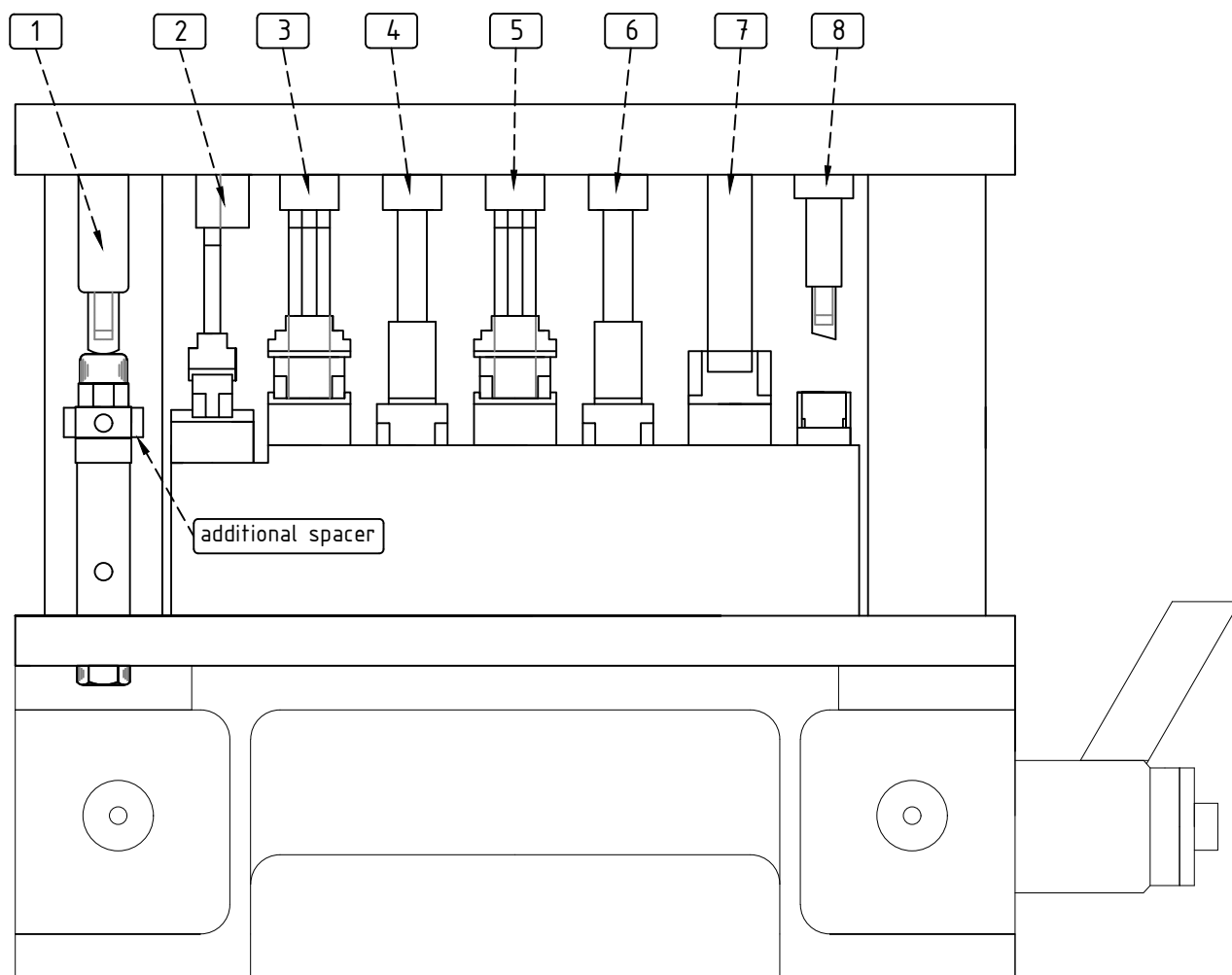

- | | |
|--|---|
| <p>1 Machining on sashes E50220 & E50221 for corner joints. For E50221 use the additional spacer
Κατεργασία φύλλων E50220 & E50221 για γωνίες σύνδεσης. Για το E50221 χρησιμοποιείται η έξτρα προσθήκη.</p> | <p>5 Machining on slim sash E50222 (for connection with E50220)
Κατεργασία στενής σήτας E50222 (για σύνδεση με E50220)</p> |
| <p>2 Machining on slim sash E53221 (for connection with E53220)
Κατεργασία στενής σήτας E53221 (για σύνδεση με E53220)</p> | <p>6 Extra machining $\phi 10$, on slim sash E50222 (for connection with E50220)
Έξτρα κατεργασία $\phi 10$, στενής σήτας E50222 (για σύνδεση με E50220)</p> |
| <p>3 Machining on slim sash E50222 (for connection with E50221)
Κατεργασία στενής σήτας E50222 (για σύνδεση με E50221)</p> | <p>7 Machining on central adaptor E50223
Κατεργασία μπινί σήτας E50223</p> |
| <p>4 Extra machining $\phi 10$, on slim sash E50222 (for connection with E50221)
Έξτρα κατεργασία $\phi 10$, στενής σήτας E50222 (για σύνδεση με E50221)</p> | <p>8 Machining on sash E53220 for corner joint.
Κατεργασία φύλλου E53220 για γωνία σύνδεσης.</p> |

slim fly screen sash 36mm

E50 - ES70

code/description	package/pcs	colour
ET 053306.00		silver

Die cast aluminium corner joint bracket

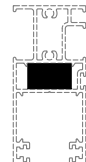
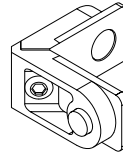

E50220

ET 053316.00		silver
--------------	--	--------

Die cast aluminium corner joint bracket

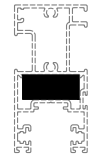
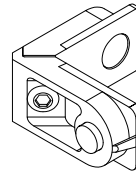

E50221

ET 055507.00		galv.steel
ET 056604.00		inox

Alignment square



E50220

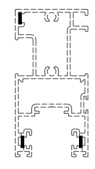

E50221

ET 135588.02		●
--------------	--	---

Pile weatherseal with base
4.8mm, 4P 8mm
for fly screen sash

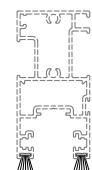
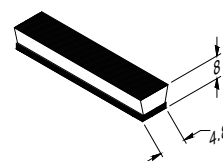

E50221

slim fly screen sash 36mm

E50 - ES70

code/description	package/pcs	colour
ET 240427.00		silver

Single roller for fly screen sash
("U" rail)

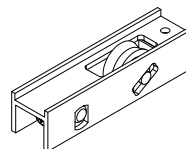

E50220

ET 240428.00		silver
--------------	--	--------

Adjustable roller for fly
screen sash

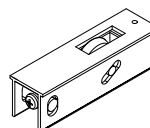

E50221

ET 074831.00		●
--------------	--	---

Stopper for fly
screen sashes

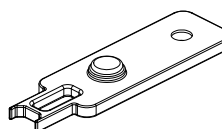

soft stop 2.0mm



E50222

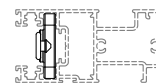

E50221

ET 074642.00		●
--------------	--	---

EPDM stopper for fly
screen sash

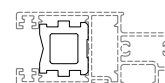
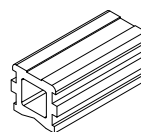

E50220